

CLAIM OF BENEFICIAL USE (REVISED)

IN THE NAME OF DIAMOND LAKE IMPROVEMENT COMPANY

APPLICATION S-68001

PERMIT S-49425

TOWNSHIP 27 SOUTH RANGE 6 EAST, W.M., DOUGLAS COUNTY OREGON

DETAIL OF DOMESTIC USE & FIRE SYSTEM - SECTION 32

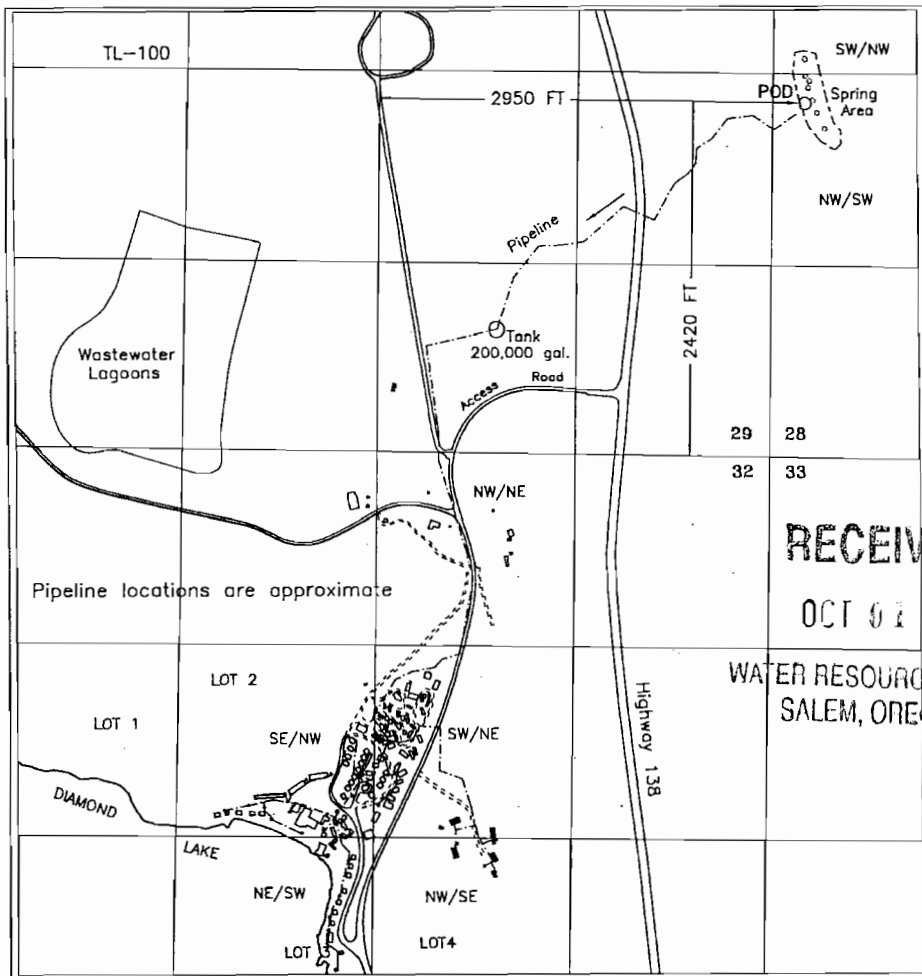

Point of Diversion (POD) 2420 feet north & 2950 feet east of NW corner of NW 1/4 NE 1/4 Section 32

Scale
1 inch = 1320 feet

Base map derived from 2005 FSA aerial photos and 7/27/2007 ortho-photos, tax lot maps, permit application map and 1997 COBU map

For purpose of locating POD, Cardinal directions are in reference from point of beginning (NW COR NW/NE Section 32) extending along it's boundary lines

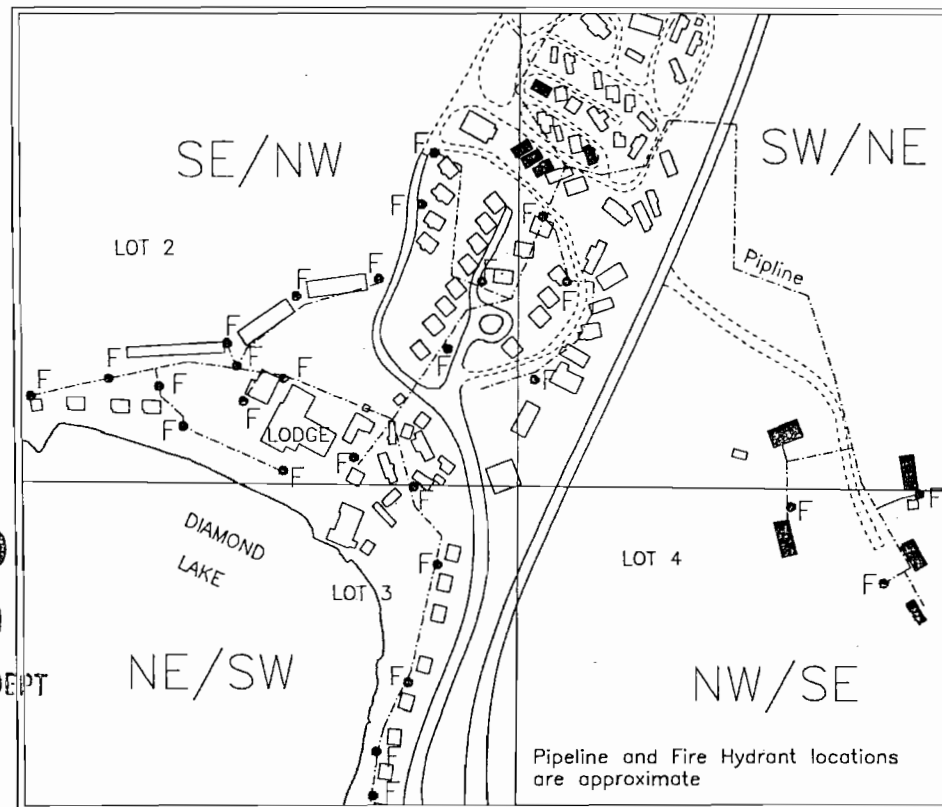

Scale
1 inch = 400 feet

■ HOUSING UNITS (10) ● F FIRE HYDRANTS
□ MISC. BUILDINGS (CERT 8458 & C-38428)

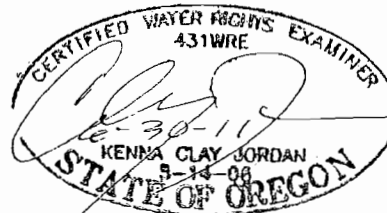

This map is not intended to provide legal dimensions or locations of property ownership lines

JORDAN ENGINEERING
460 JORDAN LANE
ROSEBURG, OR 97471
(541) 673-1931

9/11/2009 n.e.d.