

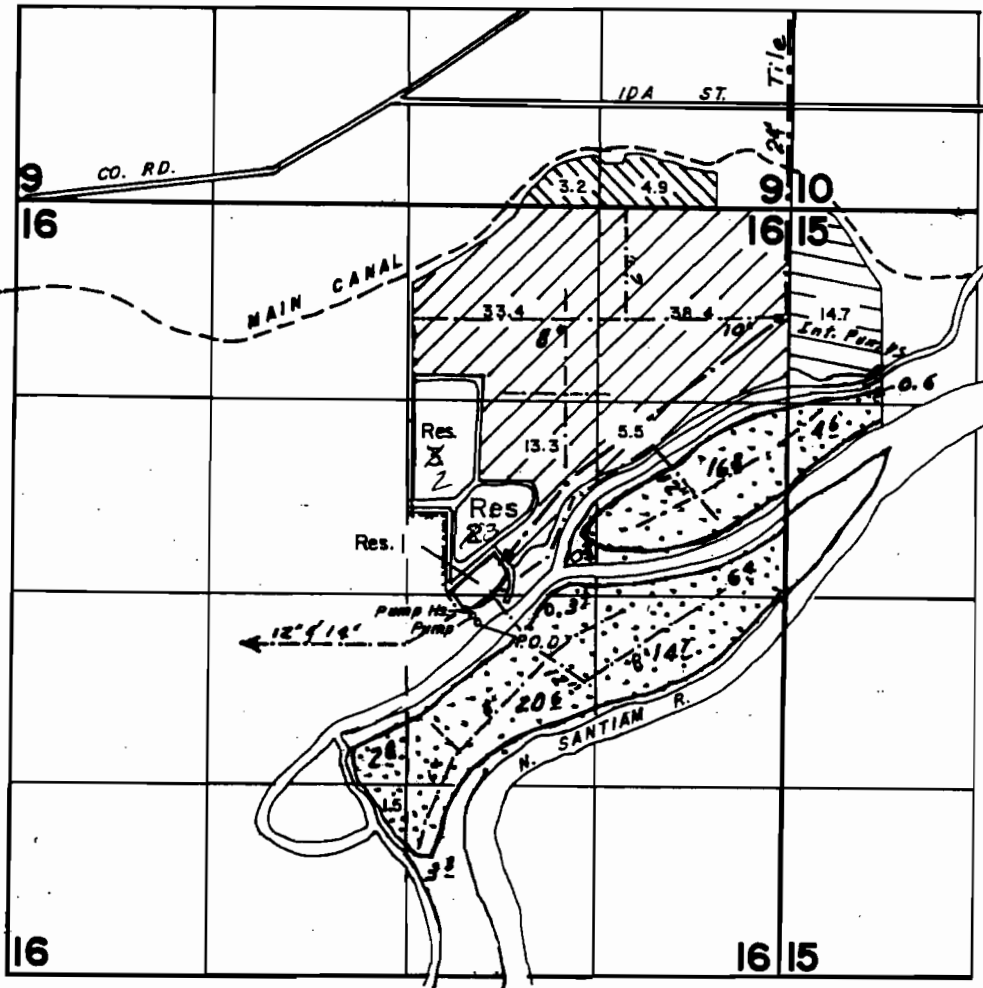





4" = 1 MI.

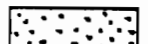

P.O.D.: RESERVOIR - 120' S. & 420' E.; STREAM - 190' S. & 500' E. FROM CENTER OF SEC. 16.

-  PRIMARY FROM N.SANTIAM R., RES. NO. 1, 2 & 3, & SUPPLEMENTAL FROM EFFLUENT
-  SUPPLEMENTAL FROM RES. NO. 1, 2, 3 & EFFLUENT
-  SUPPLEMENTAL FROM EFFLUENT & RES. NO. 2 & 3
-  PRIMARY FROM N.SANTIAM R., SUPPL. FROM EFFLUENT

T. 9 S., R. 1 W., W. M.

RECEIVED

JUL 22 1998

WATER RESOURCES DEPT.
SALEM, OREGON

**FINAL PROOF SURVEY
UNDER**

R-74827 R-12083

Application No. 7.4.8.2.6 Permit No. .5.2.9.3.8.
IN NAME OF

N.O.R.P.A.C..F.O.O.D.S., I.N.C.....

Surveyed JULY.2 19.9.8, by ...

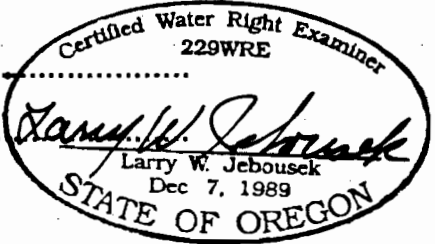

THIS MAP WAS PREPARED FOR THE PURPOSE OF IDENTIFYING THE LOCATION OF A WATER RIGHT ONLY AND IS NOT INTENDED TO PROVIDE LEGAL DIMENSIONS OR LOCATION OF PROPERTY OWNERSHIP LINES.