

T.9S.,R.1W.,SEC.16

T.9S.,R.1W.,W.M.

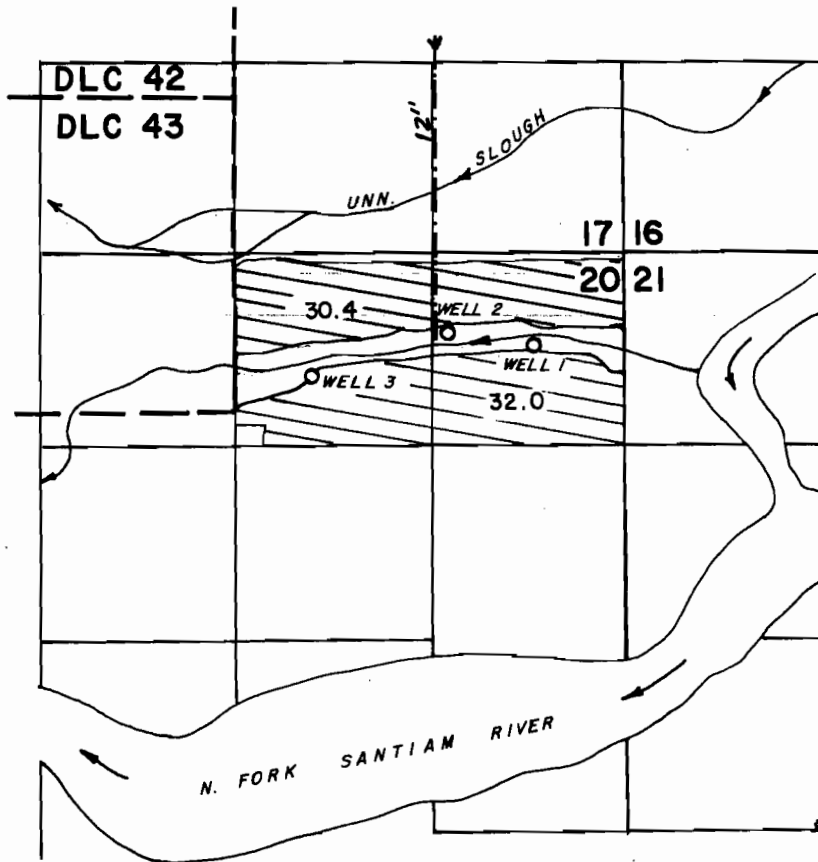

C1/4 COR.
SEC. 16

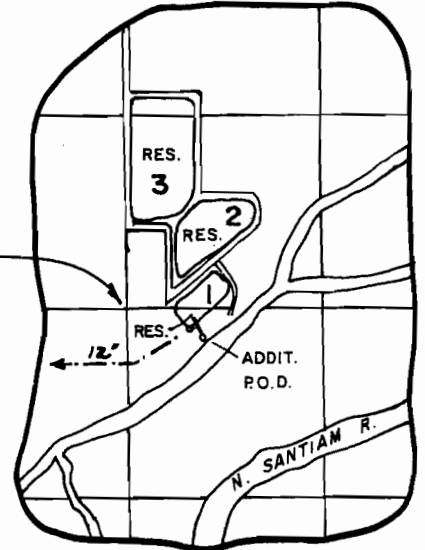

P.O.D. : RESERVOIR - 120' S. & 420' E.
ADDIT. P.O.D. IS LOCATED 190' S.
& 500' E. FROM C1/4 COR., SEC. 16



4" = 1 MI.

WELLS NO. 1, 2 & 3 LOCATED FROM NE. COR. SEC. 20

NO. 1 IS 650' S. & 650' W.

NO. 2 IS 560' S. & 1270' W.

NO. 3 IS 850' S. & 2140' W.

FINAL PROOF SURVEY UNDER

RECEIVED

JUL 22 1998

WATER RESOURCES DEPT.
SALEM, OREGON

T-7244

Application No. 74828 Permit No. 52939..

IN NAME OF

NORPAC FOODS, INC.

Surveyed JULY.2 1998., by

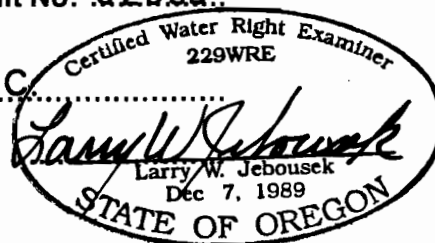

THIS MAP WAS PREPARED FOR THE
PURPOSE OF IDENTIFYING THE LOCA-
TION OF A WATER RIGHT ONLY AND IS
NOT INTENDED TO PROVIDE LEGAL
DIMENSIONS OR LOCATION OF PROPER-
TY OWNERSHIP LINES.