

WATER RIGHT FINAL PROOF MAP
T27S, R6W.WM
DOUGLAS COUNTY
SCALE 1" = 400'

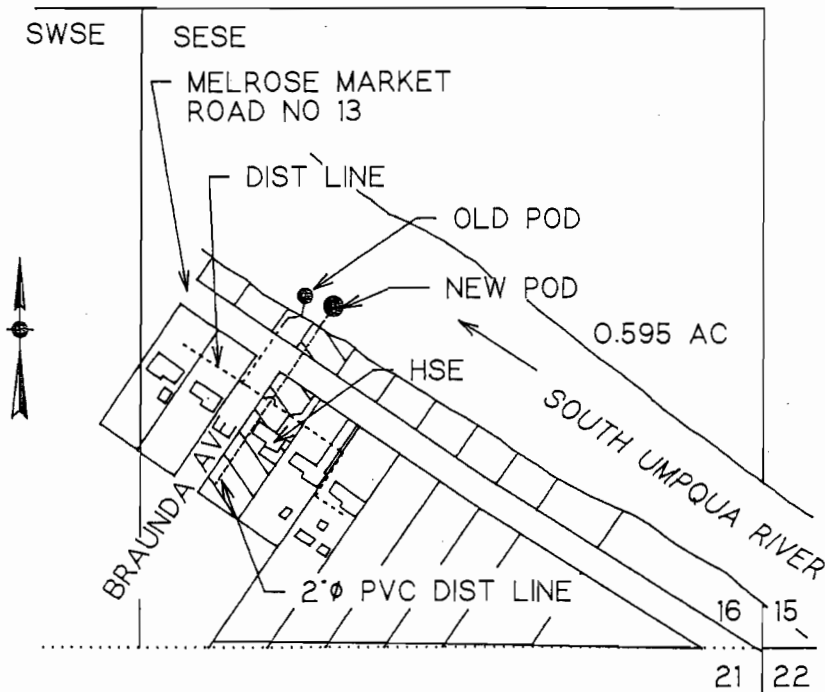

POD IS 700 FT N AND 900 FT W FROM SE COR SEC 16

LOYAL & ESTHER MOHR
4296 OLD MELROSE ROAD
ROSEBURG, OR 97470

FINAL PROOF SURVEY

UNDER

Application No. T-7443 Certificate No. 72179

IN NAME OF

LOYAL OR ESTHER MOHR

Surveyed June 11, 1996, by M E Farr

1960 SW BURDETTE DR. ROSEBURG, OR 97470

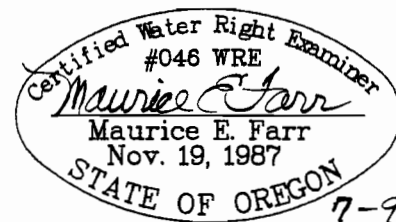

EXPIRES 12-31-97

THIS IS A LOCATION MAP FOR A WATER RIGHT FINAL PROOF BY LOYAL OR ESTHER MOHR. THIS MAP IS FOR THE PURPOSE OF IDENTIFYING THE LOCATION OF THE WATER RIGHT ONLY AND IS NOT INTENDED TO PROVIDE LEGAL DIMENSIONS OR LOCATIONS OF PROPERTY OWNERSHIP LINES.

RECEIVED

JUL 25 1996

WATER RESOURCES DEPT.
SALEM, OREGON