

FINAL PROOF SURVEY MAP
 IN THE NAME OF PAUL OR BETTY MacDONALD
 TRANSFER T-6565
 SECTION 12, TOWNSHIP 29 SOUTH, RANGE 15 WEST, W.M.

PERMIT 16131 CERTIFICATE 20891

RECEIVED

AUG - 5 1987

WATER RESOURCES DEPT.
 SALEM, OREGON

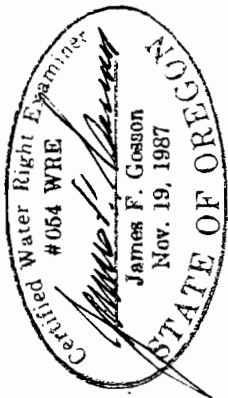
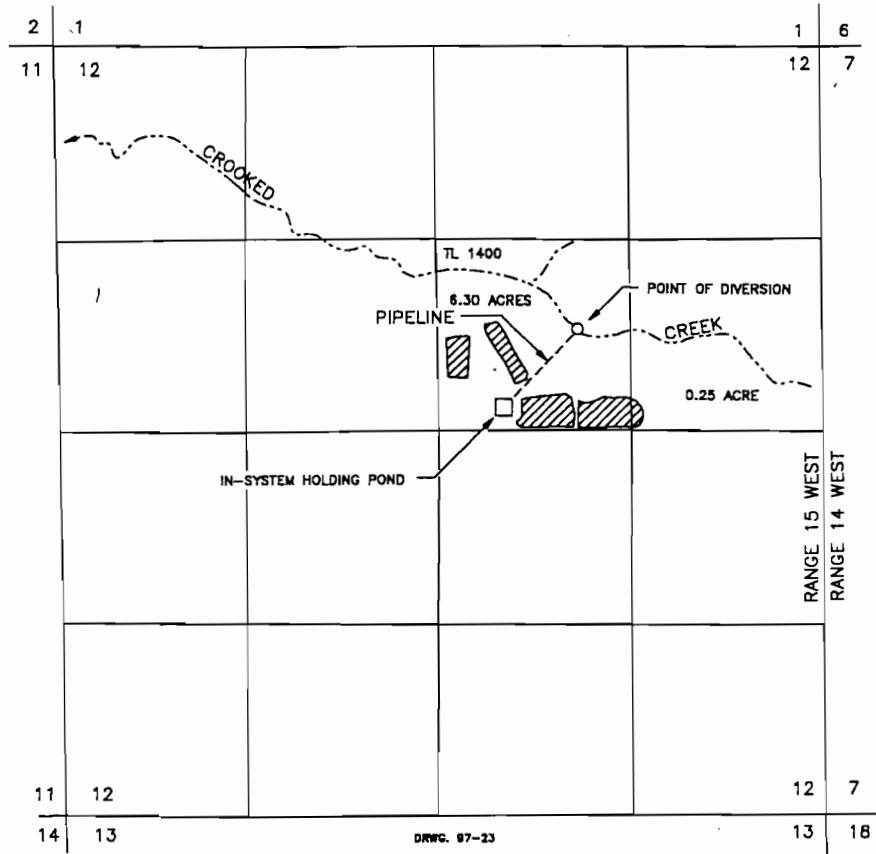

THE POINT OF DIVERSION IS LOCATED 725 FEET NORTH AND 1690 FEET WEST FROM THE EAST 1/4 CORNER OF SECTION 12; BEING WITHIN THE SW1/4 NE1/4 OF SECTION 12, TOWNSHIP 29 SOUTH, RANGE 15 WEST, W.M., COOS COUNTY.

THE PURPOSE OF THIS MAP IS TO IDENTIFY THE LOCATION OF THE WATER RIGHT. IT IS NOT INTENDED TO PROVIDE INFORMATION RELATIVE TO PROPERTY OWNERSHIP BOUNDARY LINES.