

Claim of Beneficial Use - Place of Use Map

Permit No. S31293, Application No. S41805

Townships 40 & 41 South, Ranges 13 & 14 West (W.M.)

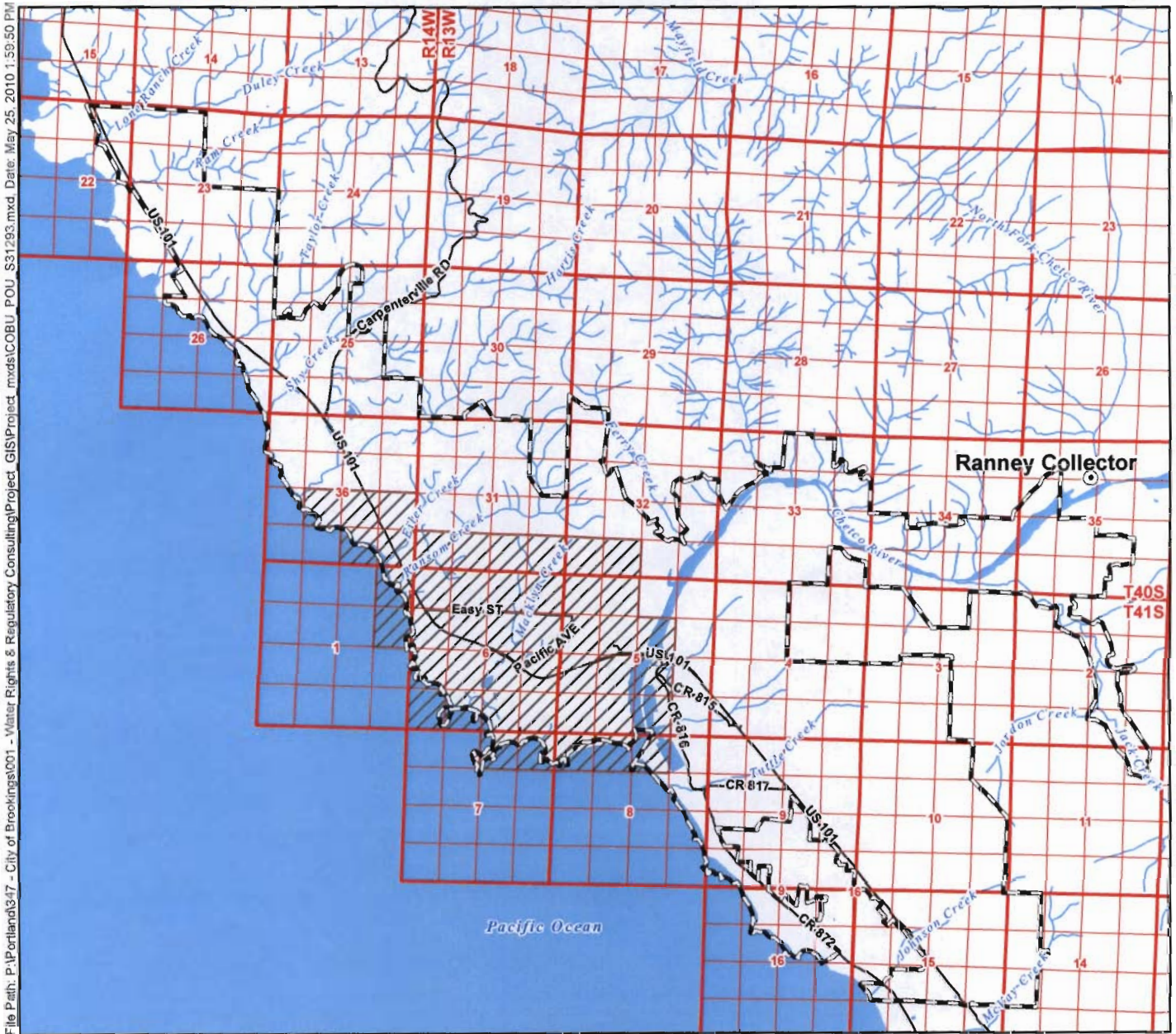

File Path: P:\Portland\347 - City of Brookings\001 - Water Rights & Regulatory Consulting\Project_GIS\Project_mxd\COBU_POU_S31293.mxd, Date: May 25, 2010 1:59:50 PM

Legend

- Point of Diversion (POD)
- ▨ Place of Use (POU)
- ⊕ City Service Area
- Major Roads
- ~ Watercourses
- Waterbodies

Certified Water Rights Examiner Stamp

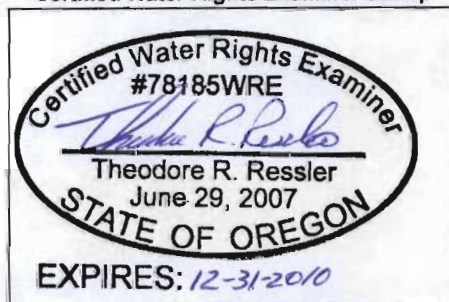

Map Information

Projection: Oregon State Plane South Zone
 Datum: North American Datum of 1983
 Date: May 25, 2010
 Prepared By: GSI Water Solutions, Inc.

Data Sources

OWRD, Oregon Geospatial Data Clearinghouse

Disclaimer

This map was prepared for the purpose of identifying the location of a water right only and it is not intended to provide legal dimensions or location of property ownership lines.

RECEIVED
 JUL 16 2010
 WATER RESOURCES DEPT
 SALEM, OREGON

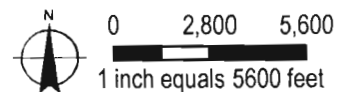

Claim of Beneficial Use - Point of Diversion Map

Permit No. S31293, Application No. S41805
 Township 40 South, Range 13 West (W.M.)

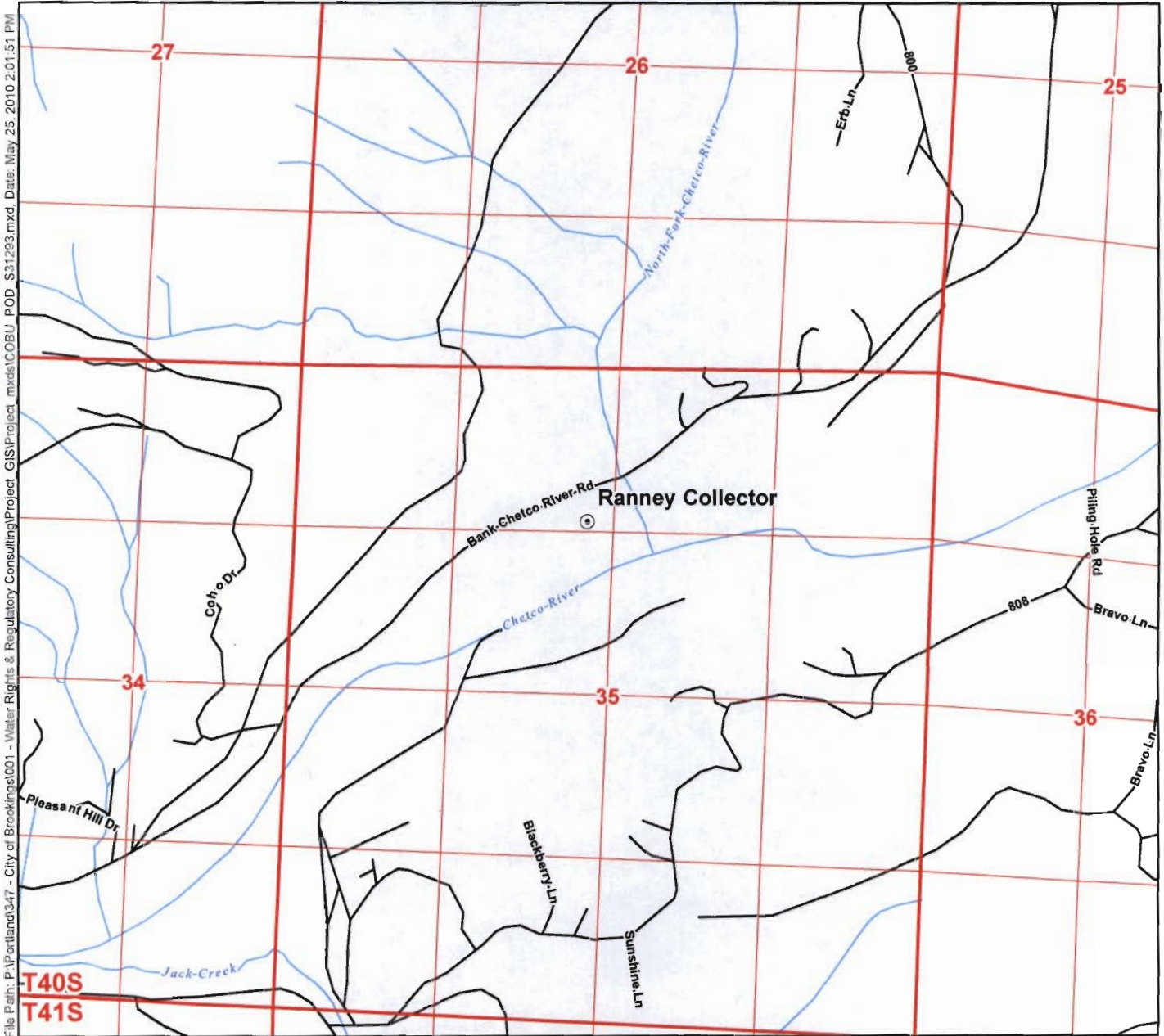

File Path: P:\Portland\347 - City of Brookings\001 - Water Rights & Regulatory Consulting\Project_GIS\Project_mxd\COBU_POD_S31293.mxd, Date: May 25, 2010 2:01:51 PM

Legend

- ⊙ Point of Diversion (POD)
- Streets
- ~ Watercourses

Certified Water Rights Examiner Stamp

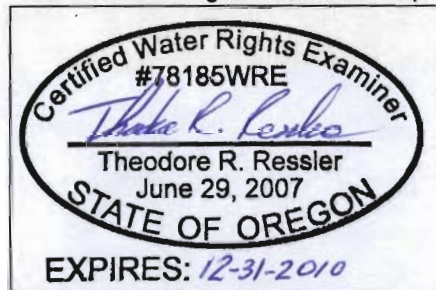

Map Information

Projection: Oregon State Plane South Zone
 Datum: North American Datum of 1983
 Date: May 25, 2010
 Prepared By: GSI Water Solutions, Inc.

Data Sources

OWRD, Oregon Geospatial Data Clearinghouse

Disclaimer

This map was prepared for the purpose of identifying the location of a water right only and it is not intended to provide legal dimensions or location of property ownership lines.

POD Legal Description

Ranney Collector
 Located 1,290 feet South and 2,415 feet East from the NW corner of Section 35, Township 40 South, Range 13 West (W.M.)

RECEIVED

JUL 16 2010

WATER RESOURCES DEPT
 SALEM, OREGON



0 660 1,320
 1 inch equals 1320 feet

