

**APPLICATION MAP FOR TRANSFER
ADDITIONAL POINT OF APPROPRIATION
SITUATED IN THE SE1/4 SE1/4 OF SEC 33, T 40S, R 11E W.M.
AND THE NE1/4 NE1/4 AND THE SE1/4 NE1/4
SEC. 4 T41S, R11E W.M.
KLAMATH COUNTY, OREGON**



RECEIVED

APR 22 2010

WATER RESOURCES DEPT
SALEM, OREGON

CERTIFICATE No.: 86099
PERMIT No.: G-12548
APPLICATION No.: G-13441

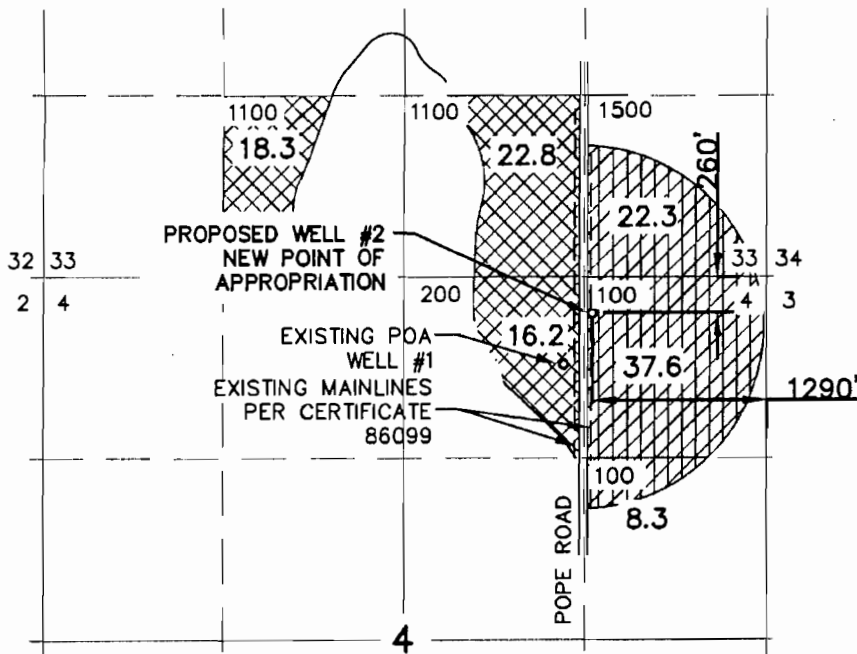
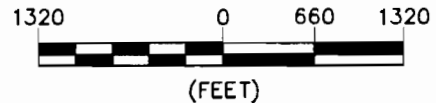

NOTES:

- 1) THIS MAP WAS PREPARED FROM CERTIFICATE 80699, AND COUNTY TAX MAPS.
- 2) THE PURPOSE OF THIS MAP IS TO IDENTIFY THE LOCATION OF THE WATER RIGHT ONLY, AND IS NOT INTENDED TO PROVIDE DIMENSIONS OR LOCATIONS OF PROPERTY LINES.
- 3) EXISTING WELL LOCATION: 650 FEET SOUTH & 1465 FEET WEST FROM NE CORNER, SECTION 4.

- SUPPLEMENTAL IRRIGATION PER CERTIFICATE 86099; PRIORITY DATE 6/22/93.
- LANDS TO CONTINUE TO RECEIVE SUPPLEMENTAL IRRIGATION FROM WELL #1 PER CERTIFICATE 86099; PRIORITY DATE 6/22/93.
- LANDS TO RECEIVE SUPPLEMENTAL IRRIGATION FROM PROPOSED WELL #2; PRIORITY DATE 6/22/93.
- 100 TAX LOT NUMBER
- 8.3 IRRIGATED ACRES PER 1/4 1/4

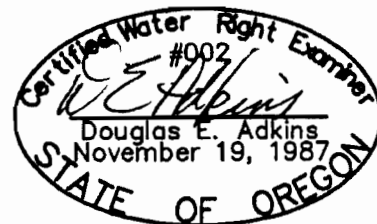

RENEWAL 12/31/11

[Signature]

APPLICANT SIGNATURE

[Signature]

APPLICANT SIGNATURE

ADKINS
SINCE 1983

CONSULTING
ENGINEERS, INC.

Engineers ▲ Planners ▲ Surveyors

2950 Shasta Way · Klamath Falls, Oregon 97603 · (541) 884-4666 · FAX (541) 884-5335
Klamath Falls, OR · Medford, OR · Alturas, CA

3-30-10

Base WR

2972-01

**ADDITIONAL POINT OF
APPROPRIATION**

IN
T40S, R11E, SECTION 33 W.M.
T41S, R11E, SECTION 4 W.M.
KLAMATH COUNTY, OREGON

T 11065