

# T.5S., R.2W., W.M.

**RECEIVED**

**OCT 13 1997**

WATER RESOURCES DEPT.  
SALEM, OREGON

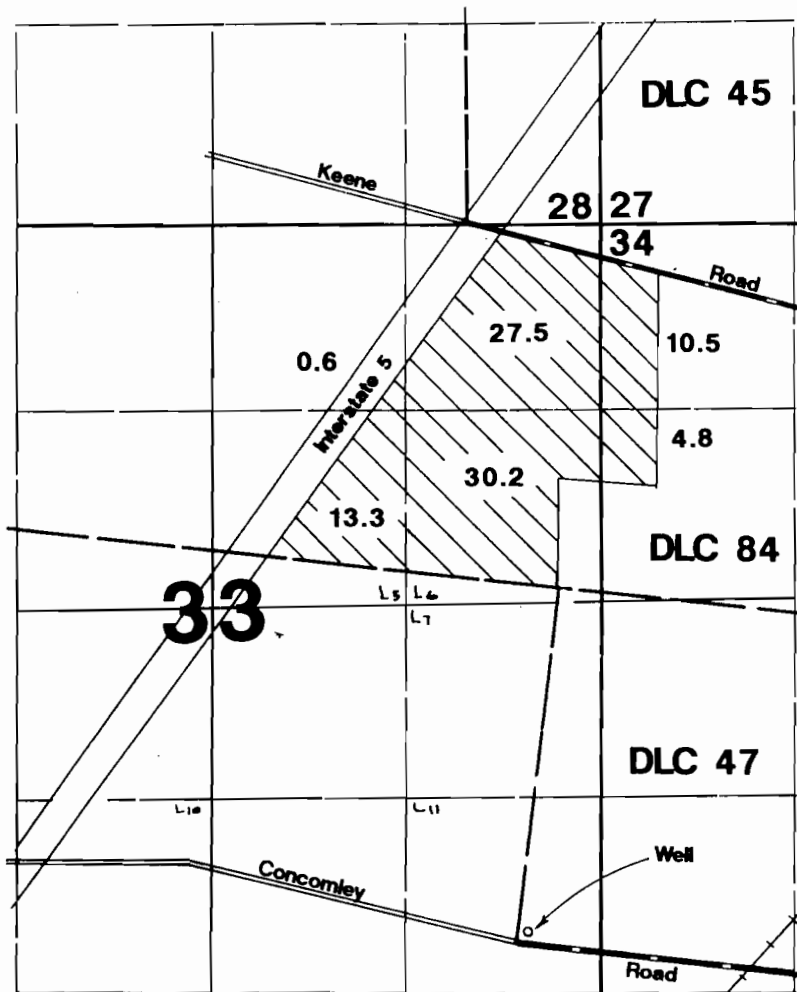

Well located 70'N & 80'E from SW corner DLC 47.

**Final Proof Survey**  
**Transfer #: T-6879**  
In Name Of  
**James Butsch**

Surveyed on September 28, 1997 by JM Schuette

THIS MAP WAS PREPARED FOR THE PURPOSE OF IDENTIFYING THE LOCATION OF A WATER RIGHT ONLY AND IS NOT INTENDED TO PROVIDE LEGAL DIMENSIONS OR LOCATION OF PROPERTY OWNERSHIP LINES.

