

Handwritten text at top right corner.

SEP - 6 1997

WATER DIVISION OF OREGON  
PLANNING SECTION

**FINAL PROOF SURVEY MAP**  
 IN THE NAME OF PAUL R. AND ROSETTA A. KENT  
 SECTION 20, TOWNSHIP 28 SOUTH, RANGE 14 WEST, W.M  
 PERMIT 25032 CERTIFICATE 31941  
 PERMIT 31757 CERTIFICATE 35820  
 PERMIT 34497 CERTIFICATE 40759  
 TRANSFER 6698

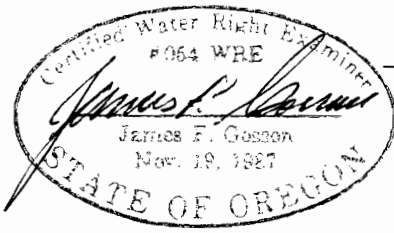
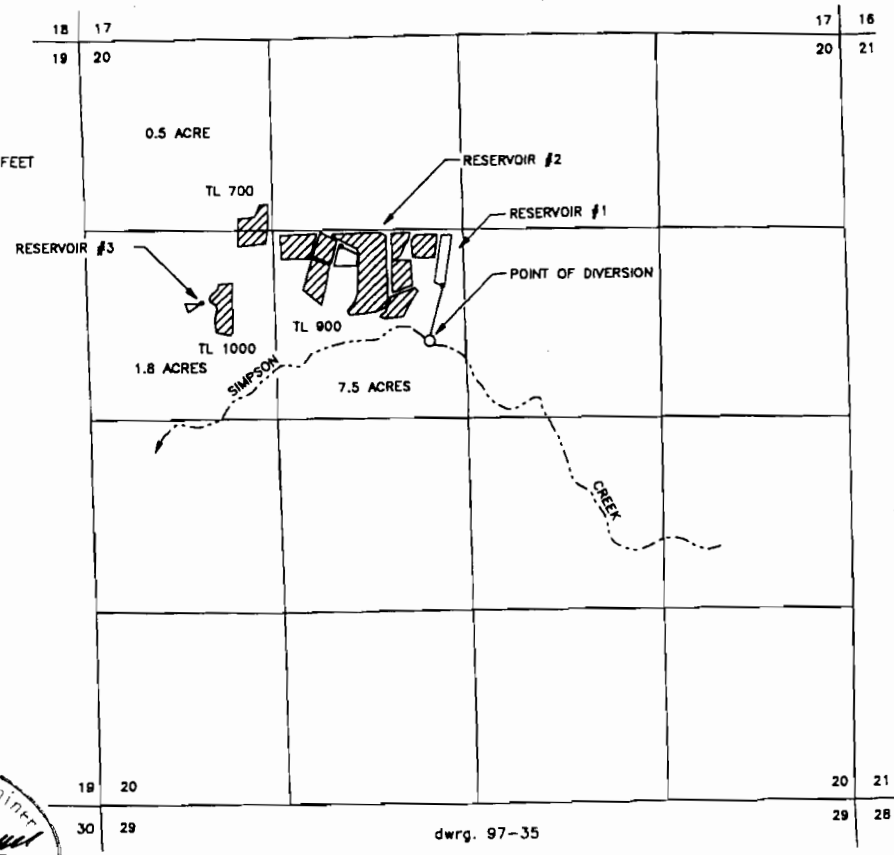

dwrg. 97-35

THE POINTS OF DIVERSION ARE LOCATED 2100 FEET SOUTH AND 250 FEET WEST, BEING WITHIN THE SE1/4 NW1/4; 1730 FEET SOUTH AND 150 FEET WEST, BEING WITHIN THE SE1/4 NW1/4; 1500 FEET SOUTH AND 830 FEET WEST, BEING WITHIN THE SE1/4 NW1/4; 1740 FEET SOUTH AND 1880 FEET WEST, BEING WITHIN THE SW1/4 NW1/4, ALL BEING FROM THE NORTH 1/4 CORNER OF SECTION 20, AND ALL BEING WITHIN SECTION 20, TOWNSHIP 28 SOUTH, RANGE 14 WEST, W.M., DOUGLAS COUNTY.

THE PURPOSE OF THIS MAP IS TO IDENTIFY THE LOCATION OF THE WATER RIGHT. IT IS NOT INTENDED TO PROVIDE INFORMATION RELATIVE TO THE LOCATION OF PROPERTY OWNERSHIP BOUNDARY LINES.