

T.10S. R.2W. W.M.

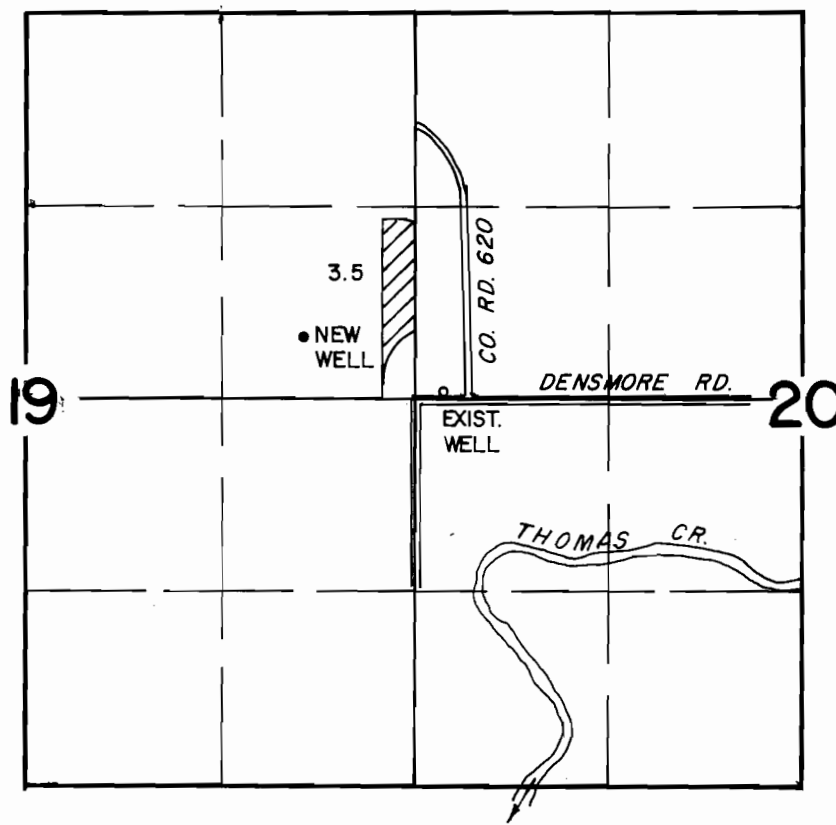

4" = 1 MILE

WAC-ODFW-93  
AUG 19 1997  
WATER RESOURCES DEPT  
SALEM, OREGON



FROM : EXIST. WELL LOC. 30' N. & 200' E.  
FROM W.1/4 COR. SECTION 20.

TO : NEW WELL LOC. 410' N. & 760' W.  
FROM W1/4 COR. SECTION 20.

### FINAL PROOF SURVEY

For Transfer No. T-7321

### MILLER FORESTS, INC.

SURVEYED ON DEC. 29, 1994

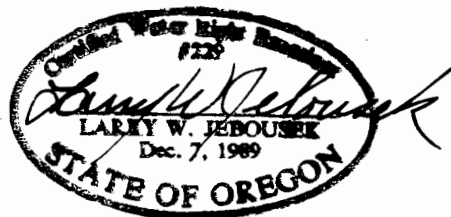

Photo inspection: June 23, 1997 WAC-ODFW-93 6-91 SWJ