

RECEIVED

SEP 15 1997

WATER RESOURCES DEPT.
SALEM, OREGON

FINAL PROOF SURVEY MAP

TRANSFER 7628

TRANSFER 7763

IN THE NAME OF WILLARD J. LEE

SECTIONS 5 AND 8, TOWNSHIP 25 SOUTH, RANGE 5 WEST, W.M.

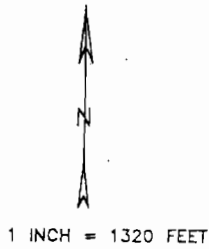

- ▨ T-7628
- ▨ T-7763

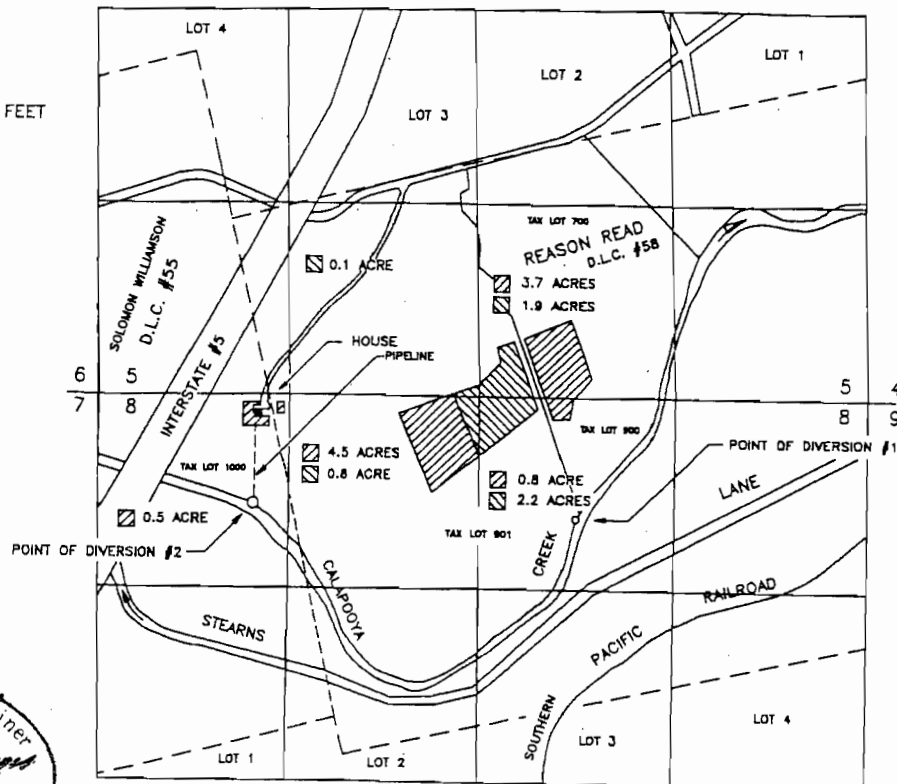



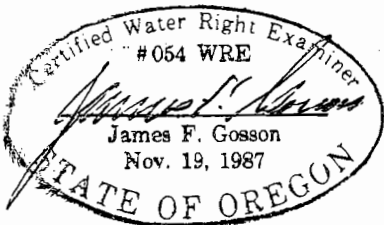





DRWG. 97-37



POINT OF DIVERSION #1 IS LOCATED 840 FEET SOUTH AND 1990 FEET WEST, BEING WITHIN THE NW1/4 OF THE NE1/4 OF SECTION 8 AS PROJECTED WITHIN THE REASON REED D.L.C. #58; POINT OF DIVERSION #2 IS LOCATED 750 FEET SOUTH AND 4220 FEET WEST, BEING WITHIN THE NW1/4 OF THE NW 1/4 OF SECTION 8 AS PROJECTED WITHIN THE SOLOMON WILLIAMSON D.L.C. #55, BOTH BEING FROM THE NE CORNER OF SECTION 8, AND BOTH BEING WITHIN TOWNSHIP 25 SOUTH, RANGE 5 WEST, W.M., DOUGLAS COUNTY.

THE PURPOSE OF THIS MAP IS TO IDENTIFY THE LOCATION OF THE WATER RIGHT. IT IS NOT INTENDED TO PROVIDE INFORMATION RELATIVE TO THE LOCATION OF PROPERTY OWNERSHIP BOUNDARY LINES.

-  SUPP'L TO C-51440
-  SUPP'L TO C-57551
-  SUPP'L TO C-38695
-  PPIM. PINE HALLOW SUPP'L STORAGE } P47562
-  SUPP'L TO C-38696
-  SUPP'L TO P-49637
-  SUPP'L TO C-54420
-  PORTION OF PERMIT 49637

T.9S., R. 27E., W.M.

T.9S., R. 26E., W.M.

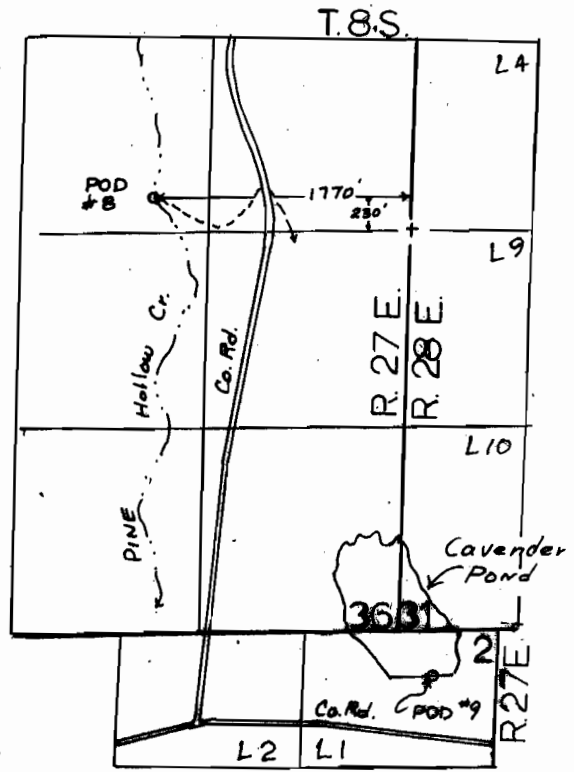
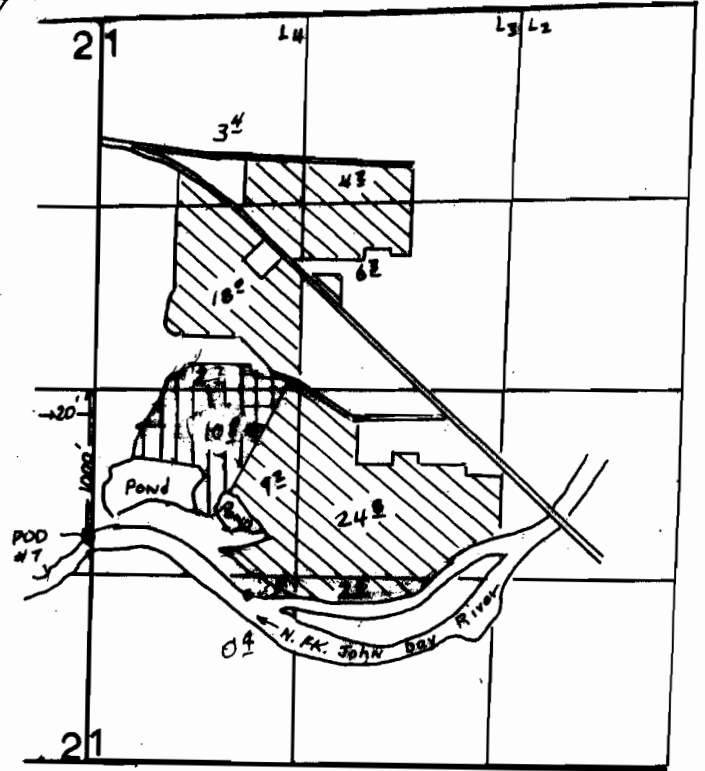
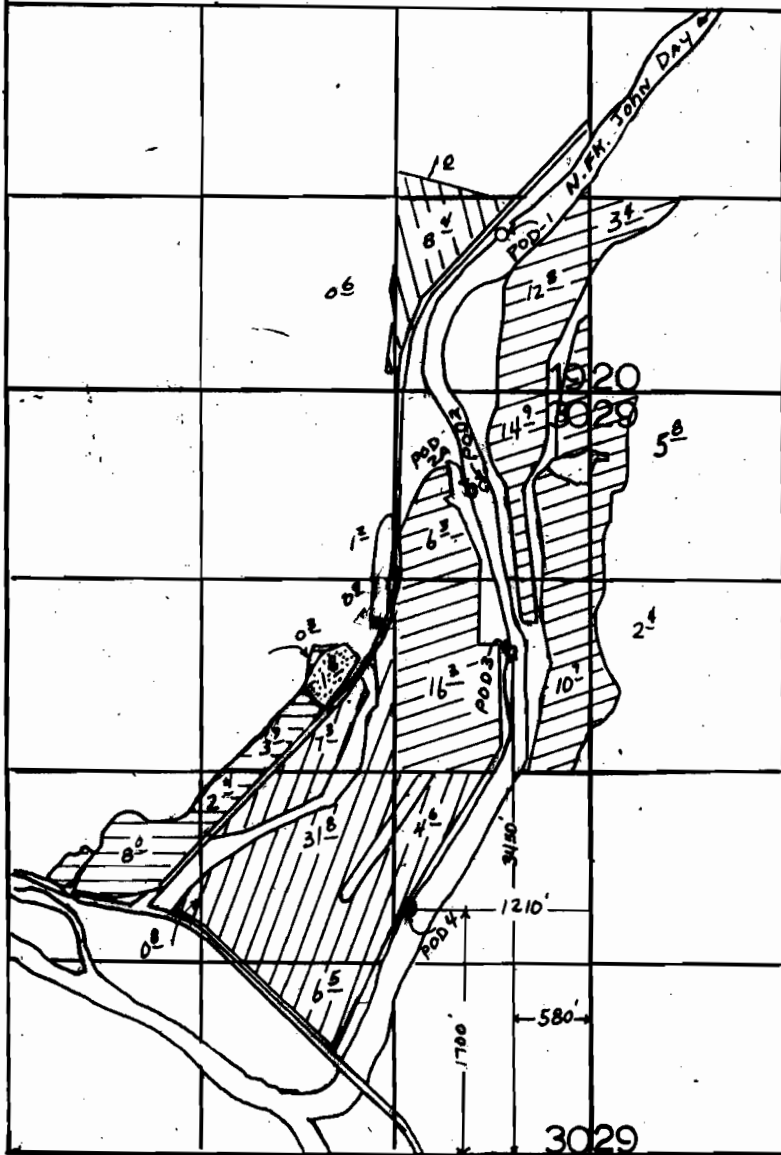

FINAL PROOF SURVEY
UNDER

Application R-61610 PERMIT R - 8654
65014 47562
IN THE NAME OF
THOMAS ORCHARDS, INC. & JACK CAVENDER
Surveyed 3-31-2000, By J. MILLER

POD-1, 1100' N. & 580' W. FROM SE COR. SEC. 19.
POD-2, 620' S. & 730' W. FROM NE COR. SEC. 30.
POD-2A, 680' S. & 830' W. FROM NE COR. SEC. 30
POD-7, 1000' S. & 20' W. FROM E 1/4 COR. SEC. 2.
POD-8, 230' N. & 1770' W. FROM E 1/4 COR. SEC. 36.
POD-9, 300' S. & 220' E. FROM SW COR. SEC. 31.