

# Application for a Water Right Transfer

Certificate 28737

Township 3 North, Range 28 East (W.M.)

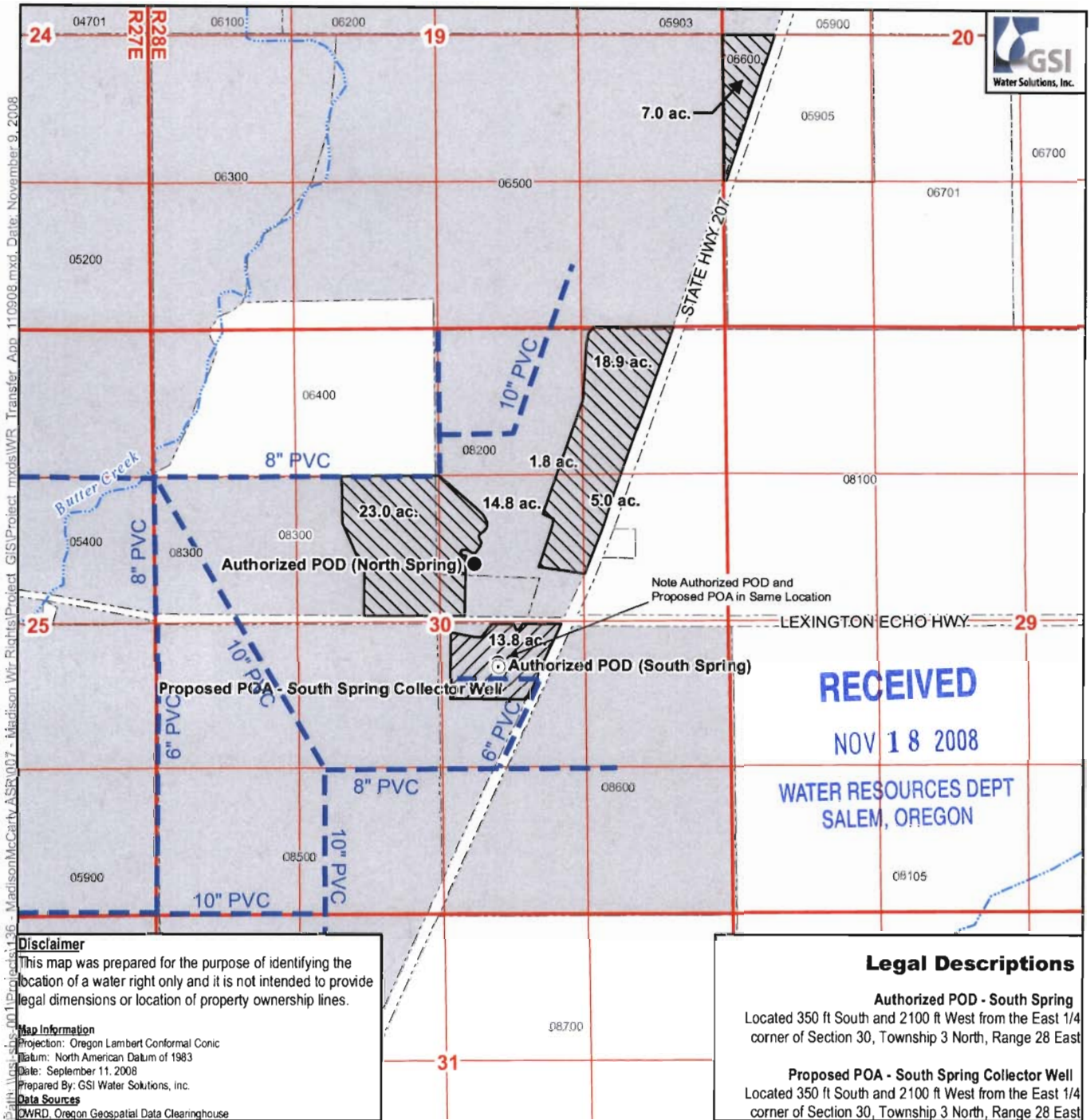

## Legend

- Proposed Point of Appropriation (POA)
- Currently Authorized Point of Diversion (POD)
- ▨ Currently Authorized Place of Use (POU) - Not Included in Transfer
- ▩ Currently Authorized POU Proposed for Transfer
- Property Owned by Applicant
- Water Pipeline
- ~ Creeks and Streams



**Scale**  
0 660 1,320  
1 inch equals 1,320 feet

