

TOWNSHIP, 12 SOUTH, RANGE 25 EAST, W. M.

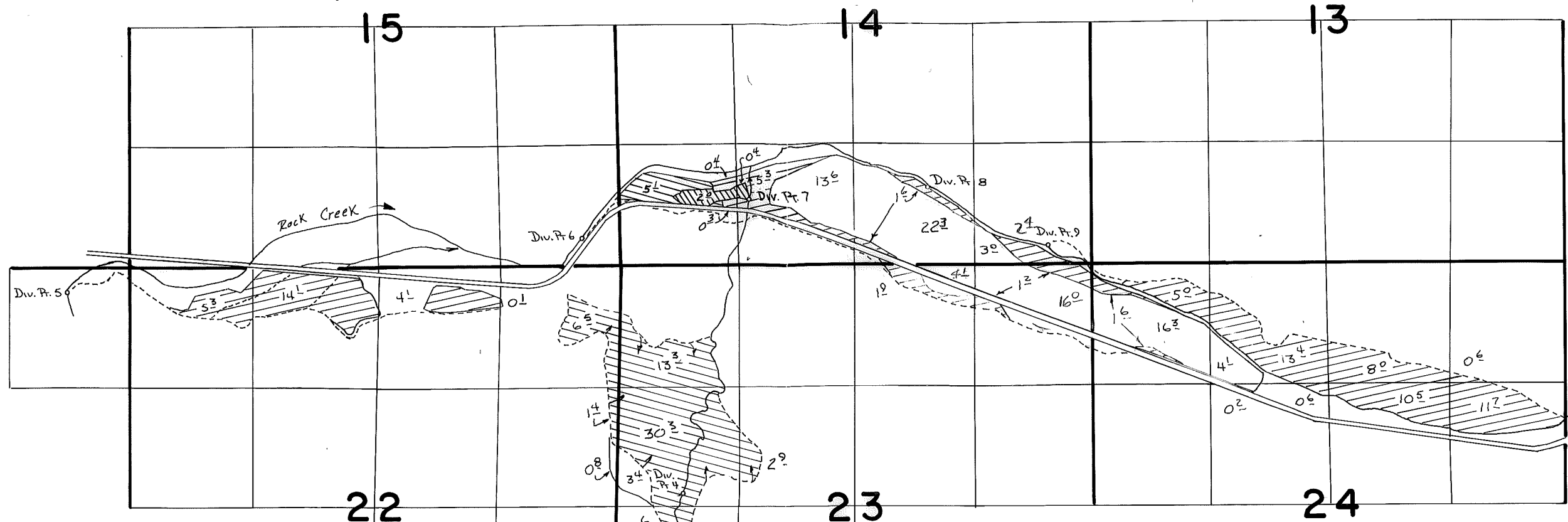

SCALE 1" = 1320'

- Div. Pts. Located:
1. 1800'S. & 1510'W. from E1/4 cor. SEC. 27
  2. 250'S. & 870'W. from E1/4 cor. SEC. 27
  3. 410'S. & 710'E. } from W1/4 cor. SEC. 23
  4. 140'N. & 720'E. }
  5. 270'S. & 680'W. from NE cor. SEC. 21
  6. 300'N. & 410'W. }
  7. 730'N. & 1420'E. } from SW cor. SEC. 14
  8. 850'N. & 3380'E. }
  9. 200'N. & 470'E. from SE cor. SEC. 14

 Rock Creek

 Birch Creek - Primary

 Birch Creek - Suppl.

**FINAL PROOF SURVEY**  
UNDER

Application No. 37728 Permit No. 28123  
IN NAME OF

*Try Creek Ranch Inc.*

Surveyed AUG. 20 1976, by D. NORBY  
JULY 25 79 C.L. HUGHES

