

RECEIVED

T.6S. R.1W. W.M.

MAY 29 1998

WATER RESOURCES DEPT.
SALEM, OREGON

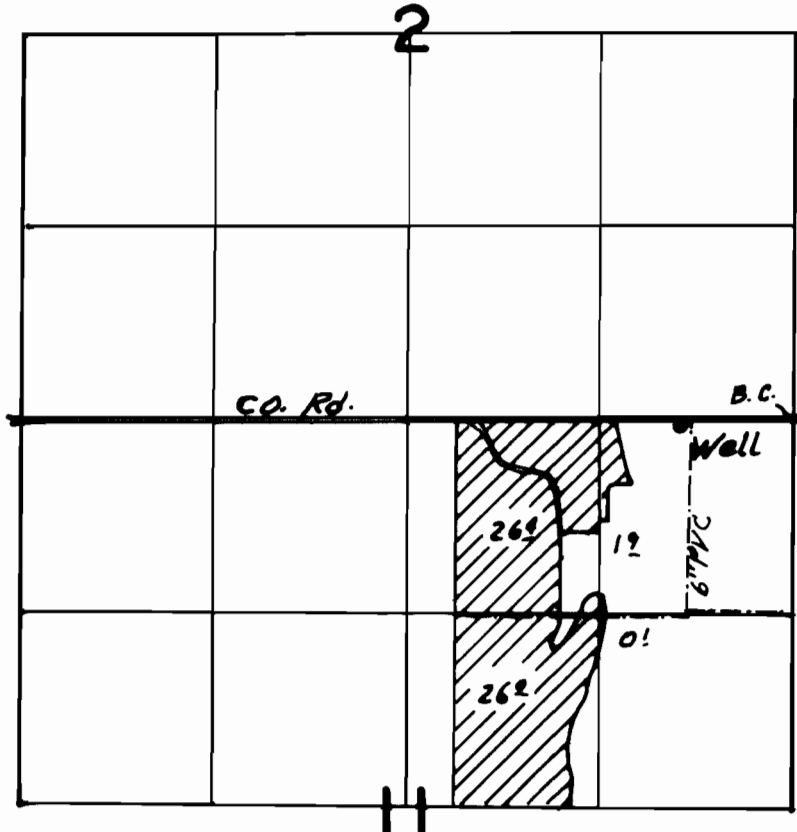

Well loc. 80' S & 770' W from NE Cor Sec 11

FINAL PROOF SURVEY
UNDER

Transfer No. T-7085

~~Application No.~~ ~~Permit No.~~

IN NAME OF

ROBERT FESSLER

Surveyed Mar. 6, 1998, by

THIS MAP WAS PREPARED FOR THE PURPOSE OF IDENTIFYING THE LOCATION OF A WATER RIGHT ONLY AND IS NOT INTENDED TO PROVIDE LEGAL DIMENSIONS OR LOCATION OF PROPERTY OWNERSHIP LINES.

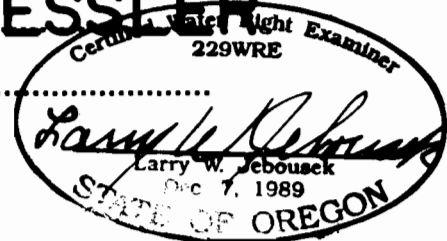

WAC 92-8B-4