

RECEIVED

SEP - 4 1997
WATER RESOURCES DEPT.
SALEM, OREGON

FINAL PROOF SURVEY MAP
located in the SW 1/4 NW 1/4 of Section 9
and the SE 1/4 NE 1/4 of Section 8,
Township 29 South, Range 14 West, W.M.
Coos County, Oregon
Transfer 7027, T-7028, & T-7029

Prepared For: Ben & Rebecca Flugstad
Prepared By: Dennis Goude
Date Surveyed: July 17, 1997

NOTE:
The P.O.D. is an in-stream
10 HP pump. Located 1415
feet South and 824 feet
East of the Northeast
corner of Section 8,
Township 29 South Range
14 West, W.M.

13.8 ac.
SE 1/4 NE 1/4

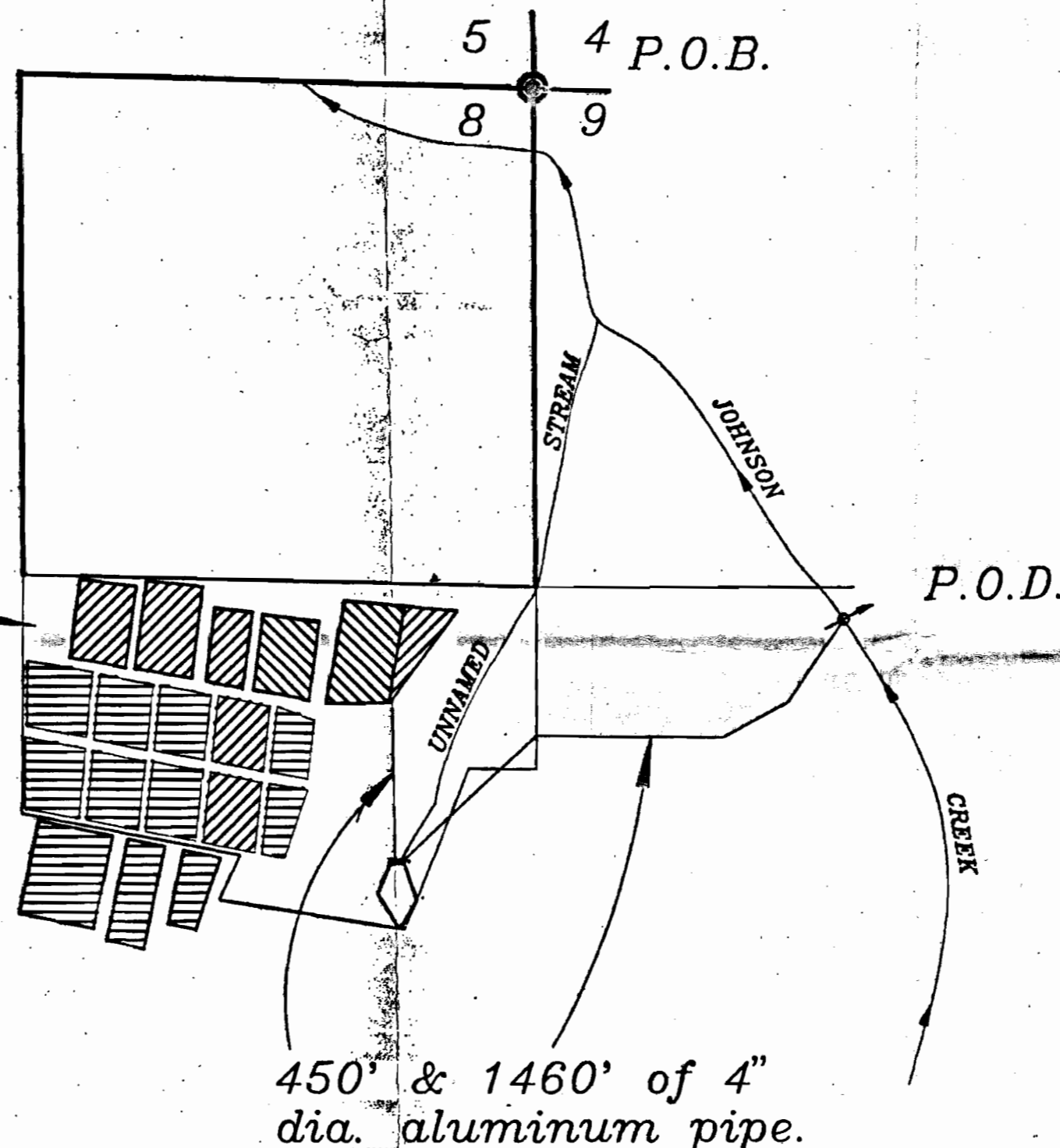

LEGEND

- P.O.B.
- P.O.D.
- PIPE
- STREAM
- IRRIGATED AREA

T-7027	4.3 ac.	
T-7028	2.5 ac.	
T-7029	5.8 ac.	

SCALE
1" = 400'

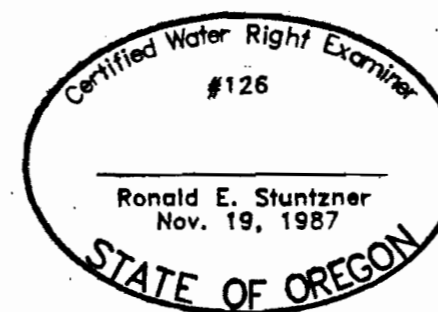

EXPIRES 06/30/98

← unsigned

EXAMINERS DISCLAIMER STATEMENT
The preparation of this map was for the purpose of identifying the location of the Water Right only and has no intent to provide dimensions or location of property ownership lines.

Stuntzner Engineering
& Forestry, L.L.C.

ENGINEERING • LAND SURVEYING • FORESTRY
PLANNING • WATER RIGHTS

705 South 4th St. Phone: (541) 267-2872
Post Office Box 118 Coos Bay, Oregon 97420 Fax: (541) 267-0588

Drawn By: Dennis Goude	Date: August 27, 1997
Checked By: Tom Wilczek	Drawing No.: 97-171
Designed By:	Revised:
Job Name: Flugstad	Sheet 1 of 1