

# WATER RIGHT TRANSFER MAP

## T26S, R4W, WM

SCALE 1" = 1320'

T6955

DOUGLAS COUNTY

NORTH BANK COUNTY RD NO 200

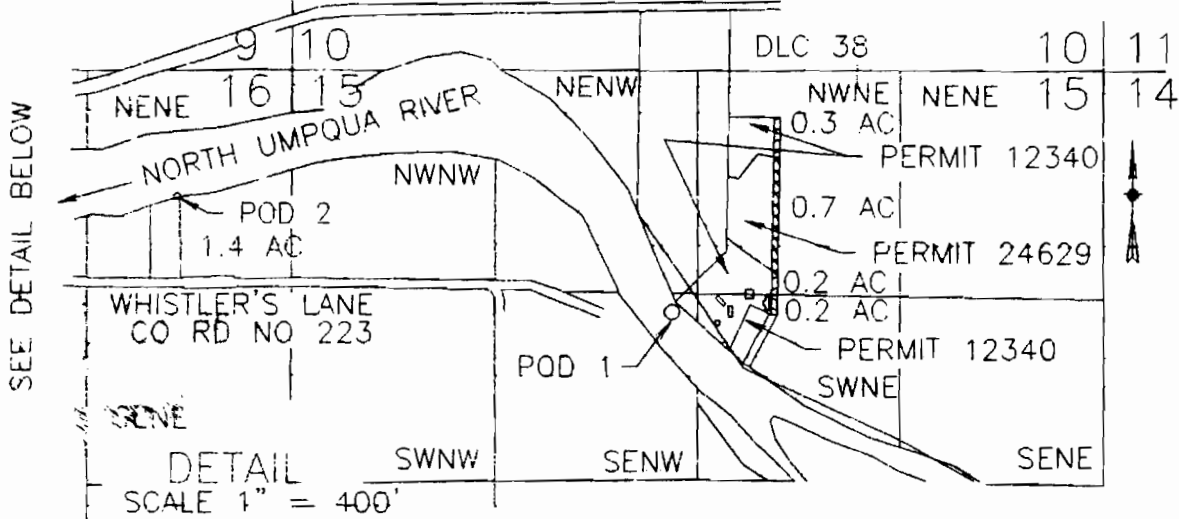

SEE DETAIL BELOW

DETAIL  
SCALE 1" = 400'

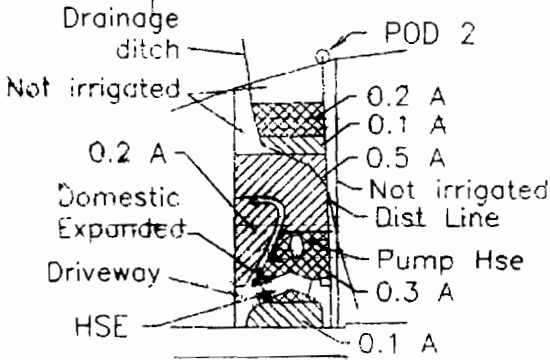

PERMIT NO 24629,  
DECEMBER 17, 1956

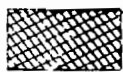

PRIMARY PERMIT NO 51442, FEB 18, 1992  
SUPPL PERMIT NO 12340, AUG 31, 1936



PERMIT NO 12340, AUGUST 31, 1936

TRANSFER OF WATER RIGHT FROM NWNE  
AND SWNE SEC 15 TO NENE SEC 16

POD 1 IS 1550 FT S AND 2760 FT W FROM NE COR SEC 15

POD 2 IS 520 FT N AND 580 FT E FROM SW COR, NE 1/4 NE 1/4, SEC 16

### FINAL PROOF SURVEY

UNDER

Application No. T-6955

IN NAME OF

WILLIAM OR SHIRLEY BUCKINGHAM

Surveyed July 20, 1994

by M E Farr

OWNERS

WILLIAM OR SHIRLEY BUCKINGHAM  
1250 WHISTLERS LANE  
ROSEBURG, OR 97470

CWRE

MAURICE E FARR  
395 NE KIRBY AVENUE  
ROSEBURG, OR 97470

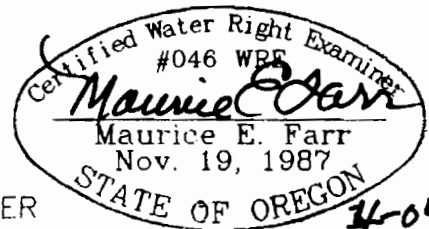

THIS IS A LOCATION MAP FOR A WATER RIGHT TRANSFER BY WILLIAM OR SHIRLEY BUCKINGHAM. THIS MAP IS FOR THE PURPOSE OF IDENTIFYING THE LOCATION OF THE WATER ONLY AND IS NOT INTENDED TO PROVIDE LEGAL DIMENSIONS OR LOCATIONS OF PROPERTY OWNERSHIP LINES.

EXPIRES 12-31-05

