

T. 5 S. R. 1 W. W. M.

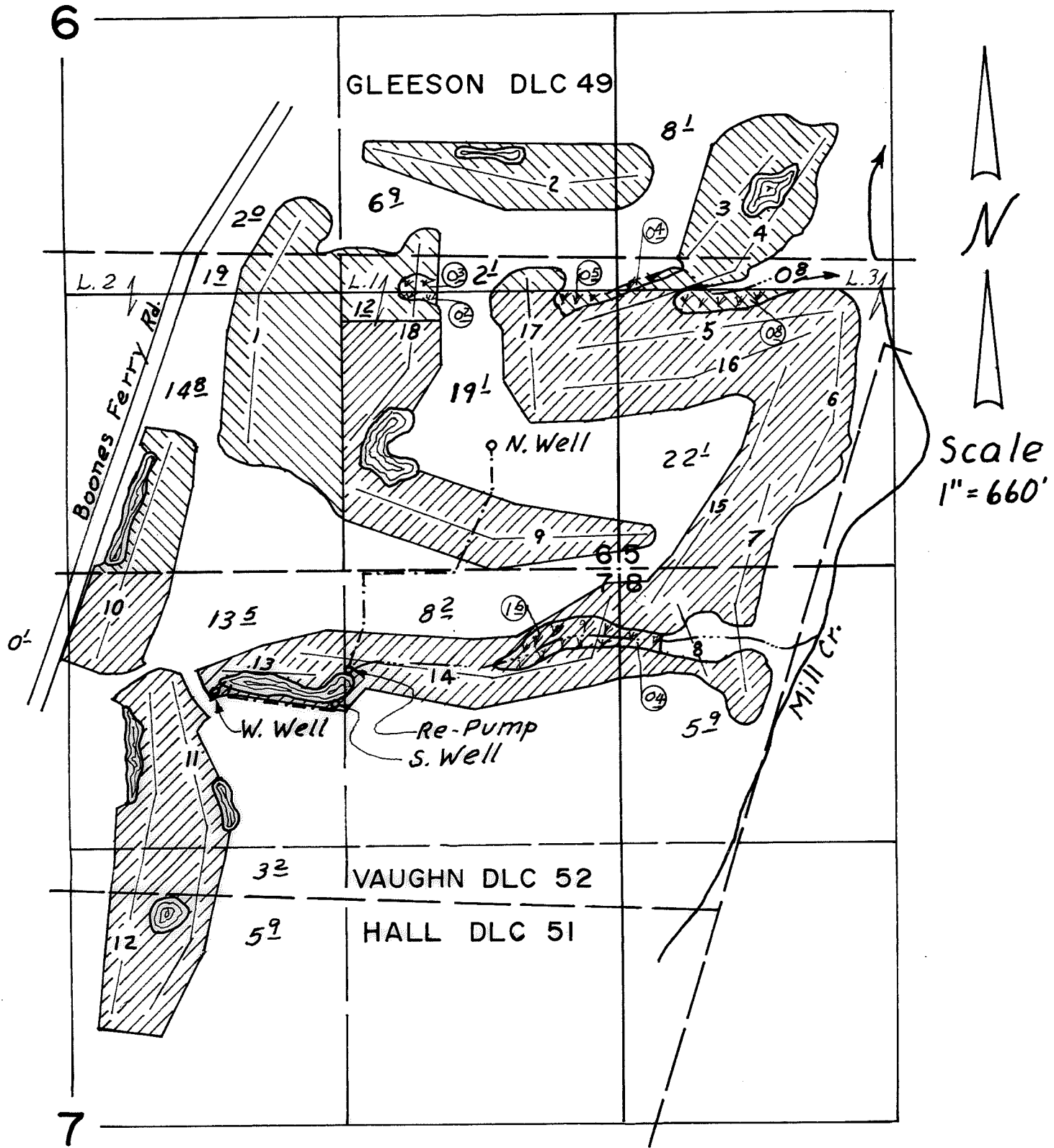

NORTH WELL LOC. 600' N. & 610' W. ALL FROM
 SOUTH WELL LOC. 613' S. & 1325' W. 6 | 5
 WEST WELL LOC. 588' S. & 1924' W. 7 | 8

JUNE 9, 1961 MARCH 16, 1965
 Wetlands

RECEIVED

APR 17 1997

WATER RESOURCES DEPT.
 SALEM, OREGON

FINAL PROOF SURVEY
 FOR
 TRANSFER NO. T-7013 BY
OREGON
GOLF ASSOCIATION
Tukwila Course

THIS MAP WAS PREPARED FOR THE PURPOSE OF IDENTIFYING THE LOCATION OF A WATER RIGHT ONLY AND IS NOT INTENDED TO PROVIDE LEGAL DIMENSIONS OR LOCATION OF PROPERTY OWNERSHIP LINES.

Certified Water Right Examiner
 # 229

 LARRY W. JEBOUSEK
 Dec. 7, 1989
 STATE OF OREGON