

T. 5 S. R. 1 W. W. M.

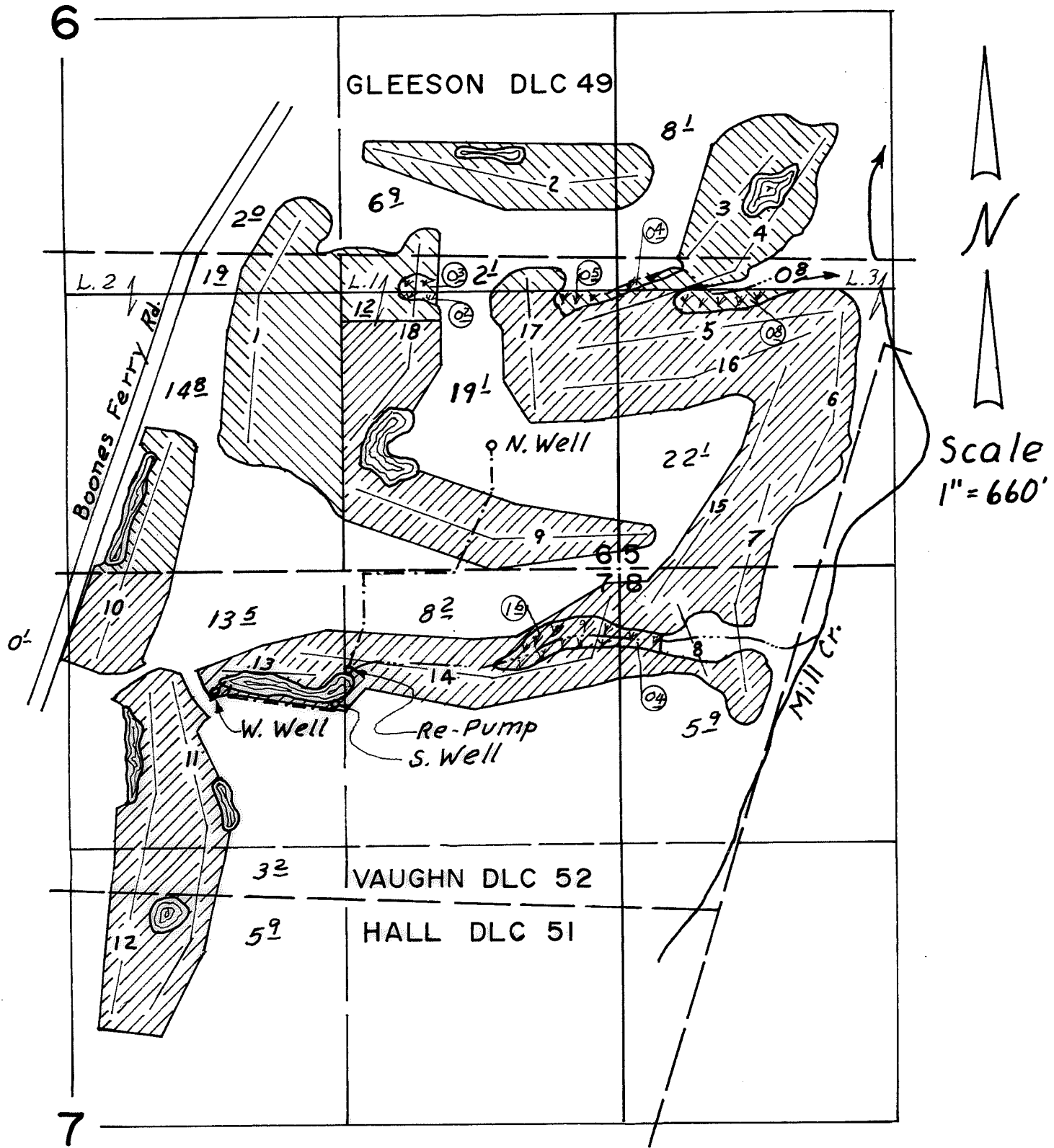

NORTH WELL LOC. 600' N. & 610' W. ALL FROM  
 SOUTH WELL LOC. 613' S. & 1325' W. 6 | 5  
 WEST WELL LOC. 588' S. & 1924' W. 7 | 8

JUNE 9, 1961 MARCH 16, 1965  
 Wetlands 

**RECEIVED**

APR 17 1997

WATER RESOURCES DEPT.  
 SALEM, OREGON

FINAL PROOF SURVEY  
 FOR  
 TRANSFER NO. T-7013 BY  
**OREGON**  
**GOLF ASSOCIATION**  
**Tukwila Course**

THIS MAP WAS PREPARED FOR THE  
 PURPOSE OF IDENTIFYING THE LOCA-  
 TION OF A WATER RIGHT ONLY AND IS  
 NOT INTENDED TO PROVIDE LEGAL  
 DIMENSIONS OR LOCATION OF PROPER-  
 TY OWNERSHIP LINES.

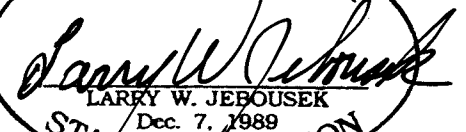
Certified Water Right Examiner  
 # 229  
  
 LARRY W. JEBOUSEK  
 Dec. 7, 1989  
 STATE OF OREGON