

T.5N.R.30E.W.M.

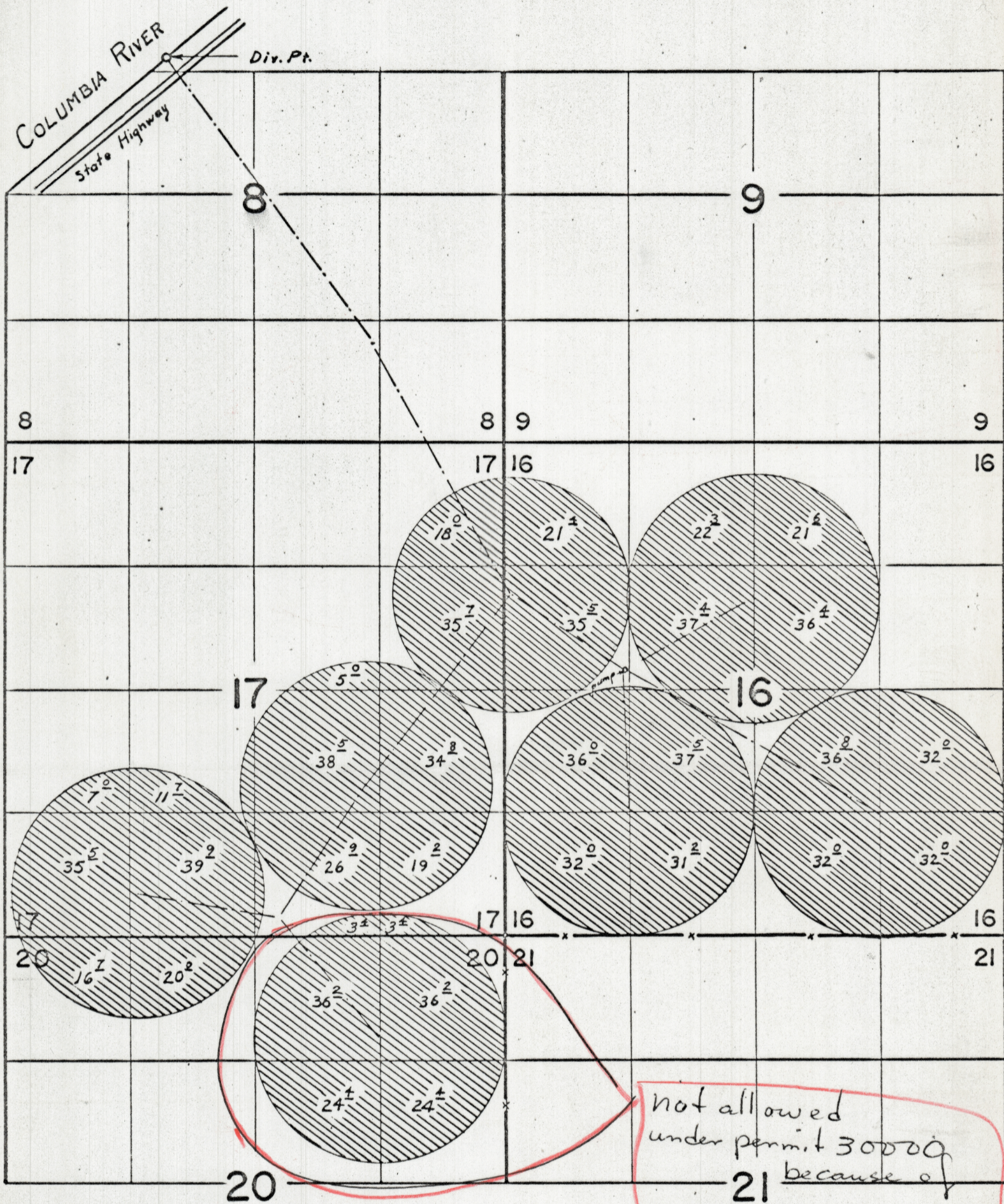

not allowed
under permit 30000
because of
overage
Can be allowed
on permit 33594

Div. Pt. located: 9360 ft. N. & 3530 ft. W. from SE. cor. Sec. 17.

FINAL PROOF SURVEY
UNDER

Application No. 40223 Permit No. 30000

IN NAME OF

ERVIN ED MUMDS

by L. E. Gould