

T. 5 N. R. 30 E. W. M.

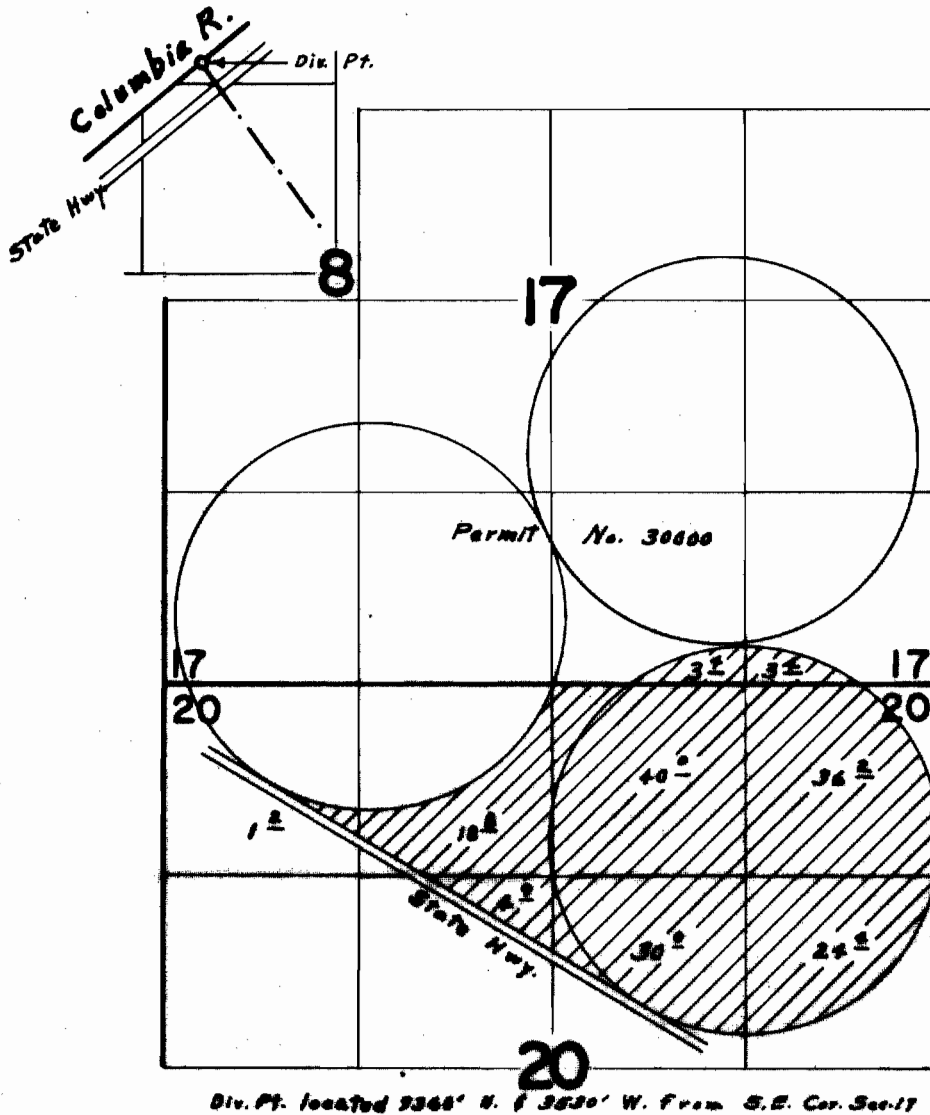

Div. Pt. located 3360' N. & 3630' W. from S.E. Cor. Sec. 17

**FINAL PROOF SURVEY**  
UNDER

Application No. 45719 Permit No. 33594  
IN NAME OF

ERVIN R. EDMUNDS

Surveyed Sept. 2, 1971, by L. E. Gould