

# T.4S. R.1E., W.M

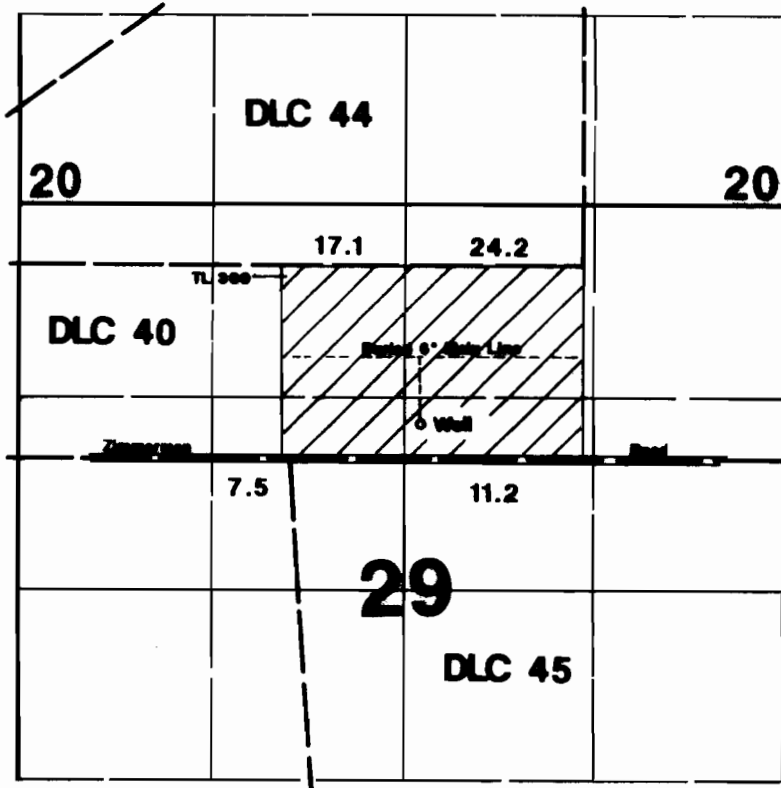

Well is located 1120'S & 1102'W from the SE corner of DLC 44.

**RECEIVED**  
**AUG 26 2000**  
 WATER RESOURCES DEPT  
 SALEM, OREGON

## Final Proof Survey

Application #: G-13284 Permit #: G-11878

In Name Of

**Pure Seed Testing Inc.**

Surveyed on September 18, 1998 by JM Schuette

This Map Was Prepared For The Purpose Of Identifying The Location Of A Water Right Only And Is Not Intended To Provide Legal Dimensions Or Location Of Property Ownership Lines.

