

# T.6S., R.2W., W.M.

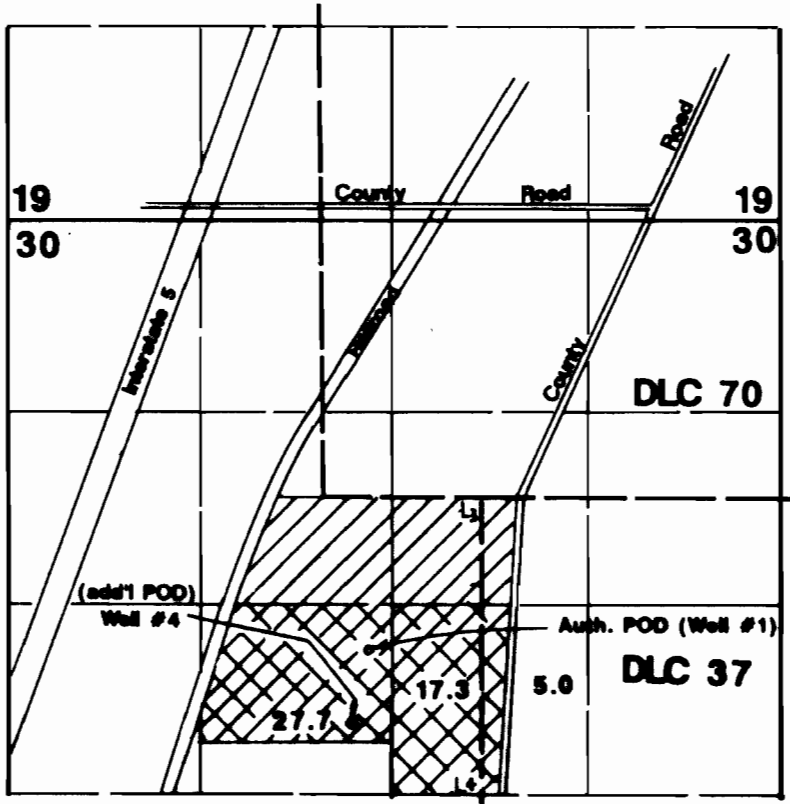

Auth. POD located 1040'S & 310'E  
 Add'l POD located 1550'S & 200'E both from SW corner DLC 70.

1" = 1320'

Area Irrigated

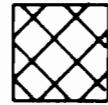

Add'l POD

**RECEIVED**

SEP 24 1996

WATER RESOURCES DEPT.  
 SALEM, OREGON

## Final Proof Survey

Transfer #: T-7010

In Name Of

### Victor Petroff

(Trustee Madelon Petroff Living Trust)

Surveyed on September 12, 1996 by JM Schuetz

THIS MAP WAS PREPARED FOR THE PURPOSE OF IDENTIFYING THE LOCATION OF A WATER RIGHT ONLY AND IS NOT INTENDED TO PROVIDE LEGAL DIMENSIONS OR LOCATION OF PROPERTY OWNERSHIP LINES.

