

T.35S.,R.1W.,W.M.  
 Jackson County, Oregon  
 Tax Lot No. 351W 17 - 255  
 ROGUE RIVER BASIN

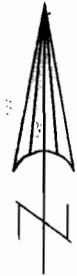

SCALE 1" = 400'

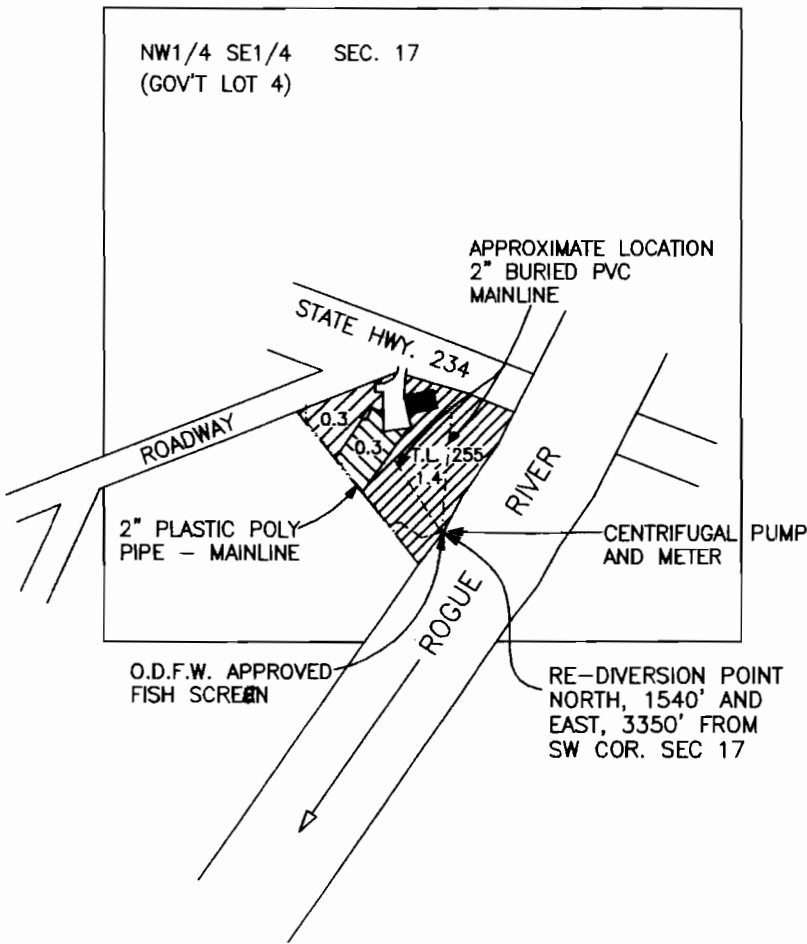

NOTE: MAP PREPARED FOR WATER RIGHT PURPOSES ONLY, NOT FOR PROPERTY BOUNDARY LOCATIONS.

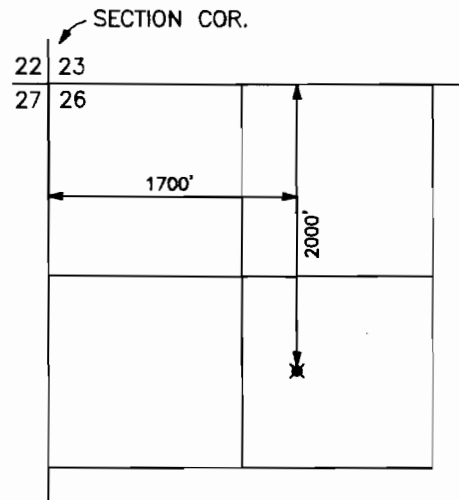

LOST CREEK RESERVOIR  
 POINT OF DIVERSION  
 T.33S.,R.1E.,W.M.  
 SCALE 1" = 1320'

CLAIM OF BENEFICIAL USE MAP  
 APPLICATION No. S-87396  
 PERMIT No. S-54591

FOR: Stanley and Jean Camiccia  
 1503 Hwy. 234  
 Eagle Point, OR 97524

PREPARED BY: GARY D. KAISER  
 KAISER SURVEYING  
 19440 HWY. 62  
 EAGLE POINT, OR. 97524



= AREA IRRIGATED WITH  
 LOST CREEK RESERVOIR WATER  
 BY PERMIT S-54591

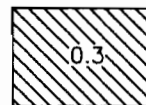

= AREA OF TAX LOT  
 255 IRRIGATED  
 BY PERMIT 298  
 T-W-112

July 26, 2010