

4311
8679

T. 33 S. R. 6 E. M.W.

T. 33 S. R. 7 1/2 E. M.W.

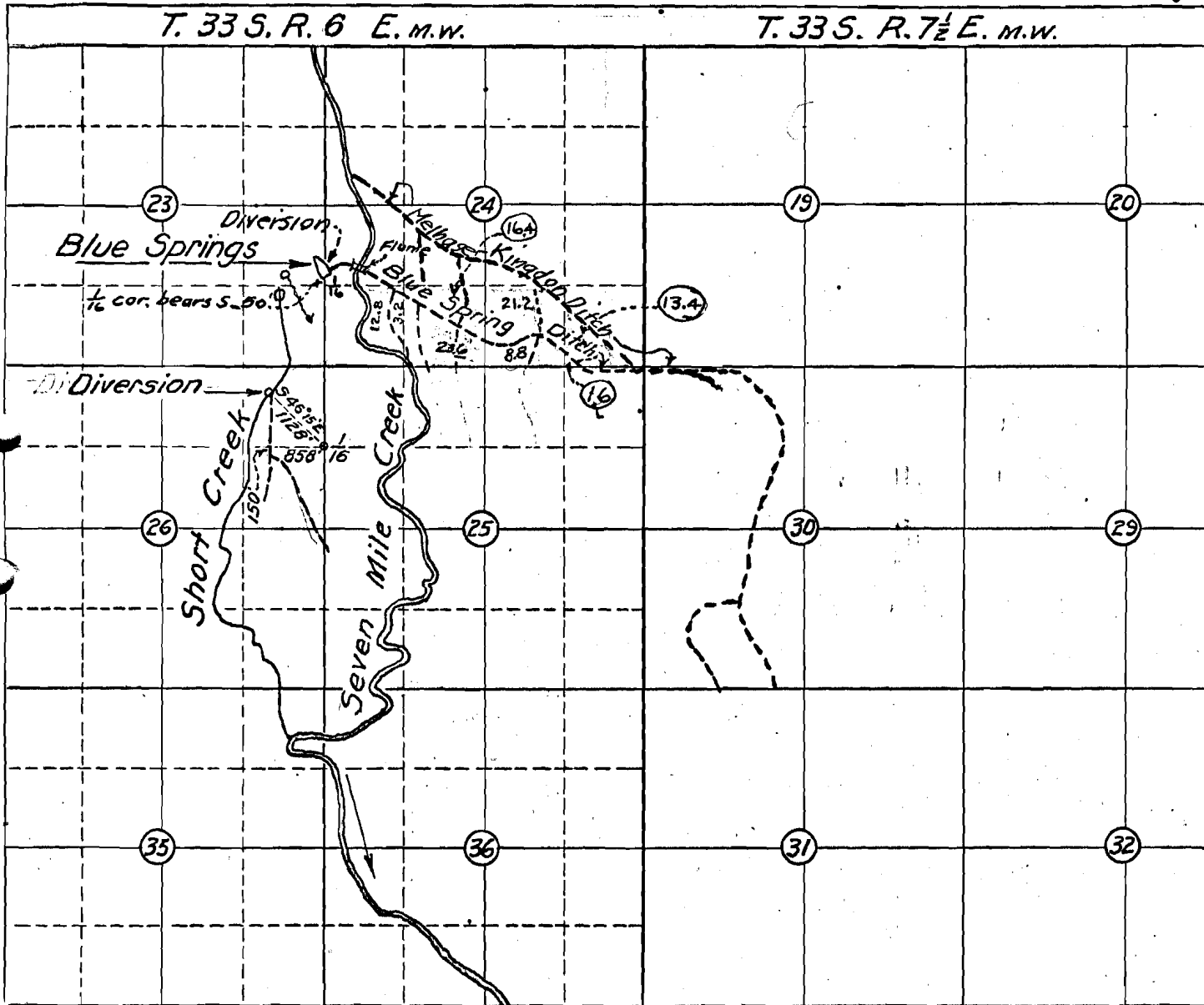

Map

Accompanying application of James T Dixon for Appropriation of water from Blue Springs, Klamath County Oregon. Scale 2"=1 mile.

Engineer's Certificate:

I, C.C. Kelley, of Klamath Falls, Oregon, do hereby certify that this map was made from notes taken during an actual survey made under my immediate supervision on the 24th day of July, 1928, and that it correctly represents the works described in the accompanying application, together with the location of streams and other ditches in the immediate vicinity.

Application No. 12344
Permit No. 9371

C.C. Kelley
Registered Professional Engineer.
Oregon No. 308