

RECEIVED

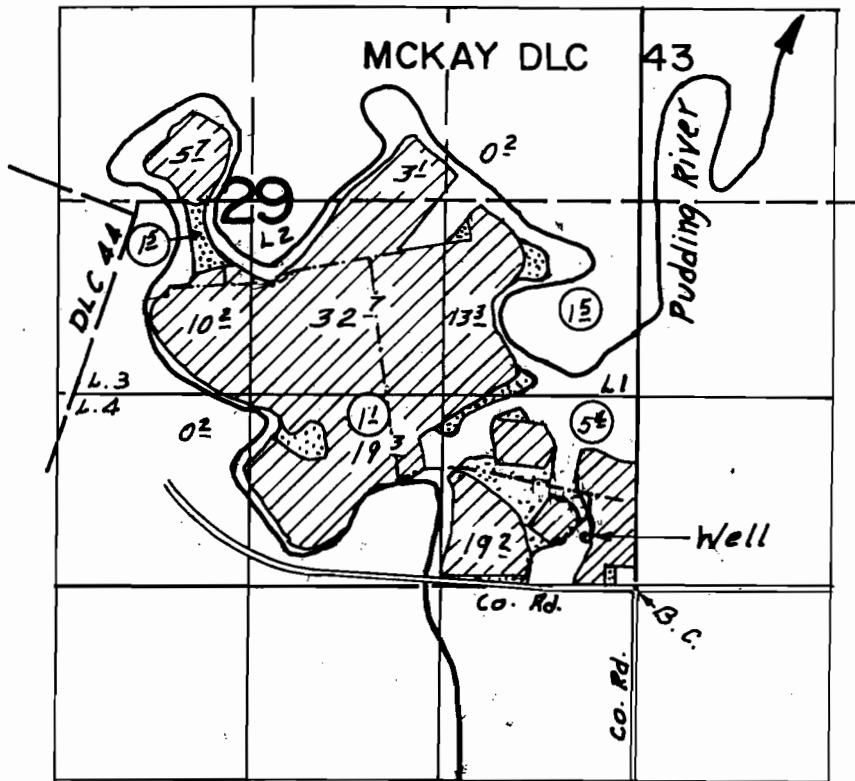

DEC 31 1997

T.5S. R.1W., W.M.

WATER RESOURCES DEPT.  
SALEM, OREGON

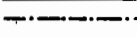

Well Loc.: 235' N & 925' W from SW Cor. Sec. 29

-  Primary (ac.)
-  Supplemental
-  6" PVC Pipe

SE  
7WS

### FINAL PROOF SURVEY UNDER

Transfer No. T- 6964  
Application No. G-13382 Permit No. G-11758..  
IN NAME OF

DAVID...O.B.ERSIN.N.E.R.....

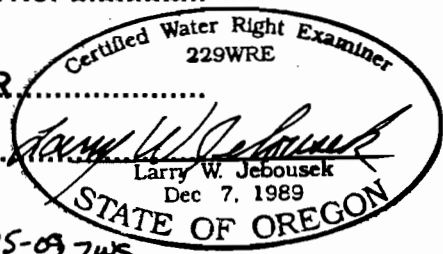

Surveyed Aug. 13, 1997, by ..

THIS MAP WAS PREPARED FOR THE PURPOSE OF IDENTIFYING THE LOCATION OF A WATER RIGHT ONLY AND IS NOT INTENDED TO PROVIDE LEGAL DIMENSIONS OR LOCATION OF PROPERTY OWNERSHIP LINES.

Amended by WRD staff, 6-25-09 7WS  
WAC-MARION Co.-92 7C-6 Photo