

**Claim of Beneficial Use
Place of Use Map 1 of 2
Permit S-20177 (Application S-24211)**

RECEIVED
JAN 06 2011
WATER RESOURCES DEPT
SALEM, OREGON

- Legend**
- Point of Diversion (POD)
 - ▨ Place of Use (POU)*
 - Transmission Pipeline
 - Roads
 - ~ Watercourses
 - Waterbodies

*In accordance with Permit S-20177, stored water was used by the City of Medford (Medford Water Commission) for compensating Eagle Point Irrigation District in exchange for water diverted from Big Butte Springs by the City under this permit and other water rights held by the City. The Place of Use shown encompasses the cumulative authorized area of use of the City's water rights for Big Butte Springs (in their current state of development), facilitated as needed by water used under Permit S-20177.

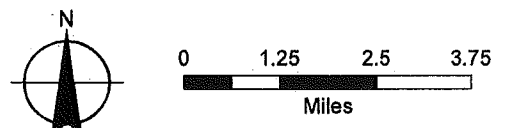
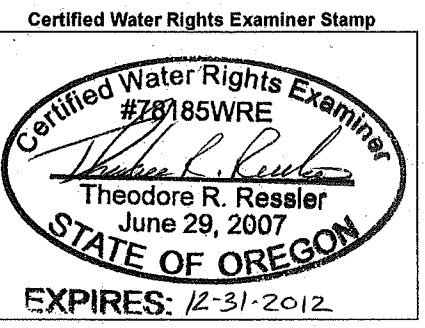

Disclaimer
This map was prepared for the purpose of identifying the location of a water right only and it is not intended to provide legal dimensions or location of property ownership lines.

Map Notes
Date: December 15, 2010
Data Sources: Jackson County GIS, OWRD
Prepared By: GSI Water Solutions, Inc.



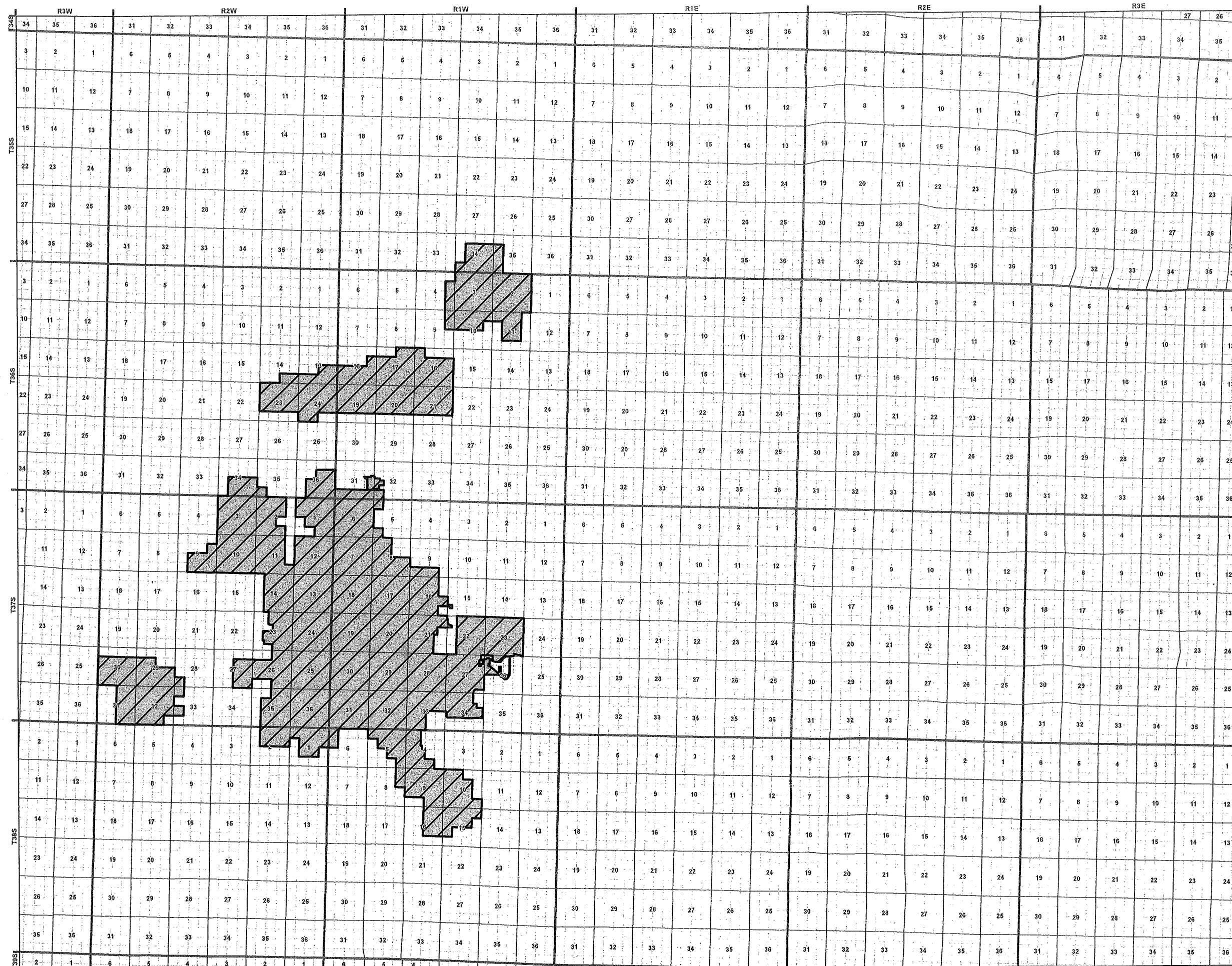

**Claim of Beneficial Use
Place of Use Map 2 of 2**
Permit S-20177 (Application S-24211)

Legend
 Place of Use (POU)*

RECEIVED
 JAN 06 2011
 WATER RESOURCES DEPT
 SALEM, OREGON

*In accordance with Permit S-20177, stored water was used by the City of Medford (Medford Water Commission) for compensating Eagle Point Irrigation District in exchange for water diverted from Big Butte Springs by the City under this permit and other water rights held by the City. The Place of Use shown encompasses the cumulative authorized area of use of the City's water rights for Big Butte Springs (in their current state of development), facilitated as needed by water used under Permit S-20177.

Certified Water Rights Examiner Stamp

 EXPIRES: 12-31-2012

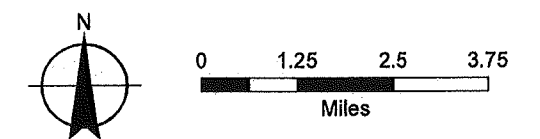

Disclaimer
 This map was prepared for the purpose of identifying the location of a water right only and it is not intended to provide legal dimensions or location of property ownership lines.

Map Notes
 Date: December 15, 2010
 Data Sources: Jackson County GIS, OWRD
 Prepared By: GSI Water Solutions, Inc.

