

T.9 S.R.3 E.W.M.

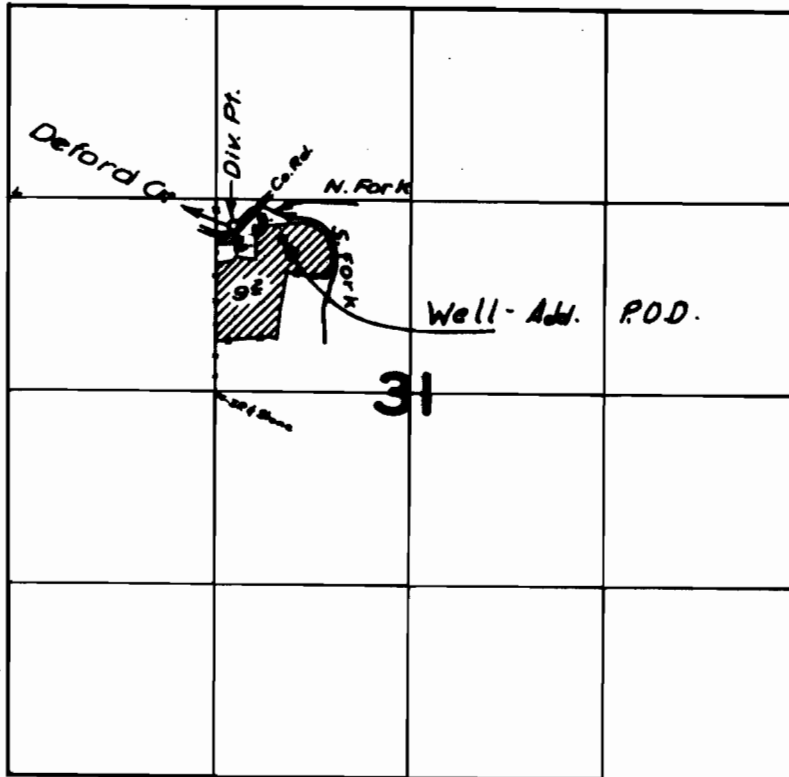

Scale
4" = 1 Mi.

Well Loc. 273' S & 442' E from NW Cor. of
SE 1/4 NW 1/4 of Sec. 31.

RECEIVED

JUL 8 • 1998

FINAL PROOF SURVEY
MAP FOR TRANSFER NO. I-7710 BY WATER RESOURCES DEPT.
THOMAS J. & PHYLLIS R. FENCL

SALEM, OREGON

THIS MAP WAS PREPARED FOR THE
PURPOSE OF IDENTIFYING THE LOCA-
TION OF A WATER RIGHT ONLY AND IS
NOT INTENDED TO PROVIDE LEGAL
DIMENSIONS OR LOCATION OF PROPER-
TY OWNERSHIP LINES.

PREPARED BY

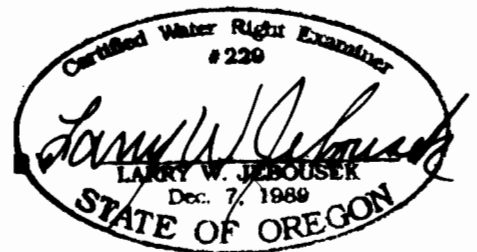

Inspected June 1, 1998