

**Claim of Beneficial Use  
Point of Diversion Map  
Transfer T-10615 (Permit S-18443)  
Township 20 South, Range 3 West (W.M.)**

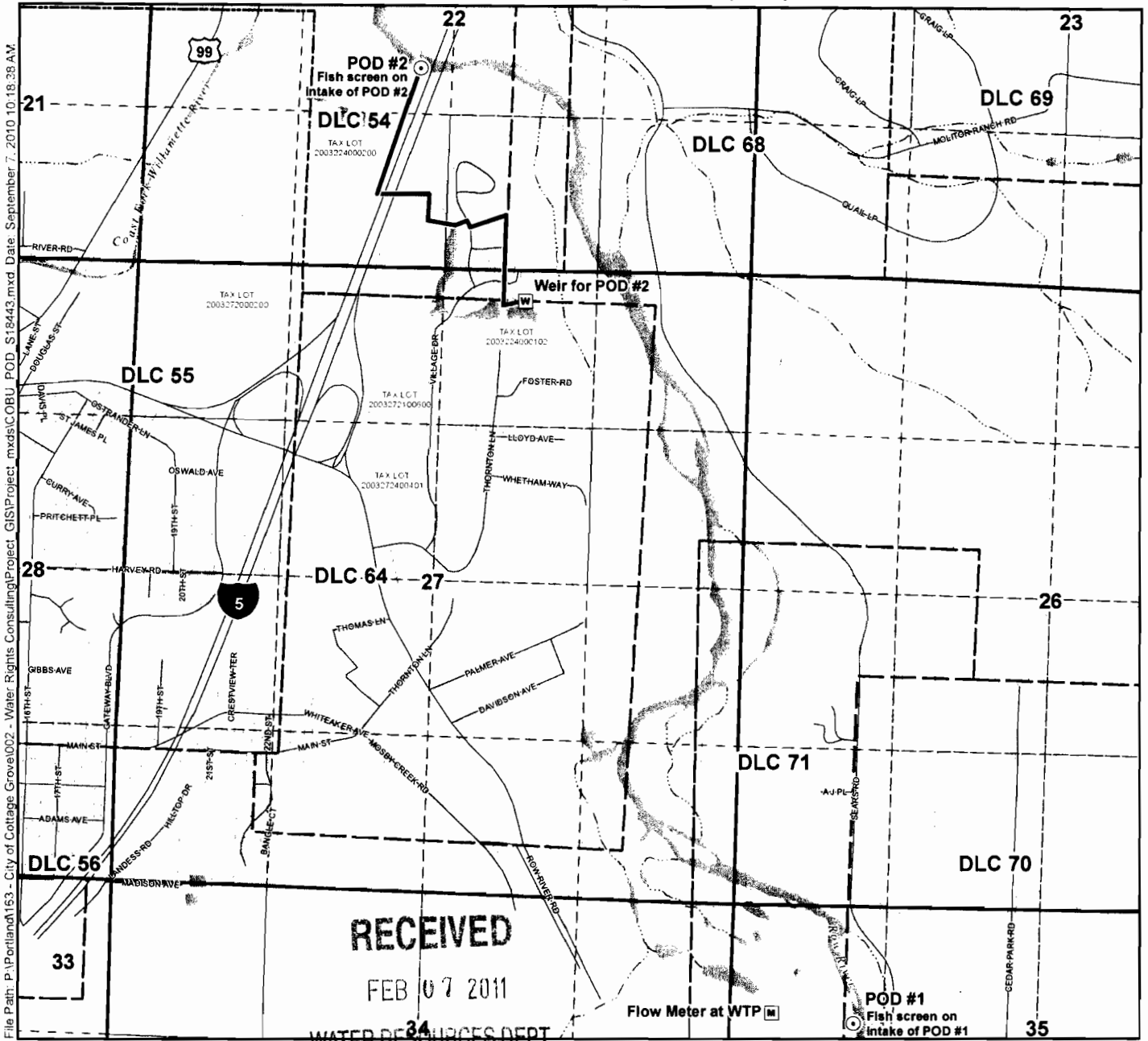

**RECEIVED**  
FEB 07 2011  
WATER RESOURCES DEPT  
SALEM, OREGON

- Legend**
- ⊙ Point of Diversion (POD)
  - Existing Mainline for POD #2  
(See COBU report for POD #1 mainlines)
  - ▭ Tax Lots
  - Roads
  - ~ Waterbodies
  - ~ Watercourses
- POD Legal Descriptions**
- POD #1**  
Located 1,000 feet South and 1,050 feet East from the NW corner of Section 35, Township 20 South, Range 3 West (W.M.)
- POD #2**  
Located 1,695 feet North and 275 feet West from the S1/4 corner of Section 22, Township 20 South, Range 3 West (W.M.)



**Map Information**  
 Projection: Oregon State Plane South Zone  
 Datum: North American Datum of 1983  
 Date: September 7, 2010  
 Prepared By: GSI Water Solutions, Inc.

**Data Sources**  
 OWRD, LCOG, Oregon Geospatial Data Clearinghouse

**Disclaimer**  
 This map was prepared for the purpose of identifying the location of a water right only and it is not intended to provide legal dimensions or location of property ownership lines.

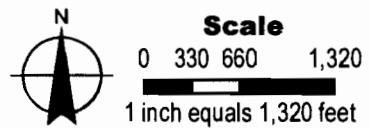

File Path: P:\Portland\153 - City of Cottage Grove\02 - Water Rights Consulting\Project\_GIS\Project.mxd; COBU\_POD\_S18443.mxd Date: September 7, 2010 10:18:38 AM

