

**Claim of Beneficial Use  
Point of Diversion Map  
Transfer T-10615 (Permit S-24696)  
Township 20 South, Range 3 West (W.M.)**

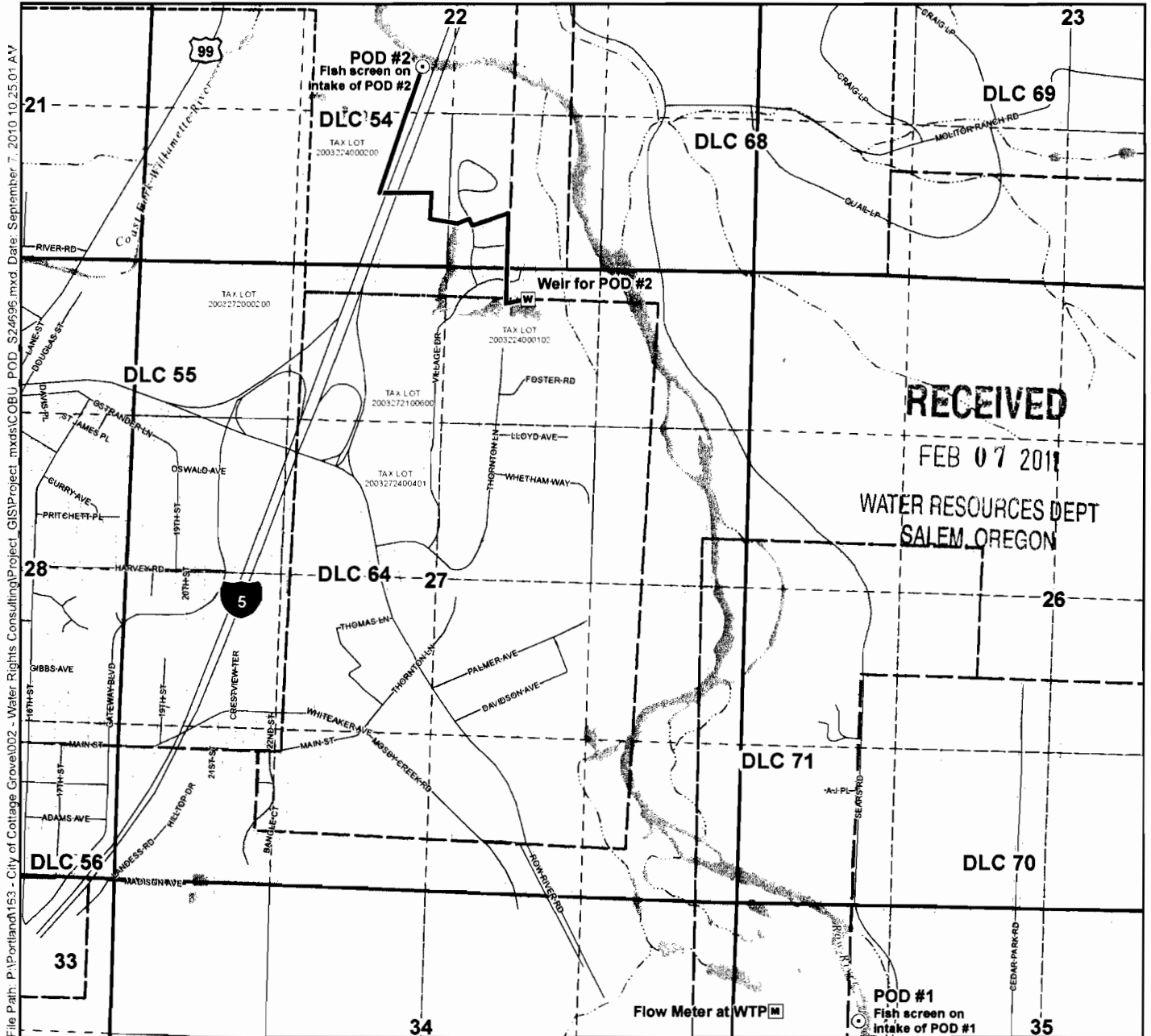

File Path: P:\Portland\153 - City of Cottage Grove\002 - Water Rights Consulting\Project\_GIS\Project.mxd\COBU\_POD\_S24696.mxd Date: September 7, 2010 10:25:01 AM

**RECEIVED**  
FEB 07 2011  
WATER RESOURCES DEPT  
SALEM, OREGON

**Legend**

- ⊙ Point of Diversion (POD)
- Existing Mainline for POD #2  
(See COBU report for POD #1 mainlines)
- ▭ Tax Lots
- Roads
- ▭ Waterbodies
- ~ Watercourses

**POD Legal Descriptions**

**POD #1**  
Located 1,000 feet South and 1,050 feet East from the NW corner of Section 35, Township 20 South, Range 3 West (W.M.)

**POD #2**  
Located 1,695 feet North and 275 feet West from the S1/4 corner of Section 22, Township 20 South, Range 3 West (W.M.)



**EXPIRES: 12-31-2012**

**Map Information**

Projection: Oregon State Plane South Zone  
Datum: North American Datum of 1983  
Date: September 7, 2010  
Prepared By: GSI Water Solutions, Inc.

**Data Sources**

OWRD, LCOG, Oregon Geospatial Data Clearinghouse

**Disclaimer**

This map was prepared for the purpose of identifying the location of a water right only and it is not intended to provide legal dimensions or location of property ownership lines.



**Scale**  
0 330 660 1,320  
1 inch equals 1,320 feet



# Claim of Beneficial Use

## Place of Use Map

Transfer T-10615 (Permit S-24696)

Townships 20 & 21 South, Range 3 West (W.M.)

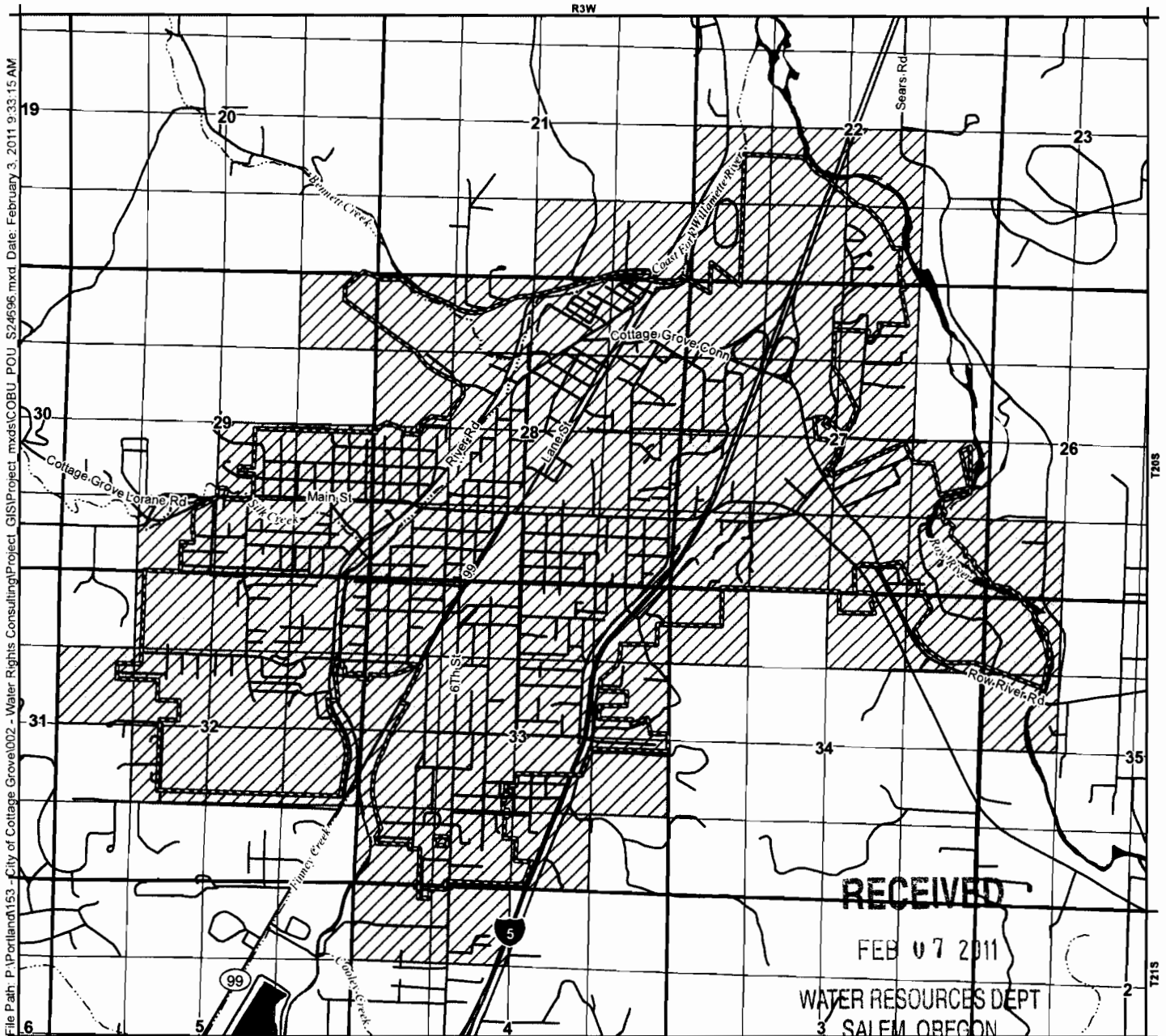

File Path: P:\Portland153 - City of Cottage Grove\002 - Water Rights Consulting\Project\_GIS\Project\_mxd\COBU\_POU\_S24696.mxd Date: February 3, 2011 9:33:15 AM

### Legend

- Place of Use (POU)
- Cottage Grove City Limits
- Streets
- Watercourses
- Waterbodies



EXPIRES: 12-31-2012

### Map Information

Projection: Oregon State Plane North Zone  
 Datum: North American Datum of 1983  
 Date: February 3, 2011  
 Prepared By: GSI Water Solutions, Inc.

### Data Sources

OWRD, ESRI, Oregon Geospatial Data Clearinghouse

### Note

This map was prepared for the purpose of identifying the location of a water right only and it is not intended to provide legal dimensions or location of property ownership lines.



### Scale

0 1,320 2,640

1 inch equals 2640 feet

