

RECEIVED

FEB 16 2011

WATER RESOURCES DEPT
SALEM, OREGON

COBU T-10215
for

Gary West
3671 South Fork Little Butte
Creek Road
Eagle Point, Oregon 97524

Assessor's Map No
362E33-401-403

This map is not a
boundary survey
and is for water
rights only.

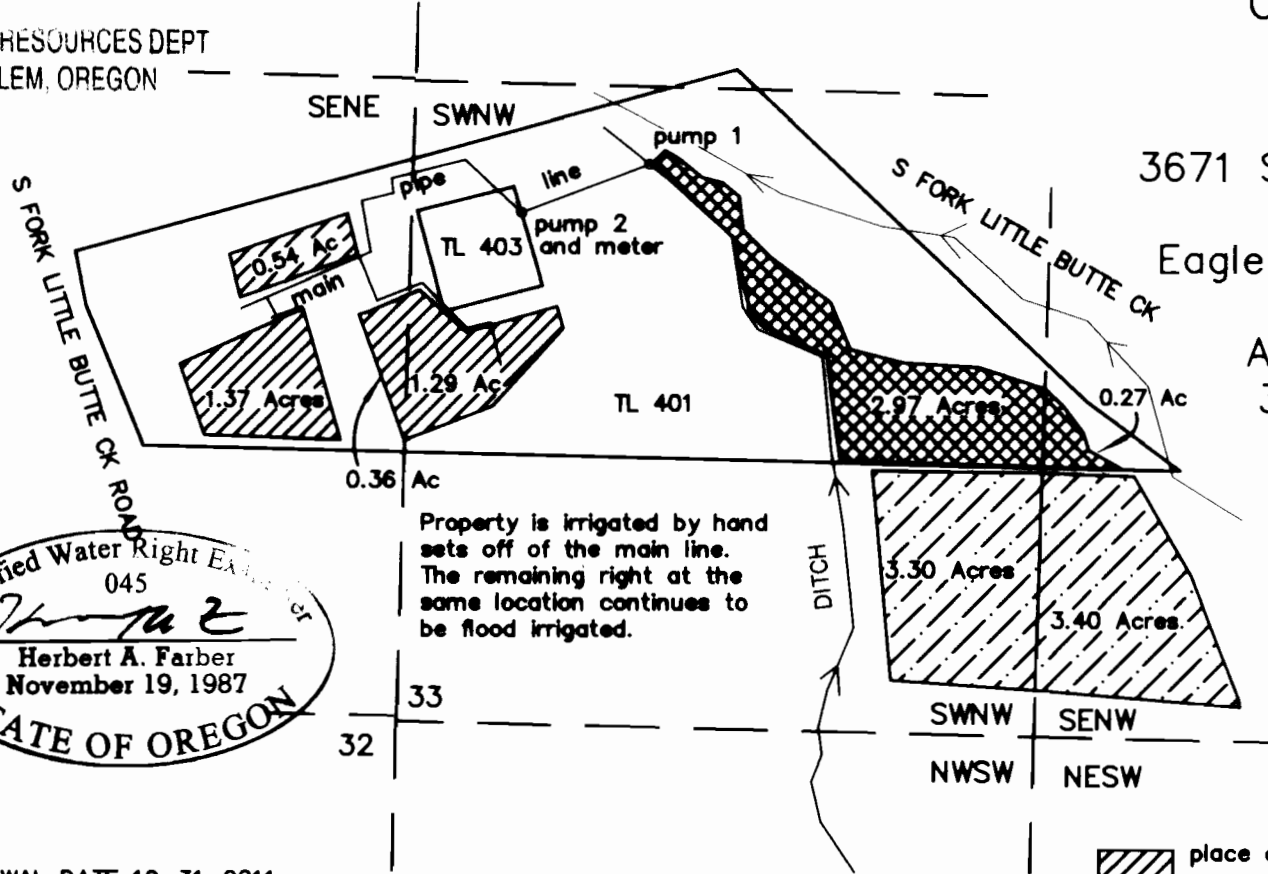

Property is irrigated by hand
sets off of the main line.
The remaining right at the
same location continues to
be flood irrigated.

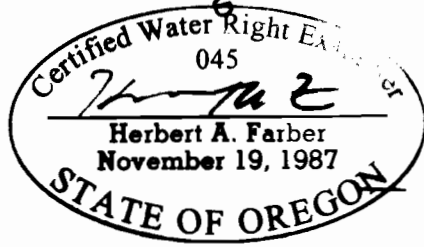

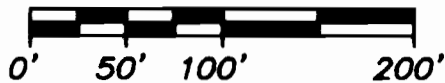

RENEWAL DATE 12-31-2011

SCALE: 1" = 400'



Prepared by:
FARBER & SONS, INC.
dba FARBER SURVEYING
431 Oak Street
Central Point, Oregon 97502
(541) 664-5599

-  place of use transfered, 2.27Ac SENE-32
1.29 Ac SWNW
-  place of use remaining at same location
this transfer 2.97 Ac SWNW, 0.27 Ac SENW
-  CERTIFICATE 83471

DATE: MAY 15, 2010
JOB NO. 1765-11

LITTLE BUTTE\OF LITTLE BUTTE\MICRO\SURVEY\cobu sheet 1.dwg

SHEET 1 OF 2

RECEIVED

MAY 15 2011

WATER RESOURCES DEPT
SALEM, OREGON

COBU T-10215
for



Gary West
3671 South Fork Little Butte
Creek Road
Eagle Point, Oregon 97524

Assessor's Map No
362E33-401-403

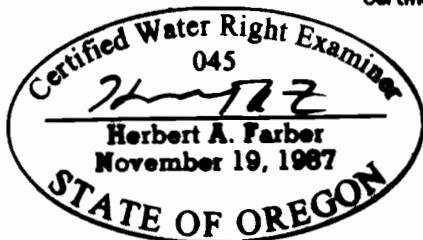
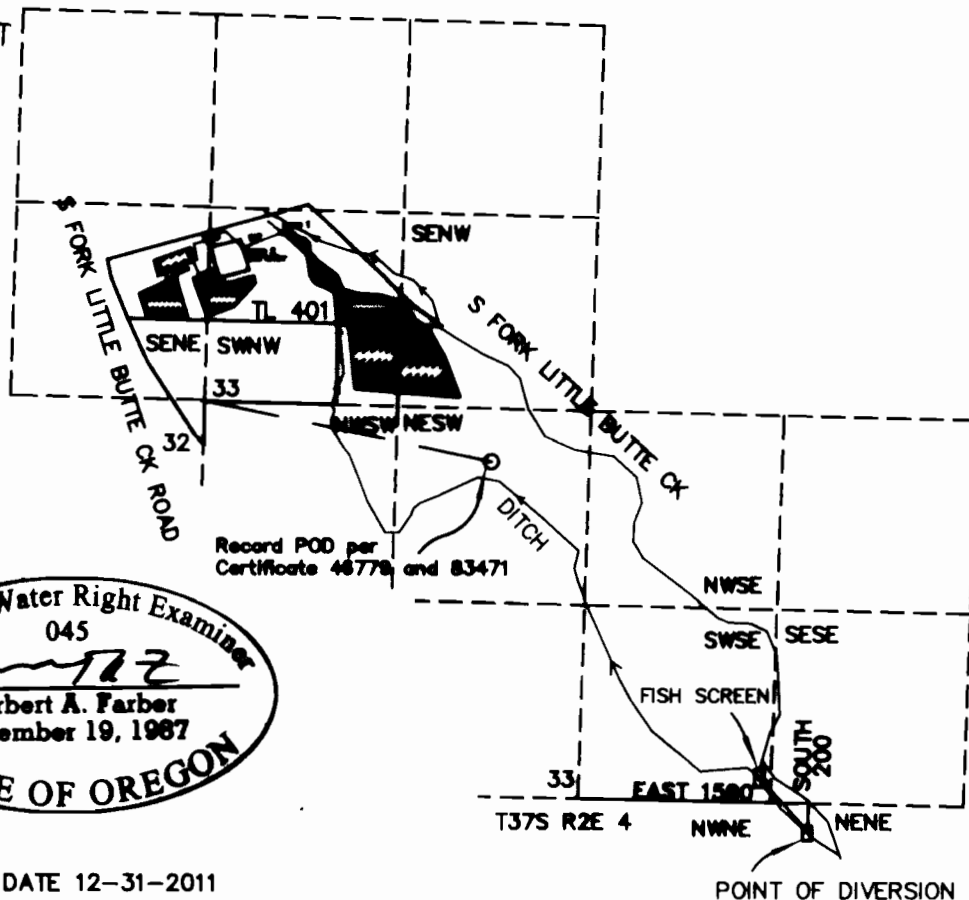
This map is not a
boundary survey
and is for water
rights only.



RENEWAL DATE 12-31-2011

-  place of use transferred, 2.27Ac SENE-32
1.29 Ac SNNW
-  place of use remaining at same location
this transfer 2.97 Ac SNNW, 0.27 Ac SENE
-  CERTIFICATE 83471



SCALE: 1" = 1320'

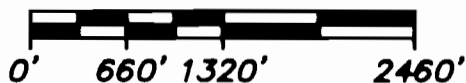

Prepared by:
FARBER & SONS, INC.
dba FARBER SURVEYING
431 Oak Street
Central Point, Oregon 97502
(541) 664-5599

DATE: MAY 15, 2010
JOB NO. 1765-11

SHEET 2 OF 2

LITTLE BUTTE OF LITTLE BUTTE CREEK AND SENE CREEK