

T 6 S, R 1 W, WM
MARION COUNTY

RECEIVED

JUL 21 1998

WATER RESOURCES DEPT.
SALEM, OREGON

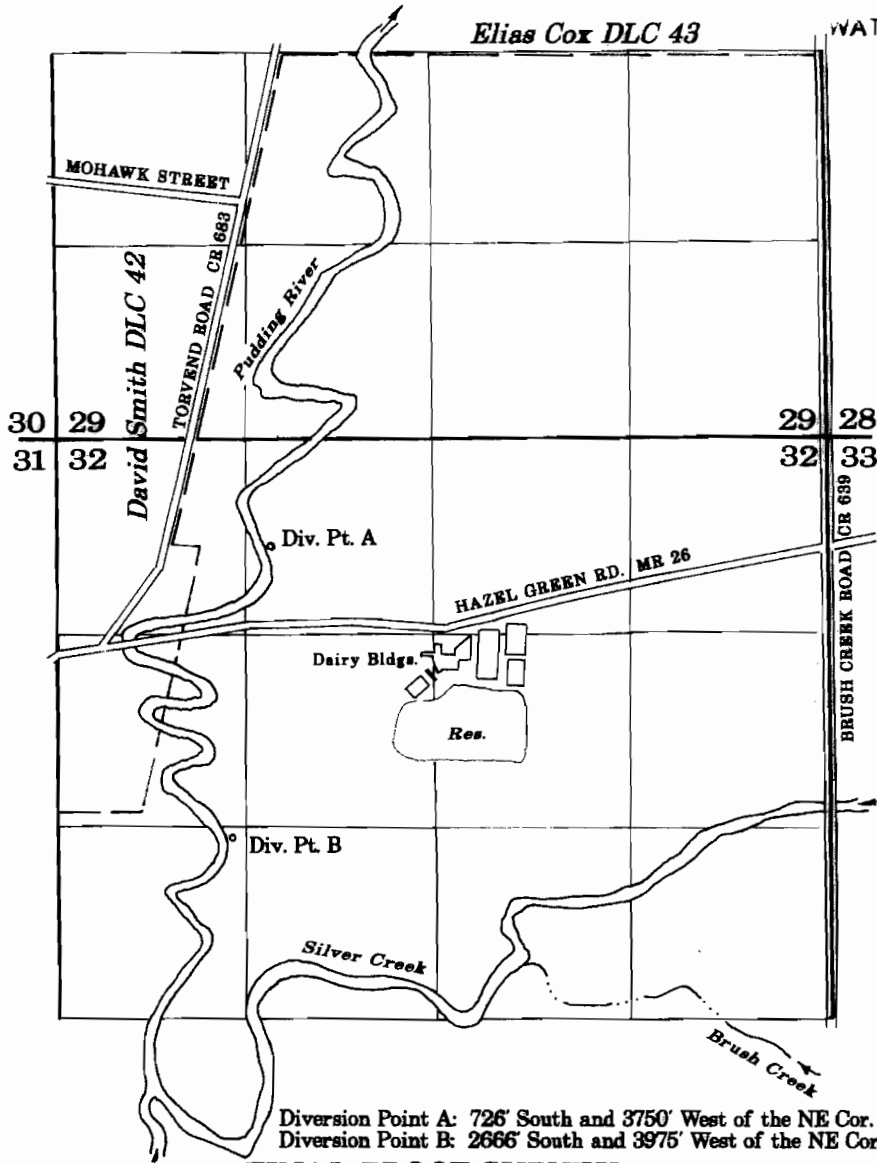

Diversion Point A: 726' South and 3750' West of the NE Cor. Sec 32.
Diversion Point B: 2666' South and 3975' West of the NE Cor. Sec 32.

FINAL PROOF SURVEY
UNDER

Application No.	18849	14483	16661	T-6629
	24801	19930	22683	T-6630
	43004	32129	40027	T-6631
	22552	17759	16974	T-6632
Application No. <u>18808</u>	, Permit No. <u>14448</u>	, Certificate No. <u>14304</u>	, Transfer No. <u>T-6633</u>	

IN THE NAME OF
MALLORIE'S DAIRY, INC.
COW-HOP, INC.

Surveyed July 20, 1998

SCALE: 1" = 1320'

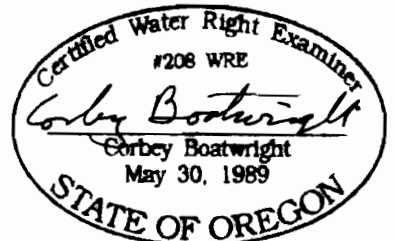

NOTE: This map is for the purpose of identifying the location of water rights and has no intent to dimension or locate property ownership lines.

T-6632

T.6S. R.1W. W.M.
MARION COUNTY

RECEIVED

NOV 22 1995

WATER RESOURCES DEPT.
SALEM, OREGON

- APPLICATION 24801 PERMIT 19930
DIV. PT. A - SE 1/4, SW 1/4, Sec. 29, T6S, R1W, W.M.
- APPLICATION 18808 PERMIT 14448
DIV. PT. B & C - Lot 2 (SW 1/4, NW 1/4) & NW 1/4, SE 1/4, Sec. 32, T6S, R1W, W.M.
- APPLICATION 18849 PERMIT 14483
DIV. PT. C & D NE 1/4, SW 1/4, as proj. on Gideon S. Cox DLC - Sec. 32, T6S, R1W, W.M. & SW 1/4, NW 1/4, Sec. 32
- APPLICATION 22552 PERMIT 17759
DIV. PT. E - NE 1/4, SE 1/4, Sec. 32, T6S, R1W, W.M.
- APPLICATION 43004 PERMIT 32129
DIV. PT. F - 420' S. & 30' E. of NW Cor. S. Cox DLC No. 45, Sec. 33, T6S, R1W, W.M.

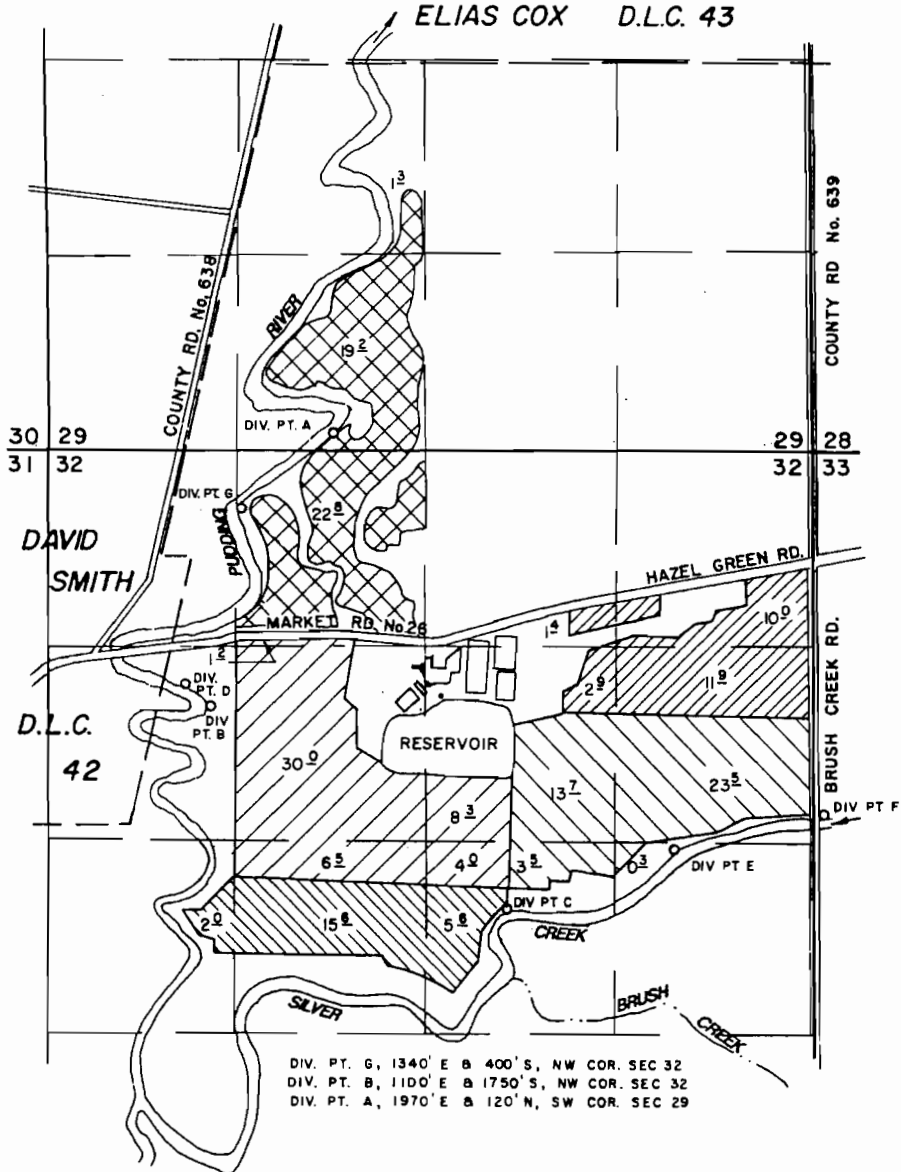

DIV. PT. G, 1340' E & 400' S, NW COR. SEC 32
 DIV. PT. B, 1100' E & 1750' S, NW COR. SEC 32
 DIV. PT. A, 1970' E & 120' N, SW COR. SEC 29

NOTE: This map is for the purpose of identifying the location of water rights and has no intent to dimension or locate property ownership lines.

18808	14448
18849	14483
22552	17759
24801	19930
43004	32129

Application No. _____ Permit No. _____

MALLORIES DAIRY INC.

SEPTEMBER 26, 1991 rev. Sept. 5, 1995
 SCALE 1" = 1320'



APPLICATION TO TRANSFER POINT OF DIVERSION