

QUASI-MUNICIPAL CLAIM OF BENEFICIAL USE MAP

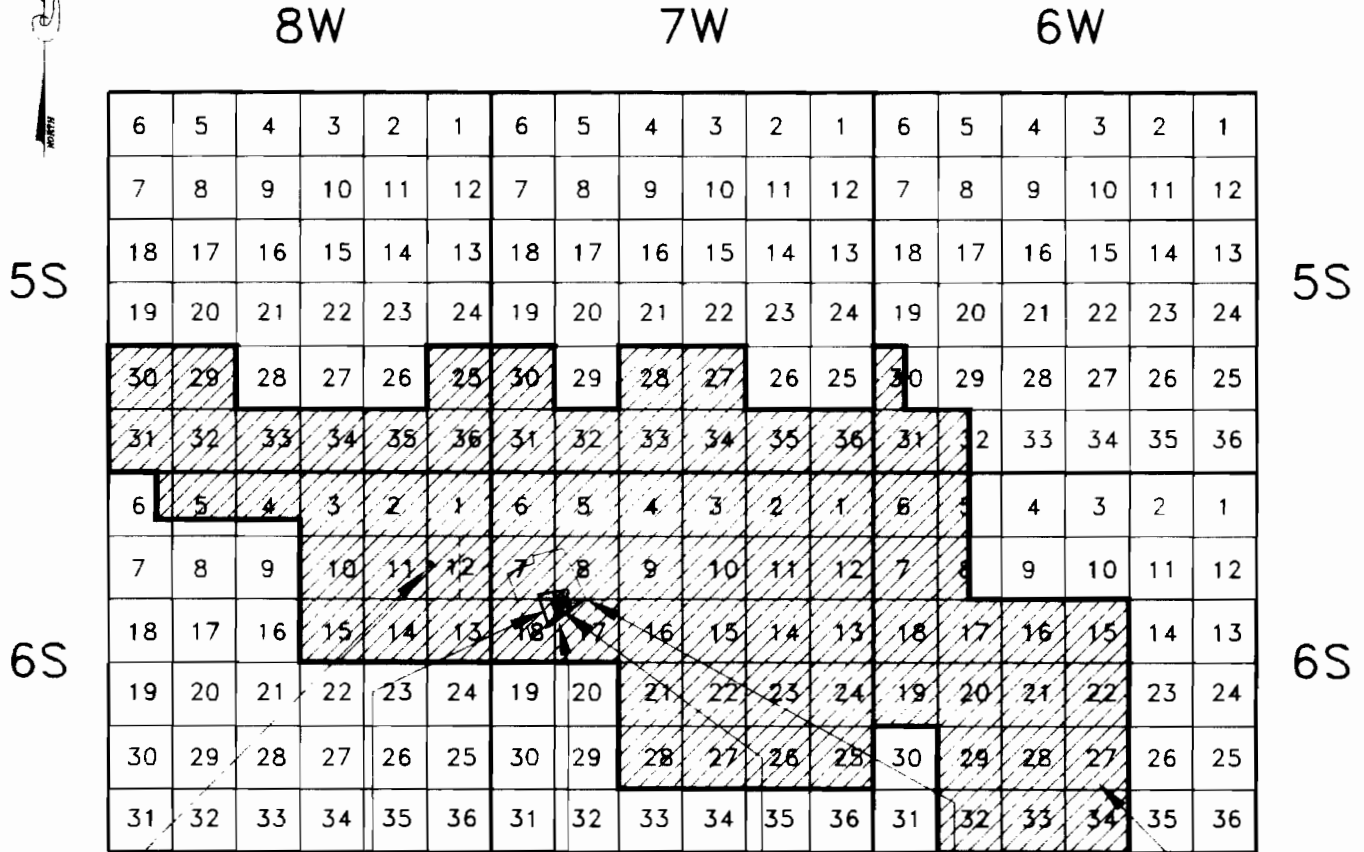

ORIGINAL POINT OF DIVERSION FOR TRANSFER T10028 N85°W 85' FROM WEST 1/4 CORNER SEC. 12, T6S, R8W

8W DIVERSION POINT AND FISH SCREEN S61°42'20"W 2703' FROM SE PLACE OF CORNER DLC 57 USE

7W WATER METER SE COR S76°56'23"W 2554.70' FROM SE CORNER DLC 57 (IN WATER TREATMENT PLANT)

6W SE COR DLC 57 SECONDARY PLACE OF

RECEIVED

SERVICE AREA 47,160 ACRES BASED ON 640 ACRES PER SQUARE MILE WATER RESOURCES DEPT SALEM, OREGON

PERMIT 53832
TRANSFER 10028

Scale: 1" = 16,000'

LEGEND:

- Primary Place of Use
- Secondary Place of Use

NOTE:

This map was prepared for the purposes of identifying the location of the water right only and is not intended to provide legal dimensions or locations of property ownership lines.

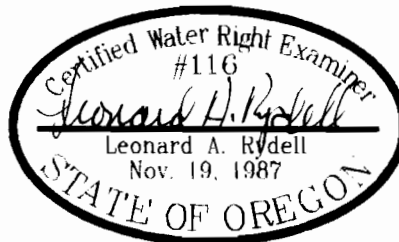

RENEWAL DATE 12/31/2012

Prepared For:

The Confederated Tribes
9615 Grand Ronde Road
Grand Ronde, Oregon 97347

Phone: (503) 879-2404
Fax: (503) 879-2263

Prepared By:

Leonard A. Rydell, W.R.E.
601 Pinehurst Drive
Newberg, Oregon 97132

Phone: (503) 538-5700
Fax: (503) 538-9167