

T37S R6W Sec 7

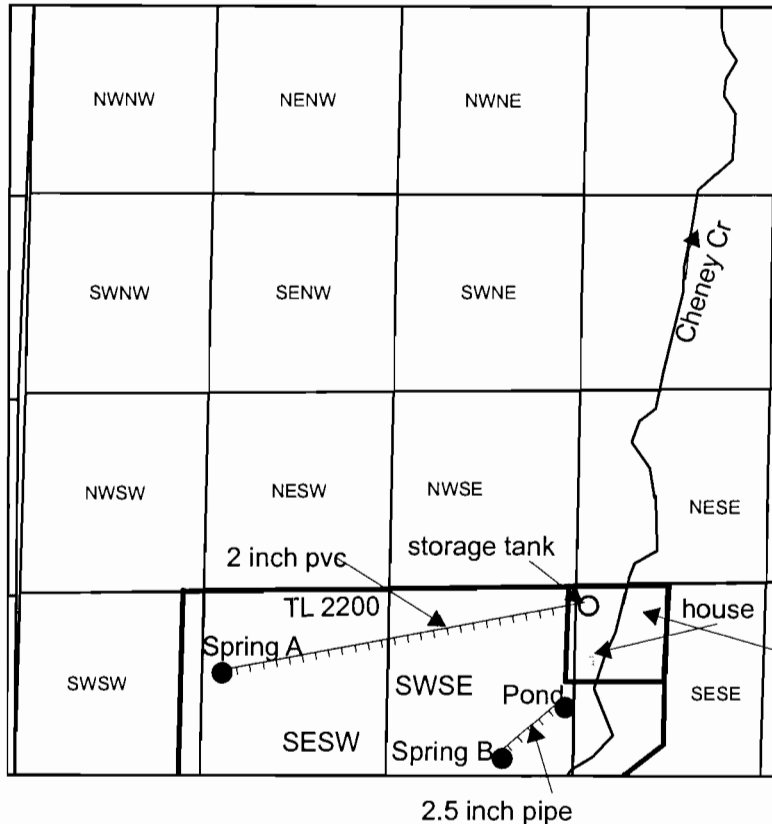

Spring A is 1915 ft south and 1410 ft east from the west corner of Sec 7

RECEIVED

OCT 31 2011

WATER RESOURCES DEPT
SALEM, OREGON

TL 1902

Spring B is 50 ft north and 1895 ft west from the SE corner Sec 7

1 inch = 1,320 feet

The pond is 468 ft north and 1488 ft west from the SE corner Sec 7

FINAL PROOF SURVEY UNDER

Application No. 69061 Permit No. 50090

IN NAME OF
Joseph J. McAleavey