

40 ^{AC} ^{1/4} ^{1/4}
T49S R9W

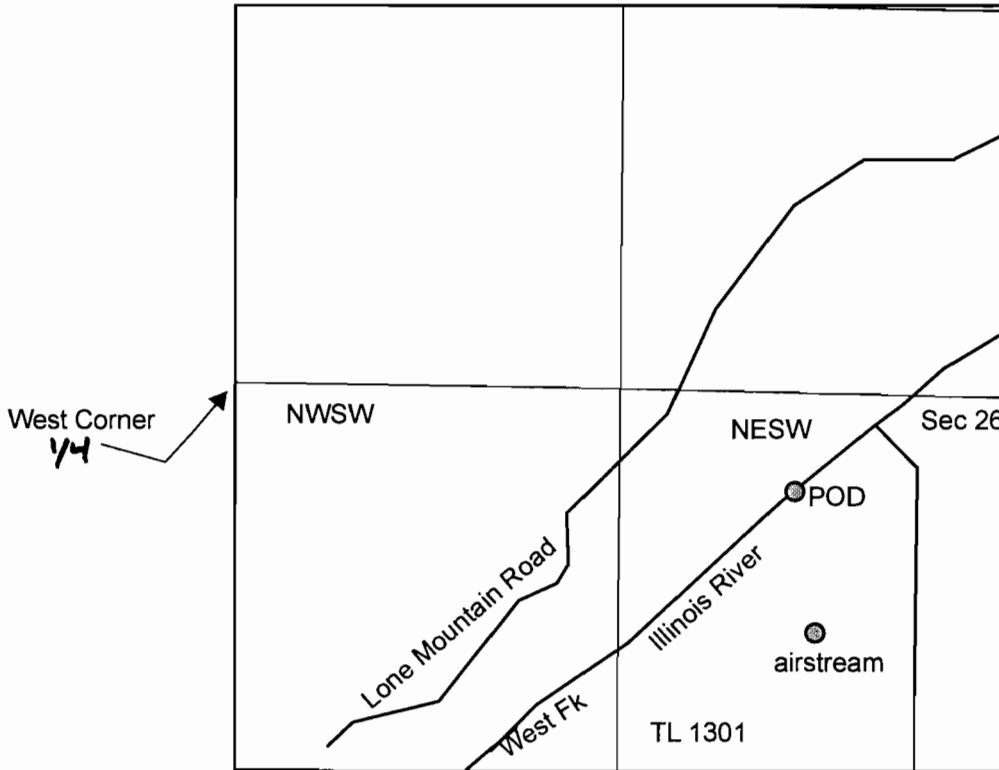

The POD is located 1932 ft east and 316 ft south from the west ^{1/4} corner of Sec 26

1 inch = 660 feet

FINAL PROOF SURVEY

UNDER

Application No. 68565 Permit No. 49683

IN NAME OF

Jane E. Solofra

RECEIVED

AUG 29 2011

WATER RESOURCES DEPT
SALEM, OREGON

K Smith August 23, 2011