

T.4S., R.1W., W.M.

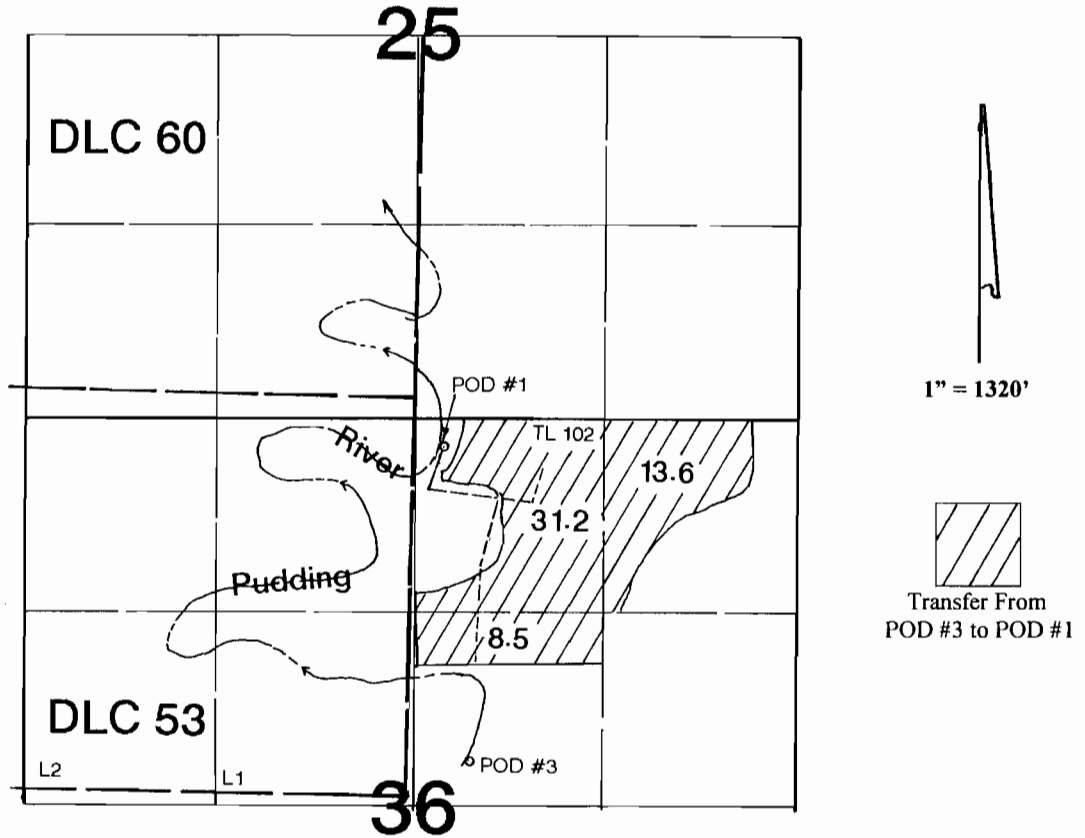

POD #1 is located 210' S & 190' E from the N1/4 corner of Section 36. (NE1/4-SE1/4, Sec. 36)
POD #3 is located in SW1/4-NE1/4 of Section 36.

Application Map

Historical Change in Point of Diversion

Eric & Lynda Strom

Transfer #:

RECEIVED

APR 28 2011

WATER RESOURCES DEPT
SALEM, OREGON

This Map was Prepared for the Purpose of Identifying the Location of a Water Right Only and is Not Intended to Provide Legal Dimensions or Location of Property Ownership Lines.

T 11237

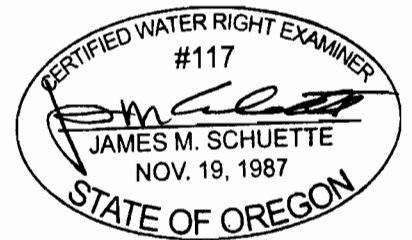

EXPIRES: 6/30/2012