

# Claim of Beneficial Use - Place of Use Map

Permit No. S31293, Application No. S41805

Townships 40 & 41 South, Ranges 13 & 14 West (W.M.)

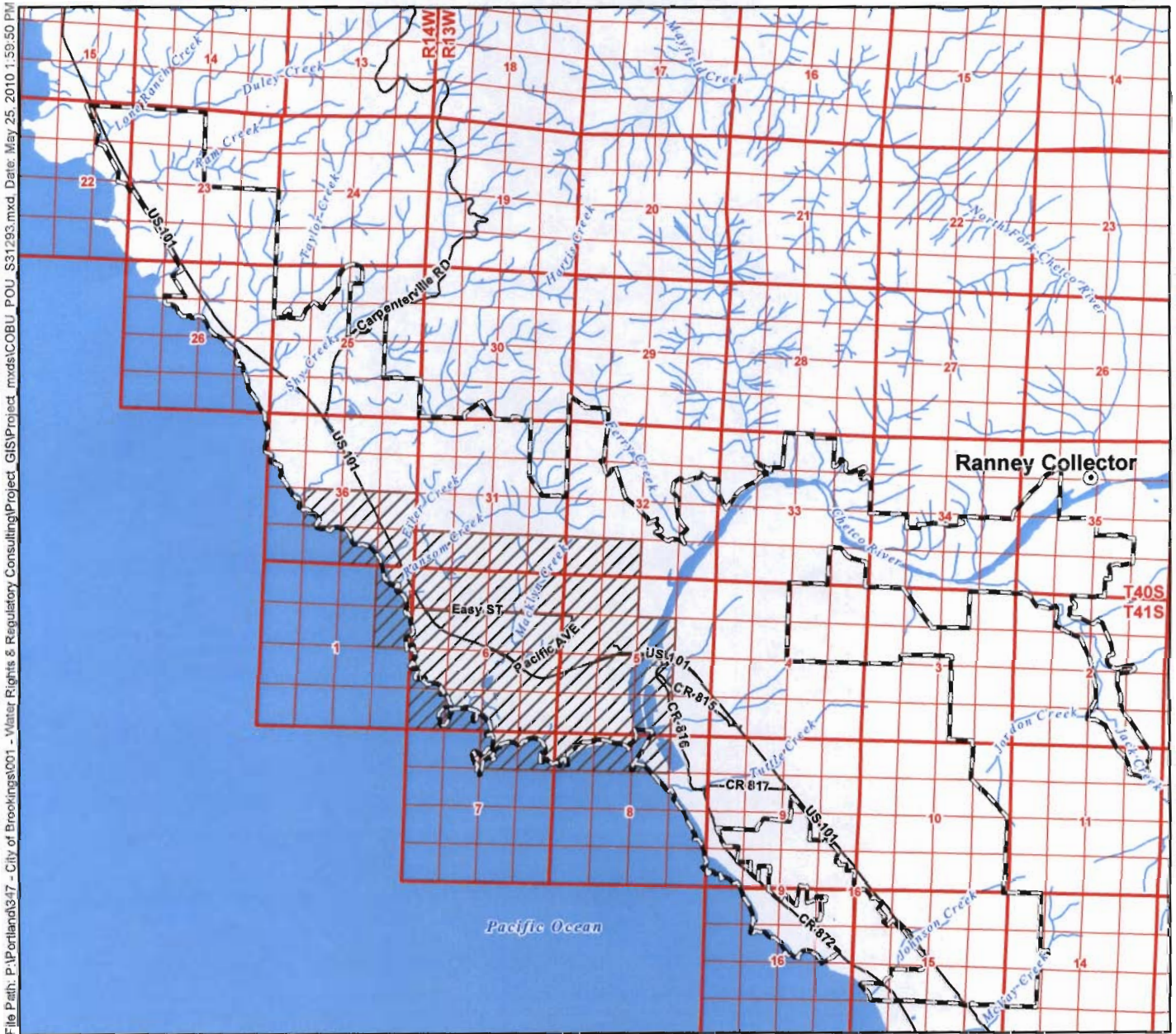

File Path: P:\Portland\347 - City of Brookings\001 - Water Rights & Regulatory Consulting\Project\_GIS\Project\_mxd\COBU\_POU\_S31293.mxd, Date: May 25, 2010 1:59:50 PM

## Legend

- Point of Diversion (POD)
- ▨ Place of Use (POU)
- ⊕ City Service Area
- Major Roads
- ~ Watercourses
- Waterbodies

## Certified Water Rights Examiner Stamp

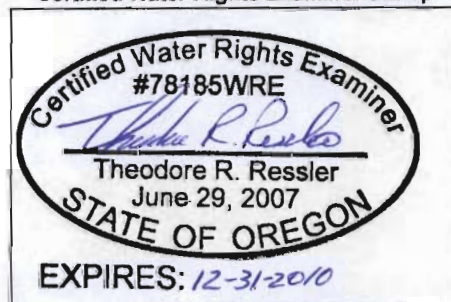

## Map Information

Projection: Oregon State Plane South Zone  
 Datum: North American Datum of 1983  
 Date: May 25, 2010  
 Prepared By: GSI Water Solutions, Inc.

## Data Sources

OWRD, Oregon Geospatial Data Clearinghouse

## Disclaimer

This map was prepared for the purpose of identifying the location of a water right only and it is not intended to provide legal dimensions or location of property ownership lines.

RECEIVED  
 JUL 16 2010  
 WATER RESOURCES DEPT  
 SALEM, OREGON

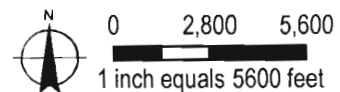

# Claim of Beneficial Use - Point of Diversion Map

Permit No. S31293, Application No. S41805  
 Township 40 South, Range 13 West (W.M.)

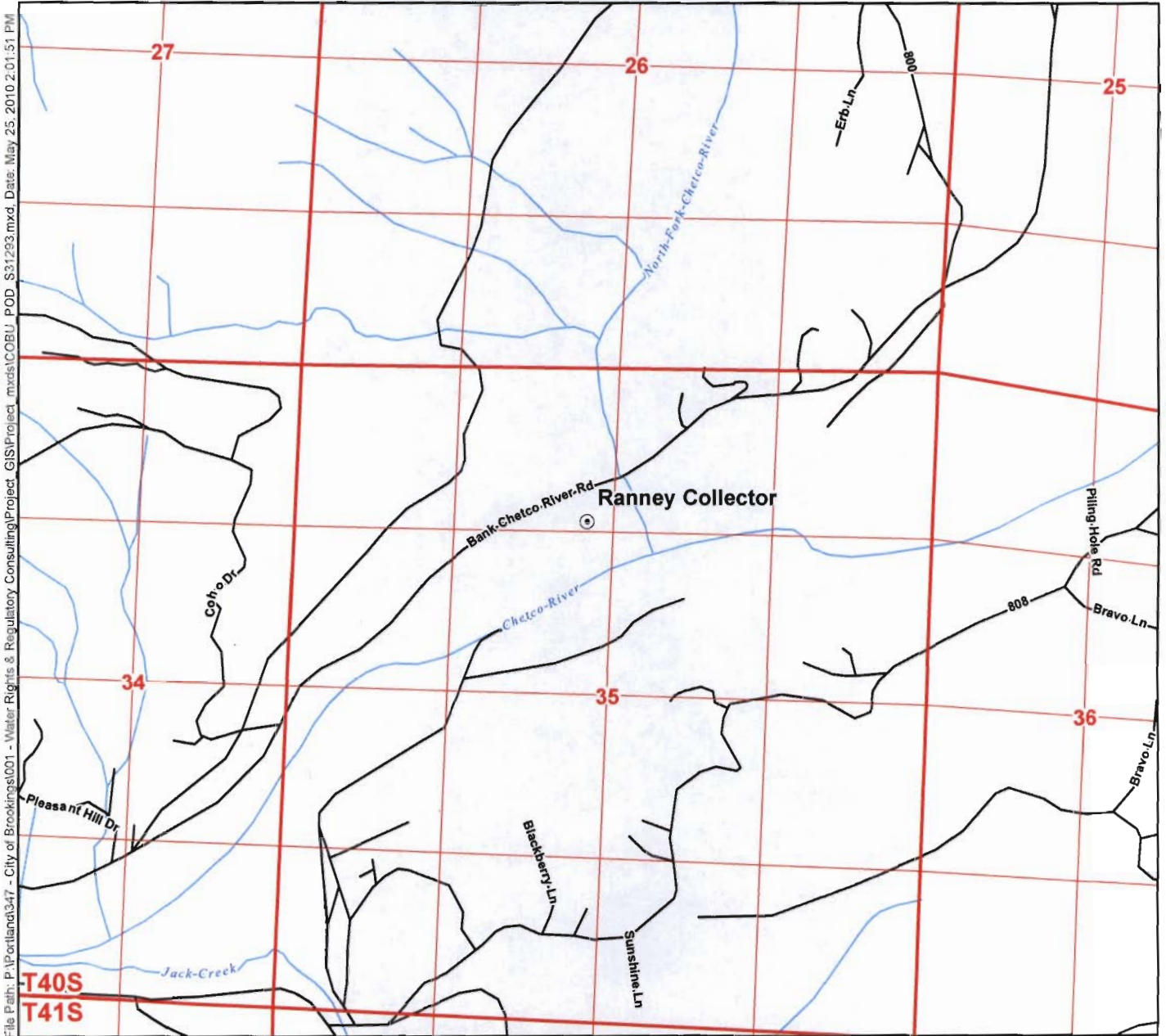

File Path: P:\Portland\347 - City of Brookings\001 - Water Rights & Regulatory Consulting\Project\_GIS\Project\_mxd\COBU\_POD\_S31293.mxd, Date: May 25, 2010 2:01:51 PM

## Legend

- ⊙ Point of Diversion (POD)
- Streets
- ~ Watercourses

## Certified Water Rights Examiner Stamp

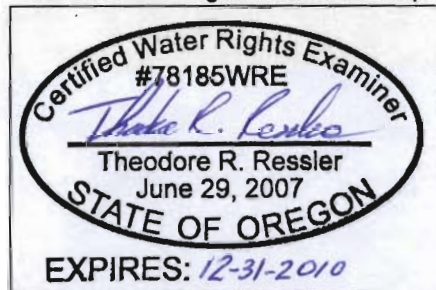

## Map Information

Projection: Oregon State Plane South Zone  
 Datum: North American Datum of 1983  
 Date: May 25, 2010  
 Prepared By: GSI Water Solutions, Inc.

## Data Sources

OWRD, Oregon Geospatial Data Clearinghouse

## Disclaimer

This map was prepared for the purpose of identifying the location of a water right only and it is not intended to provide legal dimensions or location of property ownership lines.

## POD Legal Description

**Ranney Collector**  
 Located 1,290 feet South and 2,415 feet East from the NW corner of Section 35, Township 40 South, Range 13 West (W.M.)

RECEIVED

JUL 16 2010

WATER RESOURCES DEPT  
 SALEM, OREGON



0 660 1,320  
 1 inch equals 1320 feet

