

Claim of Beneficial Use Point of Re-Diversion Map

Permit S-53445 (Application S-80641)

Township 36 South, Range 1 and 2 West (W.M.)

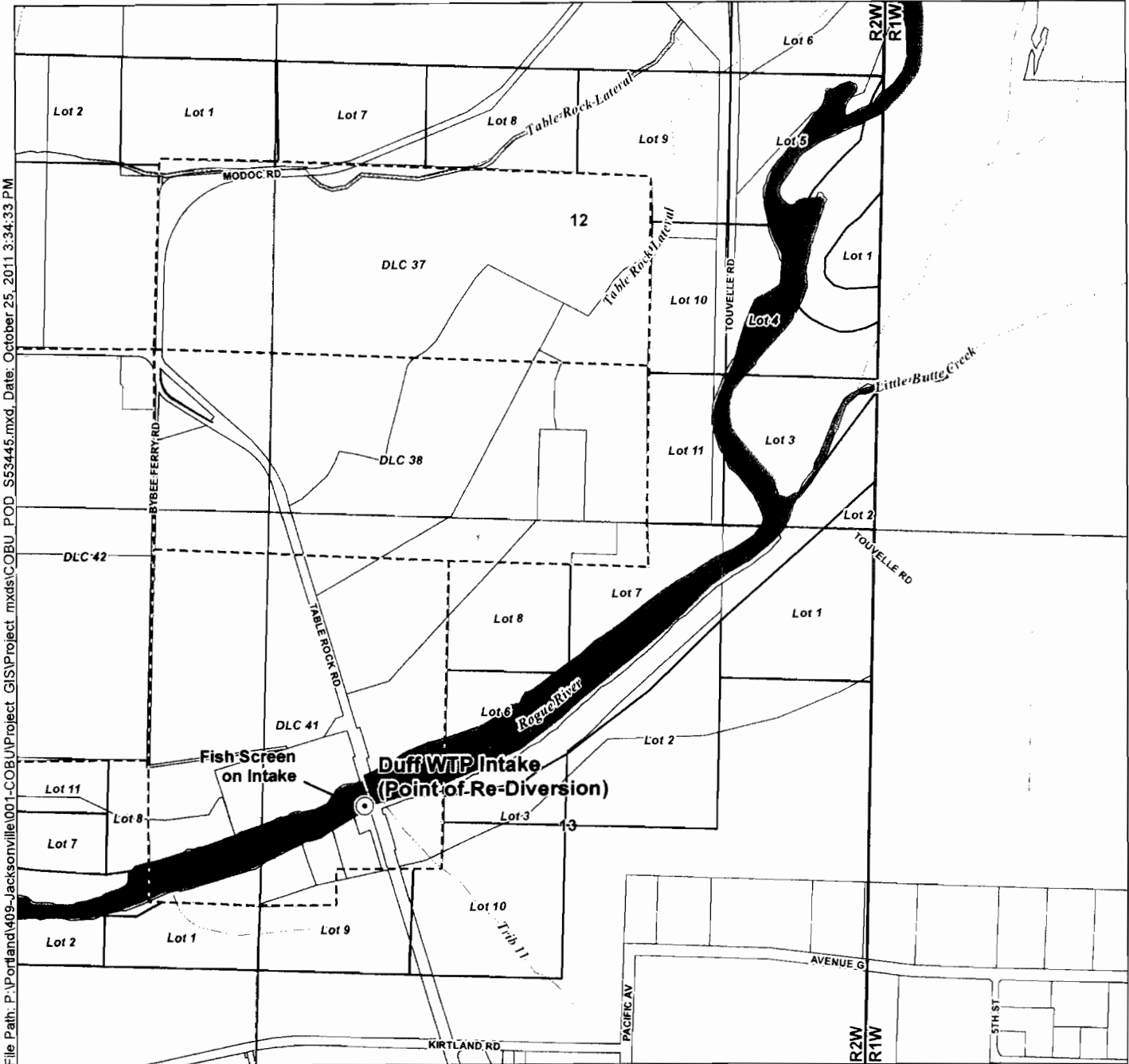

File Path: P:\Portland\409-Jacksonville\001-COBU\Project_GIS\Project_mxd\COBU_POD_S53445.mxd, Date: October 25, 2011 3:34:33 PM

- Legend**
- Point of Re-Diversion (POD)
 - Donation Land Claims (DLCs)
 - Government Lots
 - Taxlots
 - Watercourses
 - Waterbodies

POD Location Description
Duff WTP Intake
 Located South 25°25'28" East, 4,385.6 feet from the NE corner of Donation Land Claim 42 (W.M.)

Certified Water Rights Examiner Stamp

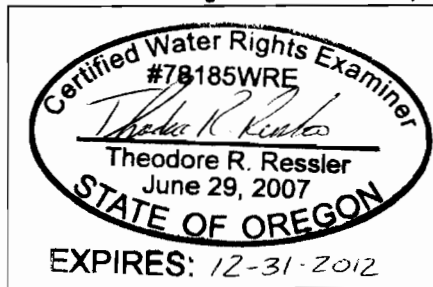



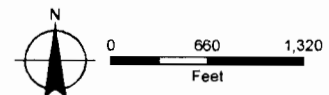

Disclaimer
 This map was prepared for the purpose of identifying the location of a water right only and it is not intended to provide legal dimensions or location of property ownership lines.

Map Notes
 Date: October 25, 2011
 Data Sources: Jackson County GIS, OWRD
 Prepared By: GSI Water Solutions, Inc.



**Claim of Beneficial Use
Place of Use Map**
Permit S-53445 (Application S-80641)
Township 37 South, Range 2 West (W.M.)

- LEGEND**
-  Place of Use (POU)
 -  Taxlots
 -  Jacksonville City Limit
 -  Watercourses
 -  Waterbodies

RECEIVED

AUG 24 2011

WATER RESOURCES DEPT
SALEM, OREGON

Place of Use Description
"Within the service boundaries of the City"

Certified Water Rights Examiner Stamp

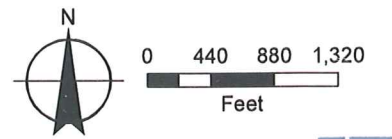

MAP NOTES:
Date: July 11, 2011
Data Sources: Jackson County GIS, OWRD

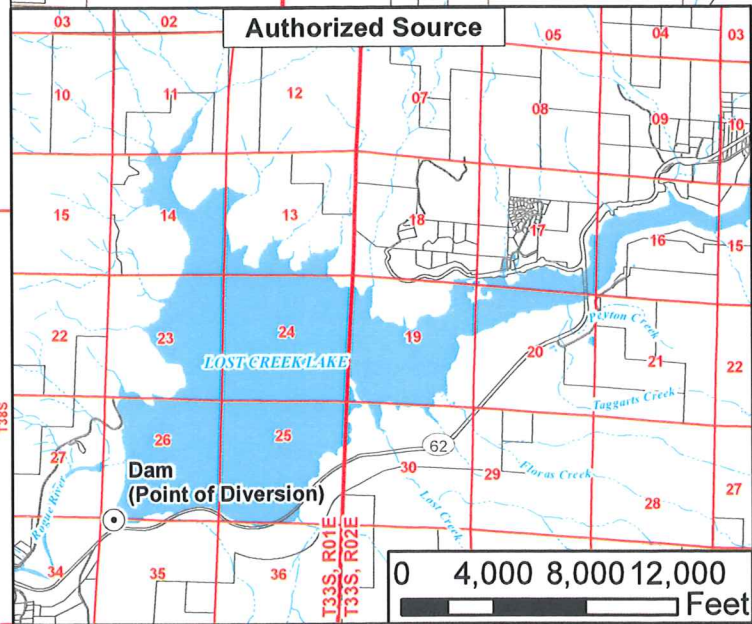
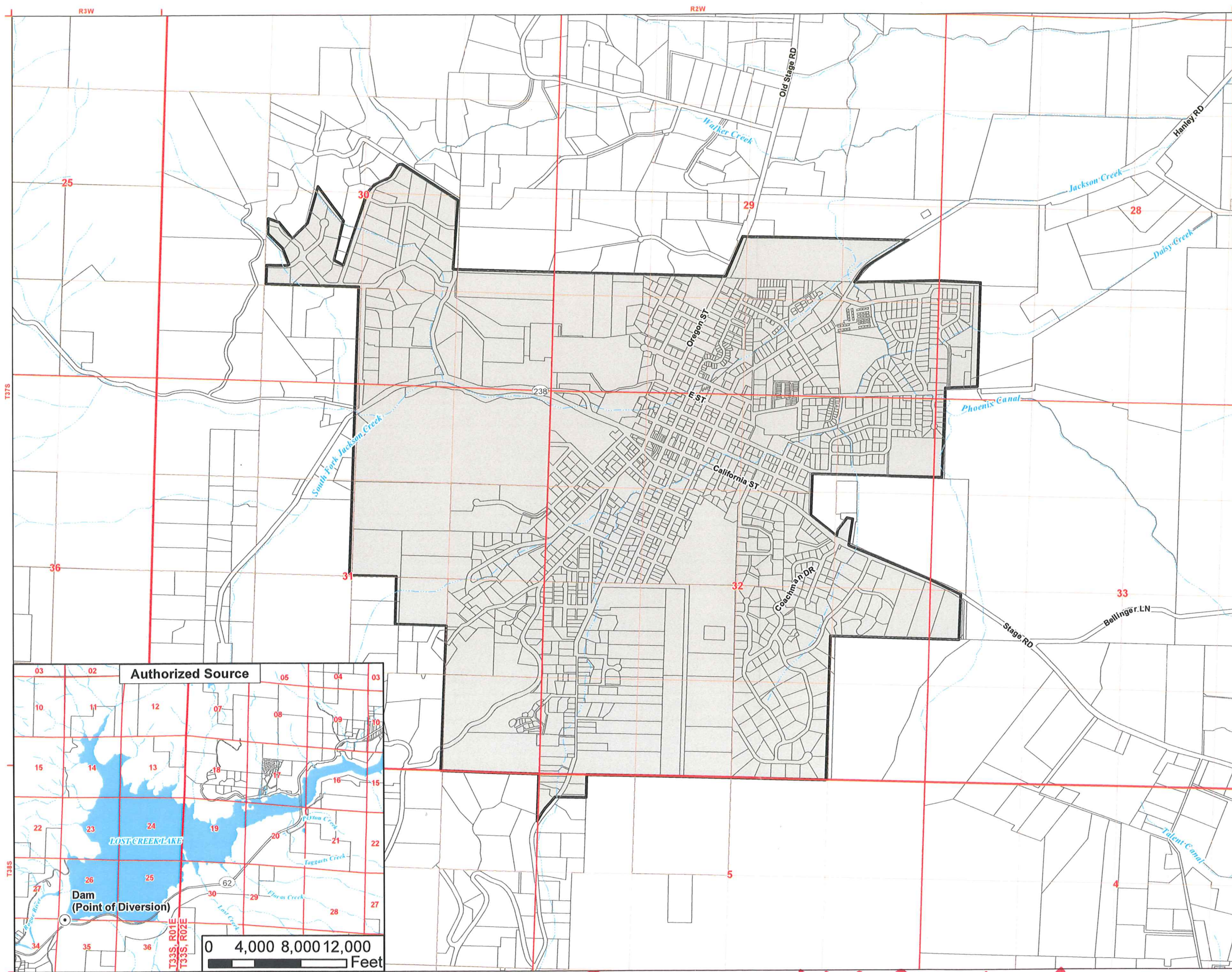

COBU MAP 0606