

4

FINAL PROOF SURVEY
 FOR
 HARRY G. SPENCER
 TRANSFER 6454
 TOWNSHIP 30 SOUTH, RANGE 15 WEST, W.M.
 SECTIONS 13 & 14

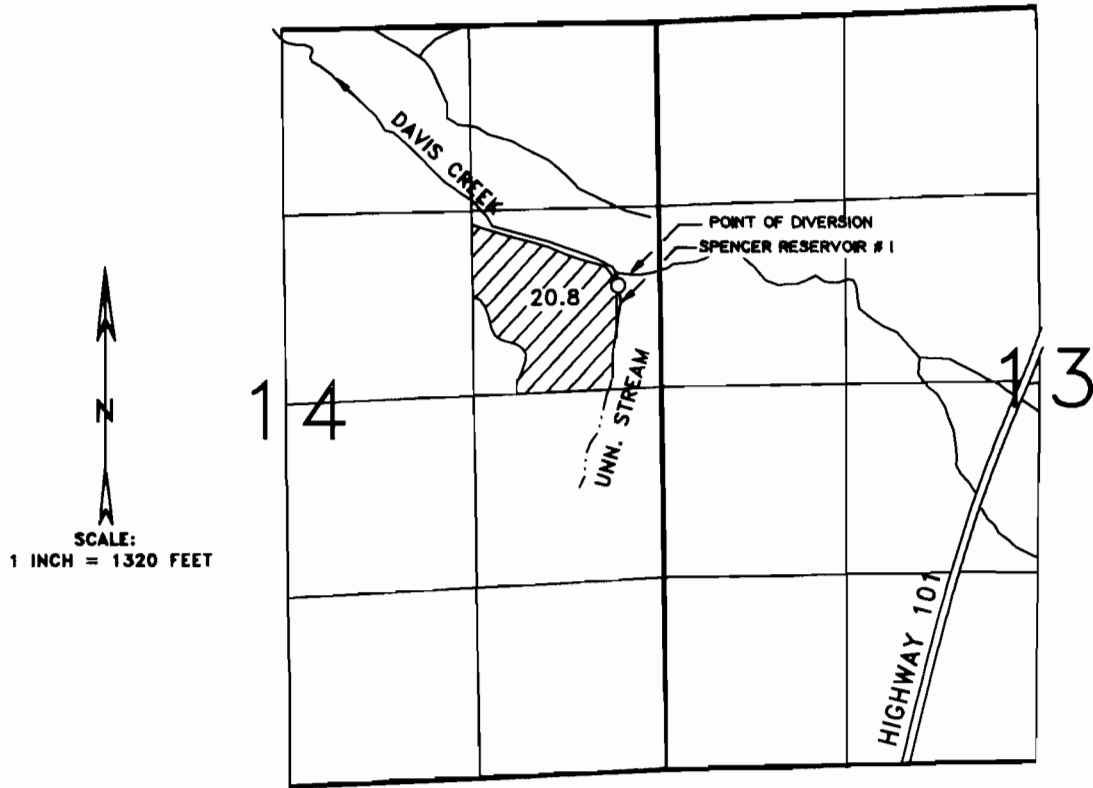

THE POINT OF DIVERSION IS LOCATED 1810 FEET SOUTH AND 300 FEET WEST FROM THE NORTHEAST CORNER OF SECTION 14, BEING WITHIN THE SE $\frac{1}{4}$ OF THE NE $\frac{1}{4}$ OF SECTION 14, TOWNSHIP 30 SOUTH, RANGE 15 WEST, W.M., COOS COUNTY.

THE PURPOSE OF THIS MAP IS TO IDENTIFY THE LOCATION OF THE WATER RIGHT. IT IS NOT INTENDED TO PROVIDE INFORMATION RELATIVE TO THE LOCATION OF PROPERTY OWNERSHIP BOUNDARY LINES.

