

4/11 - 2 1975

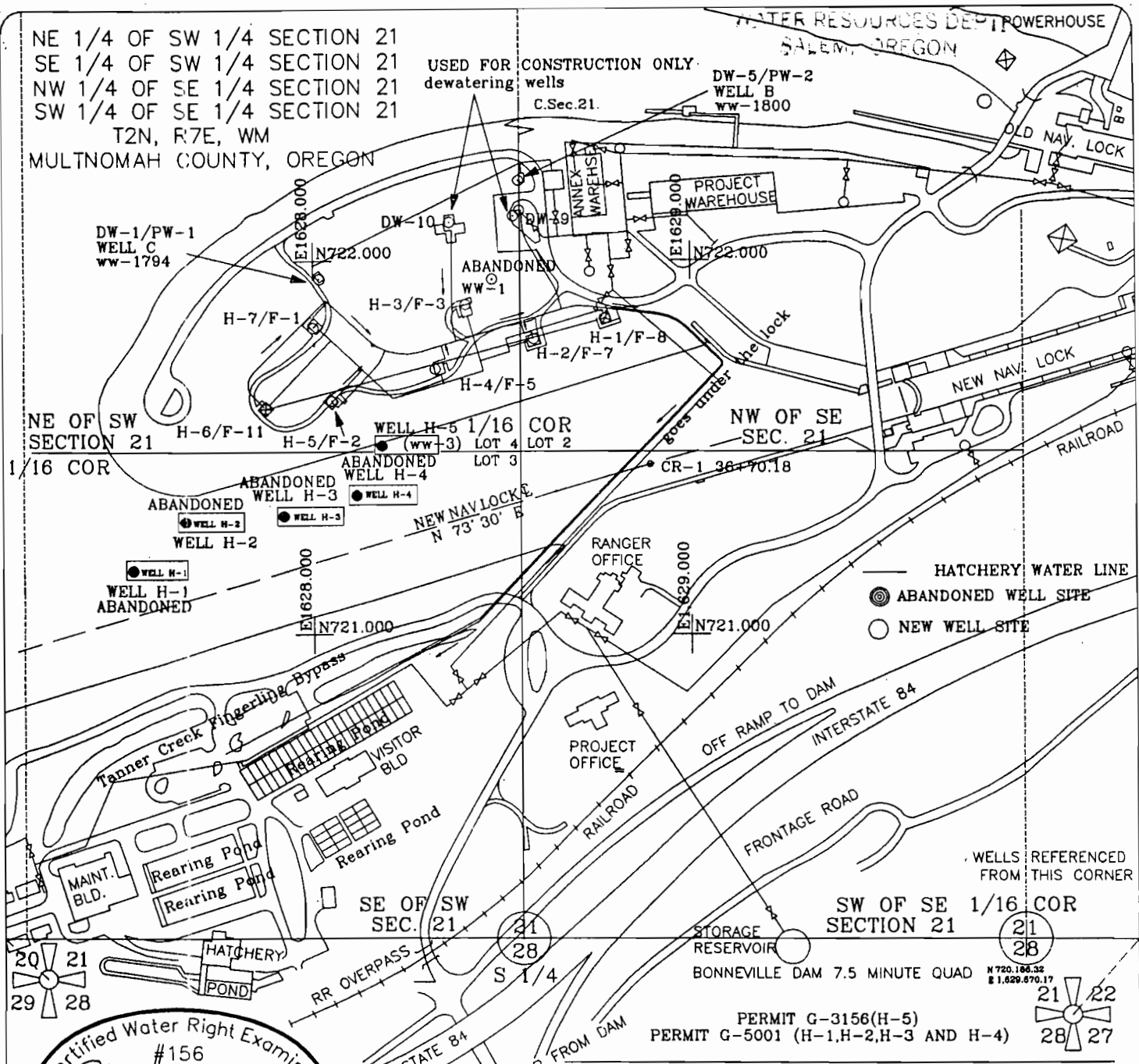

Certified Water Right Examiner
 #156
Edward A. Crane
 Edward A. Crane
 May 17, 1988
 STATE OF OREGON

Renewal 12/31/95 Signed 5/31/95
 SURVEYED MAY 25, 1995
 BY EDWARD A. CRANE, CWRE

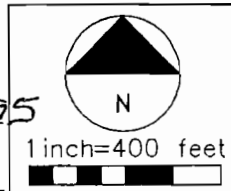

PREPARATION OF THIS MAP WAS FOR THE PURPOSE OF IDENTIFYING THE LOCATION OF THE WATER RIGHTS ONLY AND HAS NO INTENT TO PROVIDE DIMENSIONS OR LOCATION OF PROPERTY OWNERSHIP LINES.

GROUNDWATER PERMIT G-3156
FINAL WATER PROOF SURVEY MAP
 PREPARED BY EDWARD A. CRANE, CWRE

DATE
 MAY 1995

PROJECT NO.
 151 002

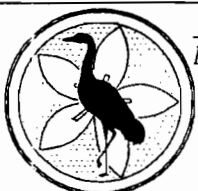

CRANE & MERSETH
 Engineering/Surveying

SUITE 604
 12042 SE SUNNYSIDE ROAD
 CLACKAMAS, OREGON 97015

BUS: (503) 698-7575
 FAX: (503) 698-7747

APPLICATION FOR PERMIT NUMBER _____

PERMIT NUMBER G-3156 IN THE NAME OF:

US DEPT. ARMY, CORPS OF ENGINEERS
 BONNEVILLE DAM - DOMESTIC USE
 CASCADE LOCKS, OREGON 97014

FIGURE
 1/2

NE 1/4 OF SW 1/4 SECTION 21
 SE 1/4 OF SW 1/4 SECTION 21
 NW 1/4 OF SE 1/4 SECTION 21
 SW 1/4 OF SE 1/4 SECTION 21
 T2N, R7E, WM
 MULTNOMAH COUNTY, OREGON

LEGEND:

TRANSFER APPL. T-6619 QUANTITY AND DIVERSION POINTS OF EXISTING HATCHERY WELLS, H-1, H-2, H-3 & H-4 WERE TRANSFERRED TO FISHERY WELLS F-1, F-2, F-3, F-5, F-7 & F-8 F-11 WELL WAS ADDED TO PERMIT G-5001 LATER DEWATERING WELLS DW- WELLS WERE USED DURING CONSTRUCTION THE F WELLS ARE IN THE SAME ACQUIFIR AS THE OLD H WELLS

TRANSFER APPL. T-6618 QUANTITY AND DIVERSION POINT OF WELL WW-3 = H-5 WAS TRANSFERRED TO WW-1800 & WW-1794 (WELL B & C WERE HATCHERY WELLS, SEE LEFT FOR NEW NAMES (THEY ARE NOW DOMESTIC USE WELLS)

TOTAL CFS USE WILL BE THE SAME, AND THE NEW WELLS ARE IN THE SAME ACQUIFER.

ORIGINAL COE MAP WAS COMPILED FROM COE BDF-7-14/3 AND BDG-9-0-0/DW. ORIGINAL COE COORDINATES ARE LAMBERT STATE PLANE COORDINATES, OREGON NORTH ZONE

U./S. ARMY ENGINEER DISTRICT, PORTLAND
BONNEVILLE NEW NAV. LOCK
 COLUMBIA RIVER OREGON-WASHINGTON
 FISH HATCHERY WELLS
**PIPING SCHEMATIC, AND
 WATER WELL LOCATIONS**

TRANSFER APPLICATION T-6618 DOMESTIC USE
 TRANSFER APPLICATION T-6619 HATCHERY USE
 COE FILE USR/LIEBN1.WELL.DGN
 ORIGINALLY DRAWN: L.HOEKSTRA, COE
 TRANSFER APPLICATION DATE: JUNE 1991

T-6618 G-3156 DOMESTIC WELL NO.	T-6619 G-5001 HATCHERY WELL NO.	Distance North OF 1/16C.21/28	Distance West OF 1/16C.21/28	1/16 COR 21/28 TO WELL		
				AZIMUTH	DISTANCE	BEARING
	H-7/F-1	1636'	1870'	311° 11'	2484'	N48°50'35"W
	H-5/F-2	1441'	1822'	308° 20'	2323'	N51°39'14"W
	H-3/F-3	1695'	1468'	319° 08'	2242'	N40°53'05"W
	H-4/F-5	1527'	1549'	314° 03'	2175'	N45°26'20"W
	H-2/F-7	1605'	1286'	321° 02'	2056'	N38°41'36"W
	H-1/F-8	1658'	1094'	326° 35'	2053'	N33°24'47"W
	H-6/F-11	1421'	1994'	305° 28'	2449'	N54D31'10"W
WW-1800		2027'	1324'	326° 08'	2421'	N33°08'09"W
WW-1794		1767'	1853'*	313° 03'	2560'	N46°23'13"W
ABANDONED	WW-1	1764	1396'	321-39'	2249'	ABANDONED
ABANDONED	H-1	985	2347	292-47	2545	ABANDONED
ABANDONED	H-2	1114	2205	296-49'	2471	ABANDONED
ABANDONED	H-3	1130	1947	300-12'	2247	ABANDONED
ABANDONED	H-4	1185	1757	304-08'	2119	ABANDONED
ABANDONED	H-5	1320	1690	307-59'	2144	ABANDONED

* CHANGED FROM TRANSFER APPLICATION

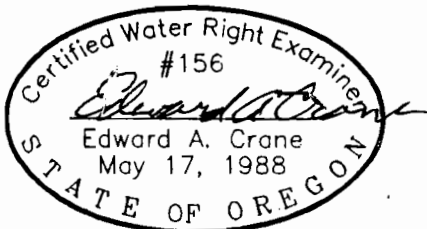

Renewal 12/31/95
 Signed *Edward A. Crane*

SURVEYED MAY 25, 1995
 BY EDWARD A. CRANE, CWRE

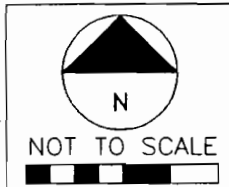

PREPARATION OF THIS MAP WAS FOR THE PURPOSE OF IDENTIFYING THE LOCATION OF THE WATER RIGHTS ONLY AND HAS NO INTENT TO PROVIDE DIMENSIONS OR LOCATION OF PROPERTY OWNERSHIP LINES.

**GROUNDWATER PERMIT G-3156
 FINAL WATER PROOF SURVEY MAP**
 PREPARED BY EDWARD A. CRANE, CWRE

DATE MAY 1995	CRANE & MERSETH <i>Engineering/Surveying</i> SUITE 604 12042 SE SUNNYSIDE ROAD CLACKAMAS, OREGON 97015 BUS: (503) 698-7575 FAX: (503) 698-7747	APPLICATION FOR PERMIT NUMBER _____	FIGURE 2/2
PROJECT NO. 151 002		PERMIT NUMBER <u>G-3156</u> IN THE NAME OF: US DEPT. ARMY, CORPS OF ENGINEERS BONNEVILLE DAM - DOMESTIC USE CASCADE LOCKS, OREGON 97014	