

T. 10S., R. 2W., W.M.

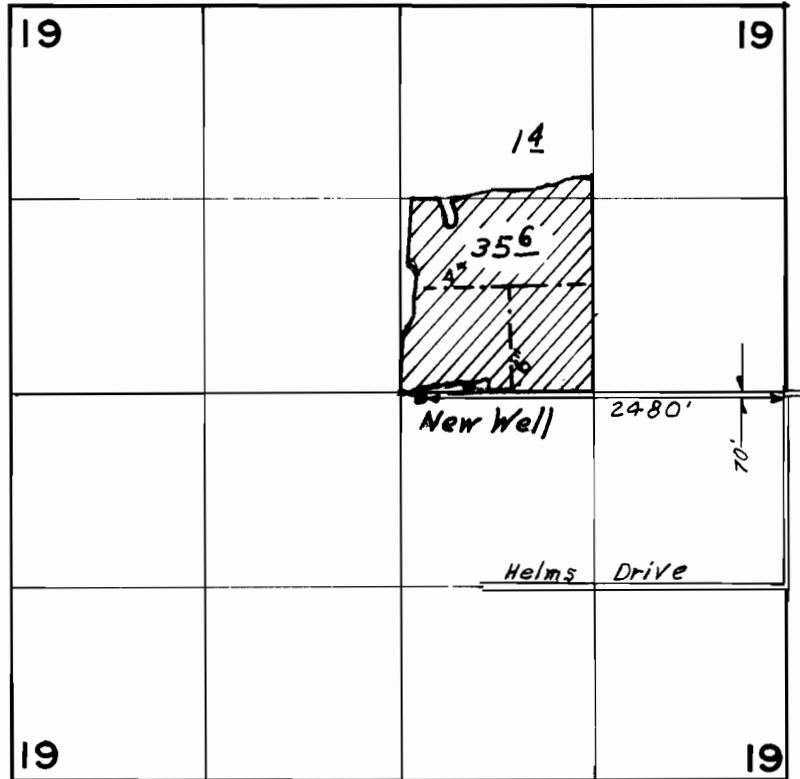

FINAL PROOF SURVEY
UNDER

Transfer No. T-7399

Application No. _____ Permit No. _____
IN NAME OF

HELMS BROS. FARM S., INC.

Surveyed June 23 1997, by

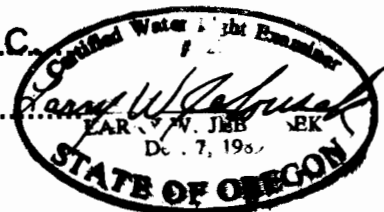

THIS MAP WAS PREPARED FOR THE PURPOSE OF IDENTIFYING THE LOCATION OF A WATER RIGHT ONLY AND IS NOT INTENDED TO PROVIDE LEGAL DIMENSIONS OR LOCATION OF PROPERTY OWNERSHIP LINES.

WAC-ODFW-93 6-91