

T.5S., R.5W., W.M.

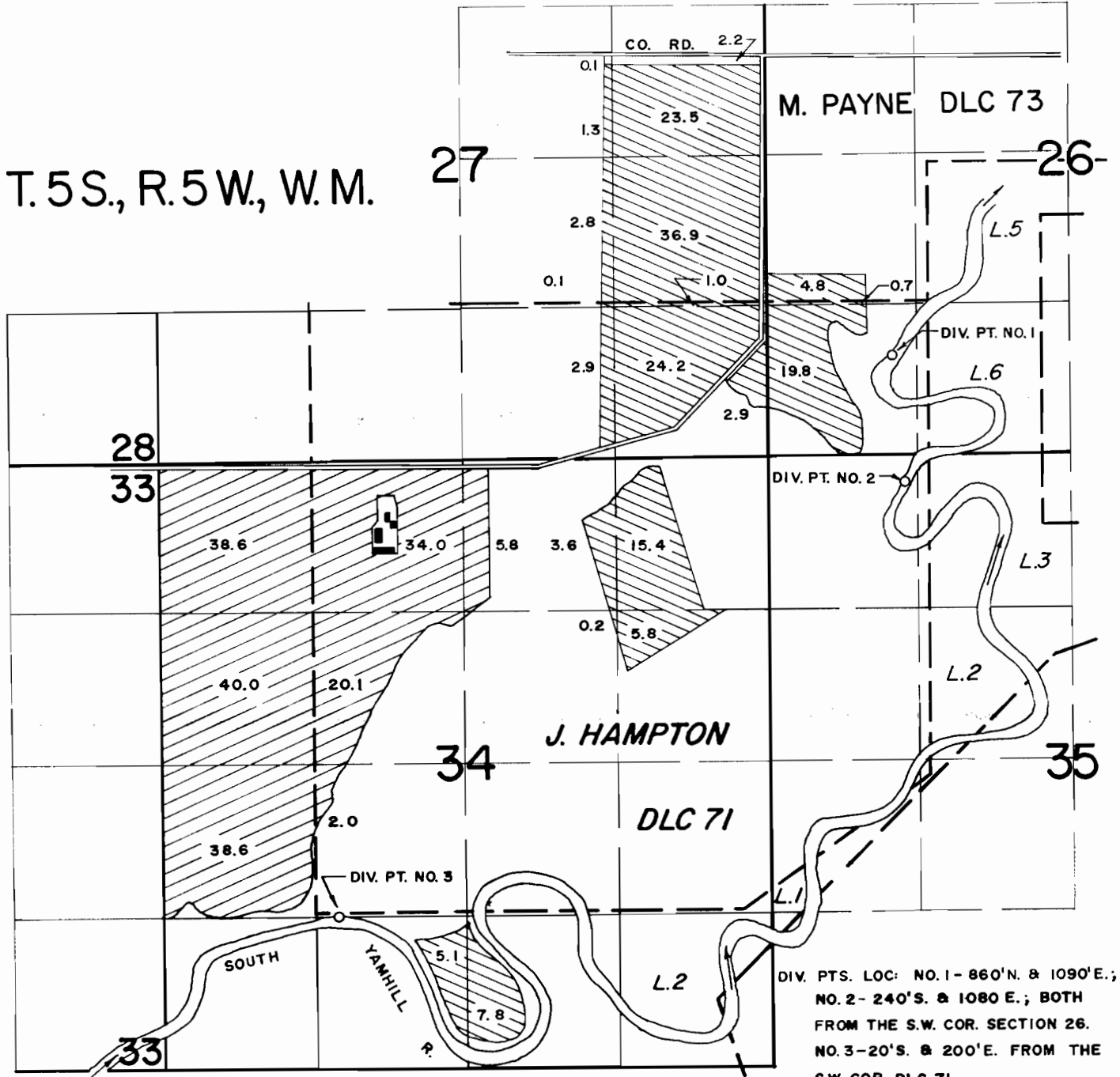

DIV. PTS. LOC: NO.1-860'N. & 1090'E.;
NO.2-240'S. & 1080 E.; BOTH
FROM THE S.W. COR. SECTION 26.
NO.3-20'S. & 200'E. FROM THE
S.W. COR. DLC 71.

PERMIT NO. 43966

PERMIT NO. 47681

FINAL PROOF SURVEY
UNDER

58374 43966
APPLICATION NO. 65280 PERMIT NO. 47681

CRIMSON WEST FARMS, INC.

SURVEYED OCTOBER 2, 1984 BY *P. Pagter*



SCALE: 4" = 1 MILE