

T.5S., R.2W., W.M.

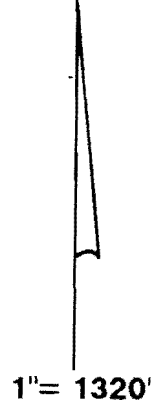

Area Irrigated

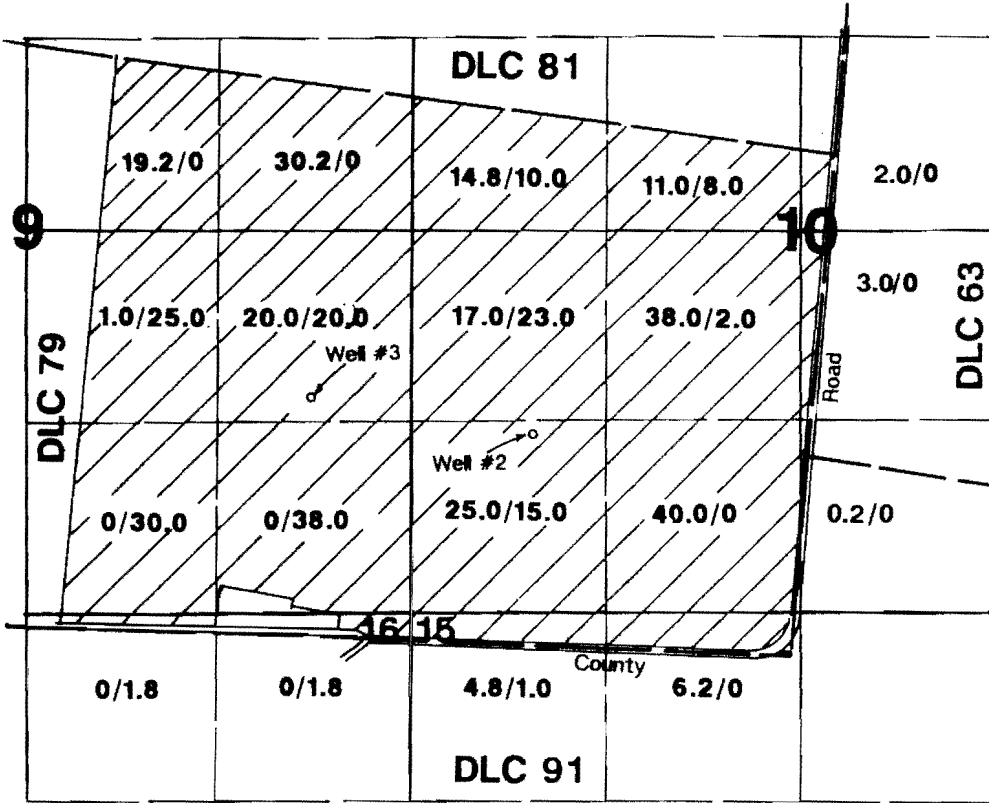

Primary/Supplemental

Well #2 located 1740'N & 1760'W from SE corner DLC 79.
 Well #3 located 1820'N & 3280'W from SE corner DLC 79.

Final Proof Survey

Transfer #T-6484

In Name Of

Ron DeConinck

Surveyed on July 12, 1994 by JM Schuette

THIS MAP WAS PREPARED FOR THE PURPOSE OF IDENTIFYING THE LOCATION OF A WATER RIGHT ONLY AND IS NOT INTENDED TO PROVIDE LEGAL DIMENSIONS OR LOCATION OF PROPERTY OWNERSHIP LINES.

