

T. 2N., R. 30E., W.M.

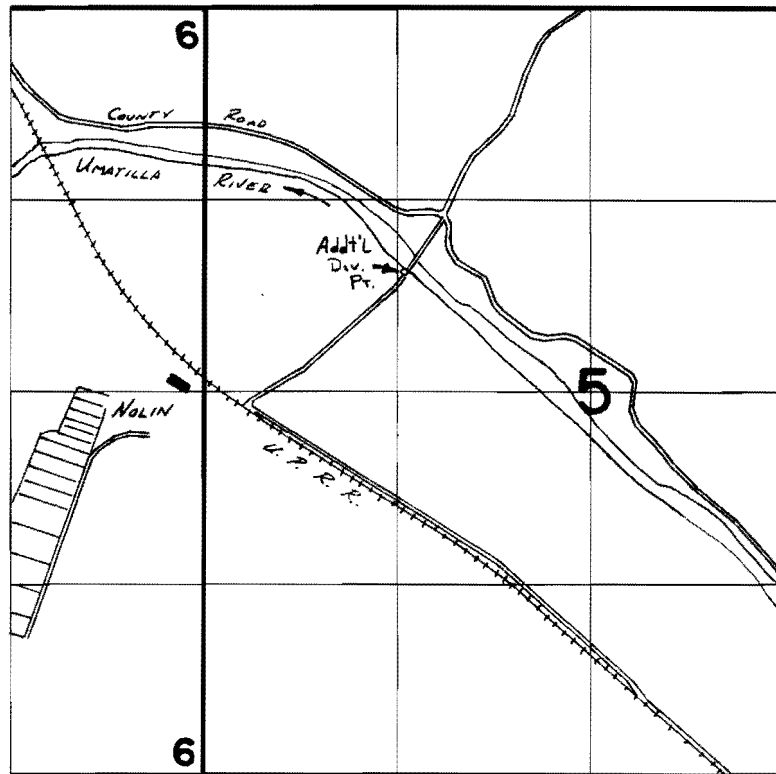

Div. Pt. Loc: 1800' S. & 1360' E NW Cor. Sec 5

**FINAL PROOF SURVEY**  
UNDER

**TRANSFER 4763**

IN NAME OF

**CUMMINGHAM SHEEP CO.**

Surveyed Dec 22, 1983, by K.L. Church