

# T.6 & 7S., R.2W., W.M

RECEIVED

APR 16 2011  
WATER RESOURCES DEPT  
SALEM OREGON

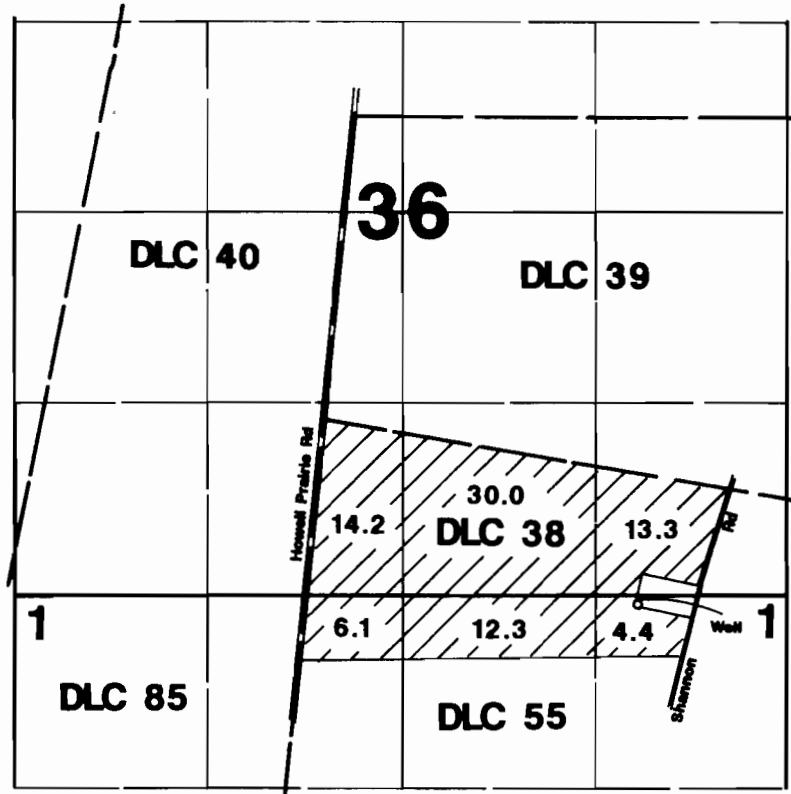

Well located 1250'S & 2150'E from NW corner DLC 38.

## Final Proof Survey

Transfer #: T-7233

In Name Of

## Sharon Cates

Surveyed on February 20, 1998 by JM Schuette

This Map Was Prepared For The Purpose Of Identifying The Location Of A Water Right Only And Is Not Intended To Provide Legal Dimensions Or Location Of Property Ownership Lines.

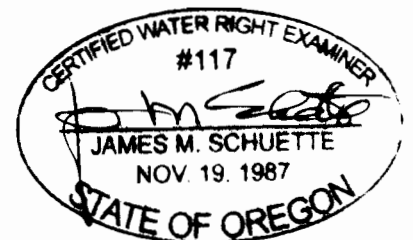

EXPIRES: 6/30/2012