

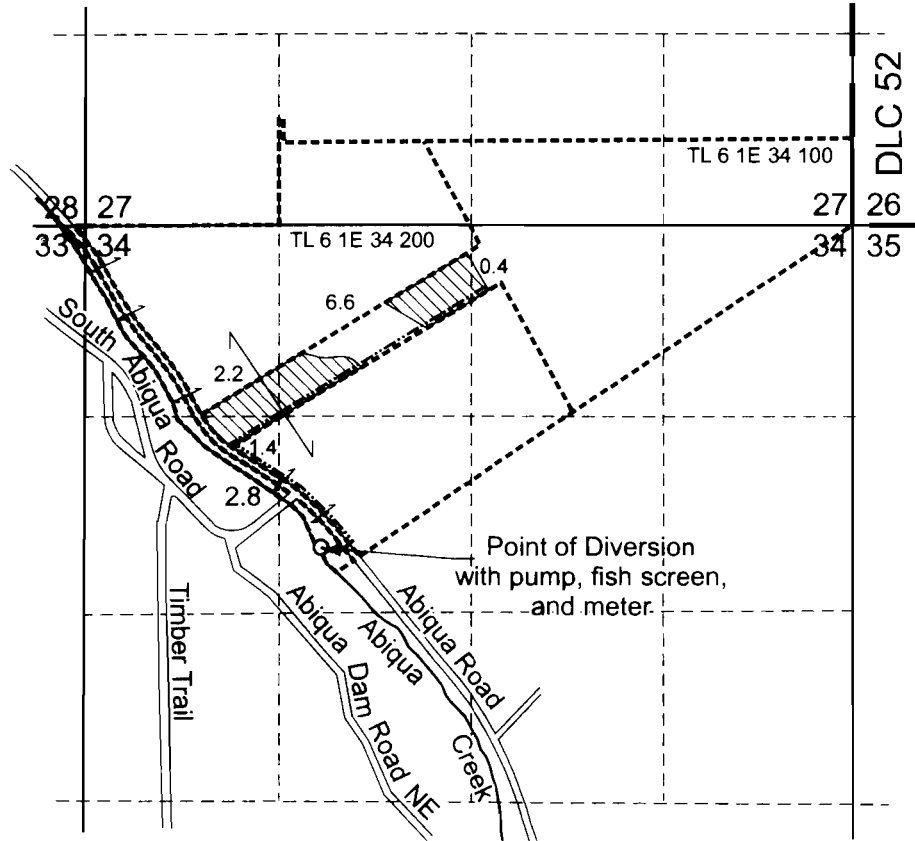



# T.6S. R.1E. Section 34, W.M.



Point of Diversion is located 2,220 feet south and 1,610 feet east from the NW corner, Section 34.

-  Area (10.6 Acres) to be irrigated under T-10831
-  Tax lot boundary
-  Donation Land Claim boundary
-  Irrigation mainline

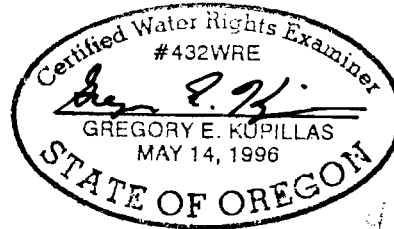

EXPIRATION DATE: 6/30/2013

Scale: 1" = 1,320'



This map was prepared for the purpose of identifying the location of a water right only and is not intended to provide legal dimensions or location of property ownership lines.



Pacific Hydro-Geology Inc.

Claim of Beneficial Use Map  
Transfer T-10831

Paul Kraemer  
T.6S. R.1E. Section 34, W.M.

11/2011