

FINAL PROOF MAP T-8969
 NE1/4SW1/4, SECTION 11, T.39S., R.3W., W.M.
 JACKSON COUNTY, OREGON
 FOR
 ANTHONY B. MIKSCH
 P.O. BOX 1541
 LITTLE APPLGATE ROAD
 JACKSONVILLE, OREGON 97530

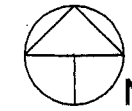

Scale: 1"=400'
 Date: August 7, 2006

LEGEND

- Found Survey Monument
- Denotes Building
- BP Denotes Booster Pump
- (M) Denotes Flow Meter
- == Denotes Driveway
- - - Denotes Mainline Pipe
- ▨ Denotes Area Under Special Order Volume 61 Pages 412-414, Priority Date: 1885

Point of Diversion No. 1 - Situated 480' West and 230' North of South One-Quarter Corner, Section 3. Fish Screen at Point of Diversion.

This map was prepared for the purpose of identifying the location of a water right only and is not intended to provide legal dimensions or location of property ownership.

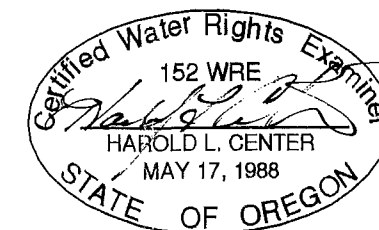

HAROLD L. CENTER
 2604 David Lane
 Medford, OR. 97504
 Phone 541-535-6108
 Oregon Certificate No. 152
 Certificate Renewal Date: 12/31/2007

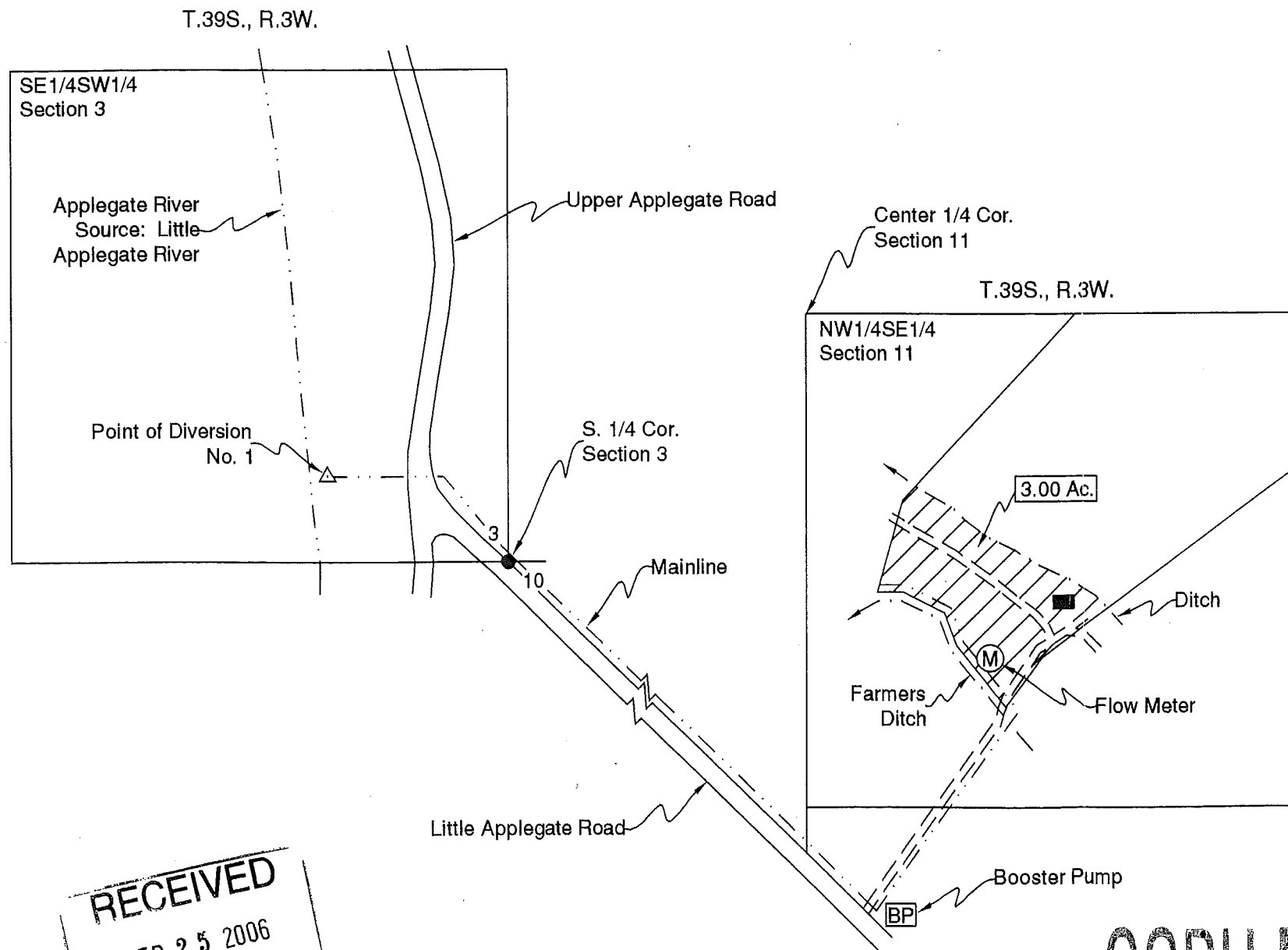

RECEIVED
 SEP 25 2006
 WATER RESOURCES DEPT
 SALEM, OREGON

COBU MAP #
0220

T 39 S, R 3 W, W.M.

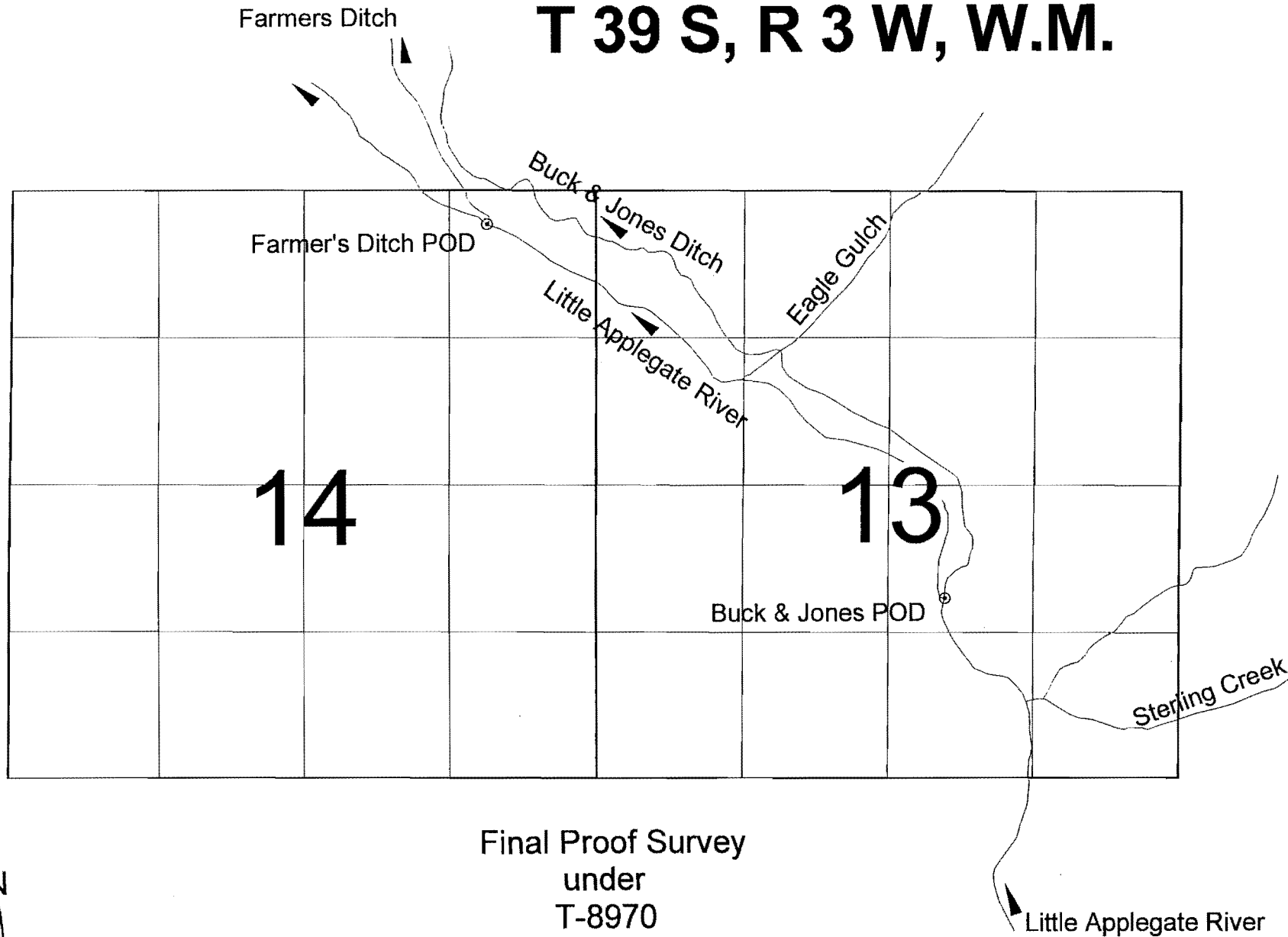

Farmer's Ditch POD - GPS coordinates: Latitude 42.18400, Longitude -123.0174
Buck & Jones Ditch POD - GPS coordinates: Latitude 42.17508, Longitude -123.0018

