

9417
8758

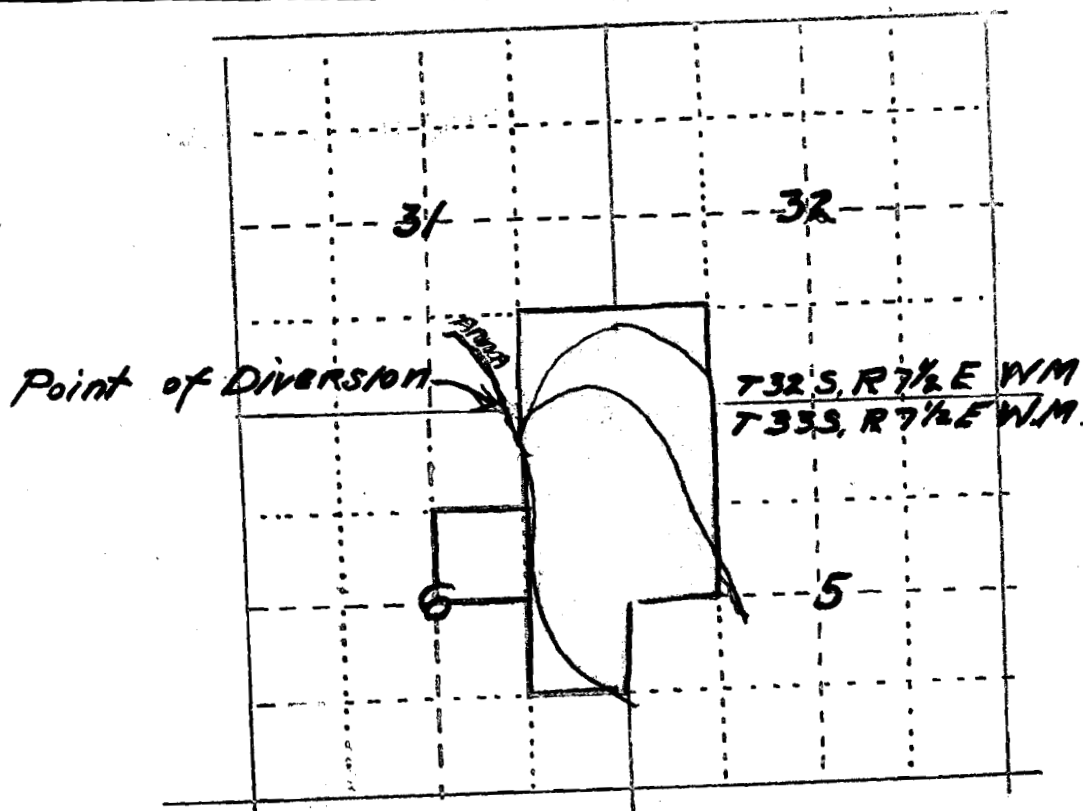

Plat accompanying application to appropriate
waters of Anna Creek, Klamath County by R.L.
Darling. March. 1927.

Scale - 2" = 1 mi.

Drawn by John C. Cleghorn, Reg. Prof. Engr., Klamath
Falls, from information furnished by R.L. Darling.

Application No. 12575

Permit No. 9417

Mar 3, 1927

John C. Cleghorn

Anna Ck. : mac