

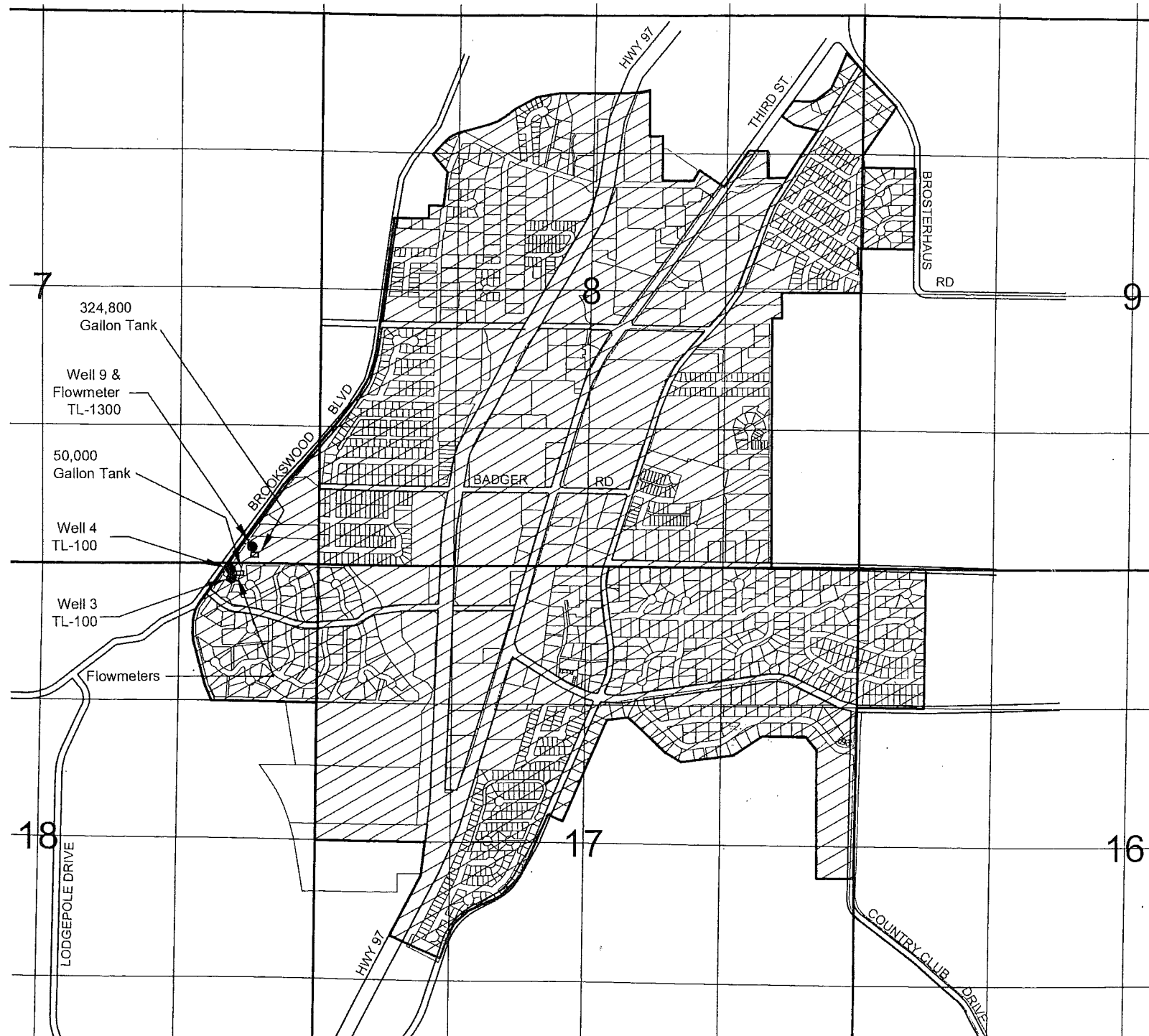

T18S, R12E, W.M.
 Application G-13072, Permit G-12526, Permit Amendment T-9954
 Deschutes County, OR
 Claim of Beneficial Use Map



Explanation:

 - Place of Use

 - Point of Appropriation (POA)

Well 3 located 140 feet south and 820 feet west from the NW corner of Section 17.
 Well 4 located 55 feet south and 835 feet west from the NW corner of Section 17.
 Well 9 located 160 feet north and 630 west from the NW corner of Section 17.
 New Well 10 located 2445 feet south and 1200 feet east from the NW corner of Section 30.

Site inspection conducted July 19 & 20, 2011.

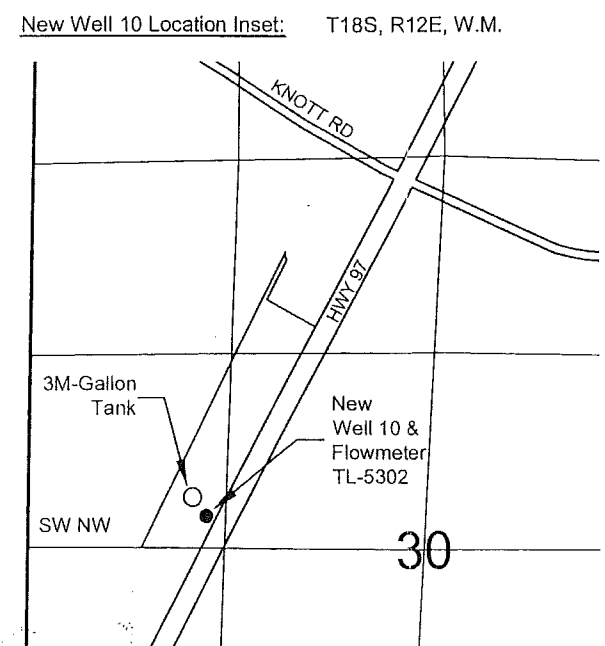

RECEIVED
 FEB 12 2012
 WATER RESOURCES DEPT
 SALEM, OREGON

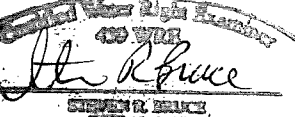
 STEVEN R. BALACE
 STATE OF OREGON
 Exp. 12/31/2013

December 9, 2011

THIS MAP IS NOT INTENDED TO
 PROVIDE LEGAL DIMENSIONS OR
 LOCATIONS OF PROPERTY
 OWNERSHIP LINES.

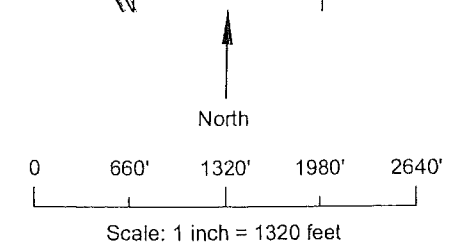

COBU MAP # 0664

SKOGKUM
 WATER ASSOCIATES INC
 P.O. Box 80174
 Portland, OR 97280
 (503) 319-8926

Figure 1