

44227
BOYLSTON, LG, BS, LOW SEC 15

Journal S. Mac

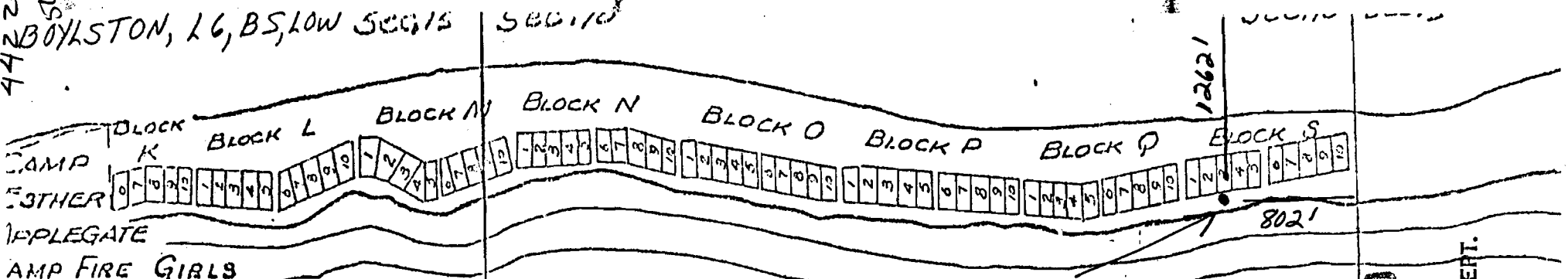

PLEGATE
AMP FIRE GIRLS
AMERICA

POINT OF DIVERSION, 802' S + 1262' E of
THE NW CORNER OF SEC 10, T37S, R5E.
POINT OF USE. LOT 6, BLK S, LAKE OF THE
WOODS SUMMER HOMES SURVEY

RECEIVED

MAY 02 1979
WATER RESOURCES DEPT.
SALEM, OREGON

LAKE OF THE WOODS

Application No. 58606
Permit No. 44227

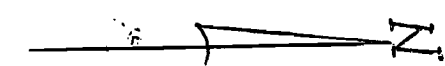

LAKE OF THE WOODS
RESORT

WHITE PINE
PICNIC AREA

RAINBOW
BAY

SUNSET
CAMPGROUND

INDIAN

ROAD

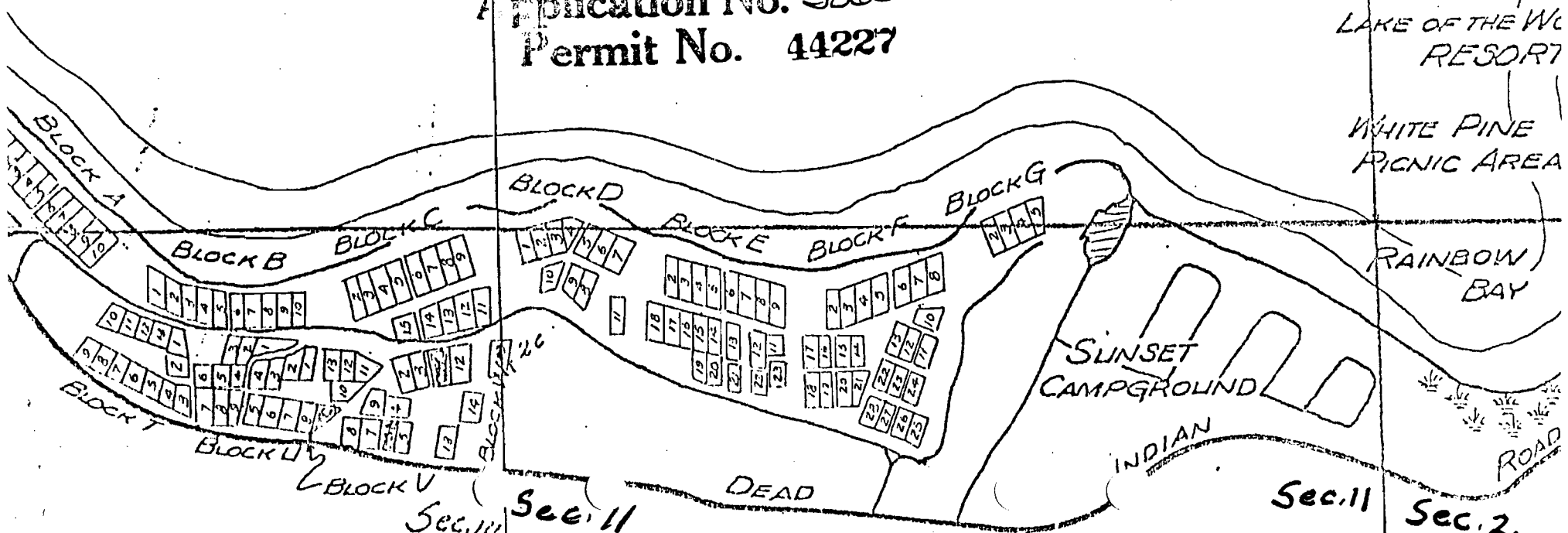

Sec. 11
Sec. 11

Sec. 11

Sec. 2