

T. 8 S. R. 1 W., W.M.

27

PHILIP GLOVER D.L.C. NO. 65

CASCADE HWY.

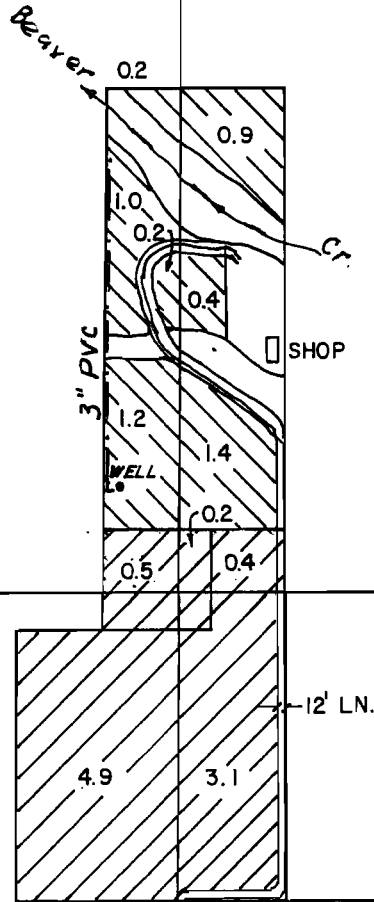

1" = 400'

BRASS CAP, S.E. CORNER
PHILIP GLOVER D.L.C. NO. 65

WELL LOC. 1330' N. & 1200' E. FROM S.E. COR. PHILIP GLOVER D.L.C. NO. 65

27	26
34	35



IRRIG. FROM THIS WELL



IRRIG. FROM SCHUMACHER WELL

FINAL PROOF SURVEY

FOR

GUY M. BARTH

SURVEYED ON JUNE 27, 1994

THIS MAP WAS PREPARED FOR THE PURPOSE OF IDENTIFYING THE LOCATION OF A WATER RIGHT ONLY AND IS NOT INTENDED TO PROVIDE LEGAL DIMENSIONS OR LOCATION OF PROPERTY OWNERSHIP LINES.

